



Walcott Chalet Park, 26 Walcott Chalet Park Coast Road

£65,000 Leasehold

Minors and Brady is excited to present this charming two-bedroom chalet that presents a great opportunity for those seeking a holiday home or a holiday let investment. Boasting a prime location within walking distance from the beach, this property offers breathtaking sea views. With its quant exterior and modern interior this chalet is sure to captivate any visitor.

Location

Walcott Chalet Park located on Coast Road is a charming holiday destination situated on the picturesque coast of Norfolk, England. The park offers a serene environment, ideal for relaxation and leisure, with easy access to the sandy beaches of Walcott. It is well-maintained and features a variety of chalets, catering to different accommodation needs. The surrounding area boasts stunning sea views and a peaceful atmosphere, making it a perfect getaway for families, couples, and solo travellers. Transport links to and from Walcott Chalet Park are convenient and accessible. The park is served by local bus routes, with regular services connecting Walcott to nearby towns and villages. For those travelling by car, the park is easily accessible via the main coast road, which offers a scenic drive along the Norfolk coastline.



Agents Note

We understand the property is being sold as a Leasehold. The current utility companies are EON and Anglian Water.

Tax Council Band - A



Walcott Chalet Park, Coast Road

Upon entering, you are greeted by an inviting open-plan kitchen and living area, ideal for both relaxing and entertaining. The well-equipped kitchen features fitted units, providing ample storage and countertop space for meal preparation. The generously sized lounge offers a comfortable space, featuring a large window ensuring picturesque views.

The chalet comprises one spacious bathroom that features a convenient step-in shower, ensuring both functionality and style. The chalet further boasts two well-sized bedrooms ensuring versatile living spaces for residents and guests. The main bedroom is thoughtfully designed with a built-in cupboard, offering practical storage solutions. Throughout the property, laminated flooring adds a touch of elegance while being easy to maintain. Large windows flood the interior with natural light, creating a bright and airy ambience within.

Outside, residents can enjoy a shared lawn space, perfect for enjoying the fresh sea breeze. With the added convenience of two car parks, parking will always be a breeze for accommodating guests or family members.

This property presents an enticing opportunity to own a holiday retreat in a highly desirable location. Whether you're seeking a personal space by the sea or a profitable investment venture, this chalet ticks all the boxes. Don't miss your chance to own a piece of paradise in this sought-after area. Schedule a viewing today to experience the charm and comfort this coastal chalet has to offer.



GROUND FLOOR

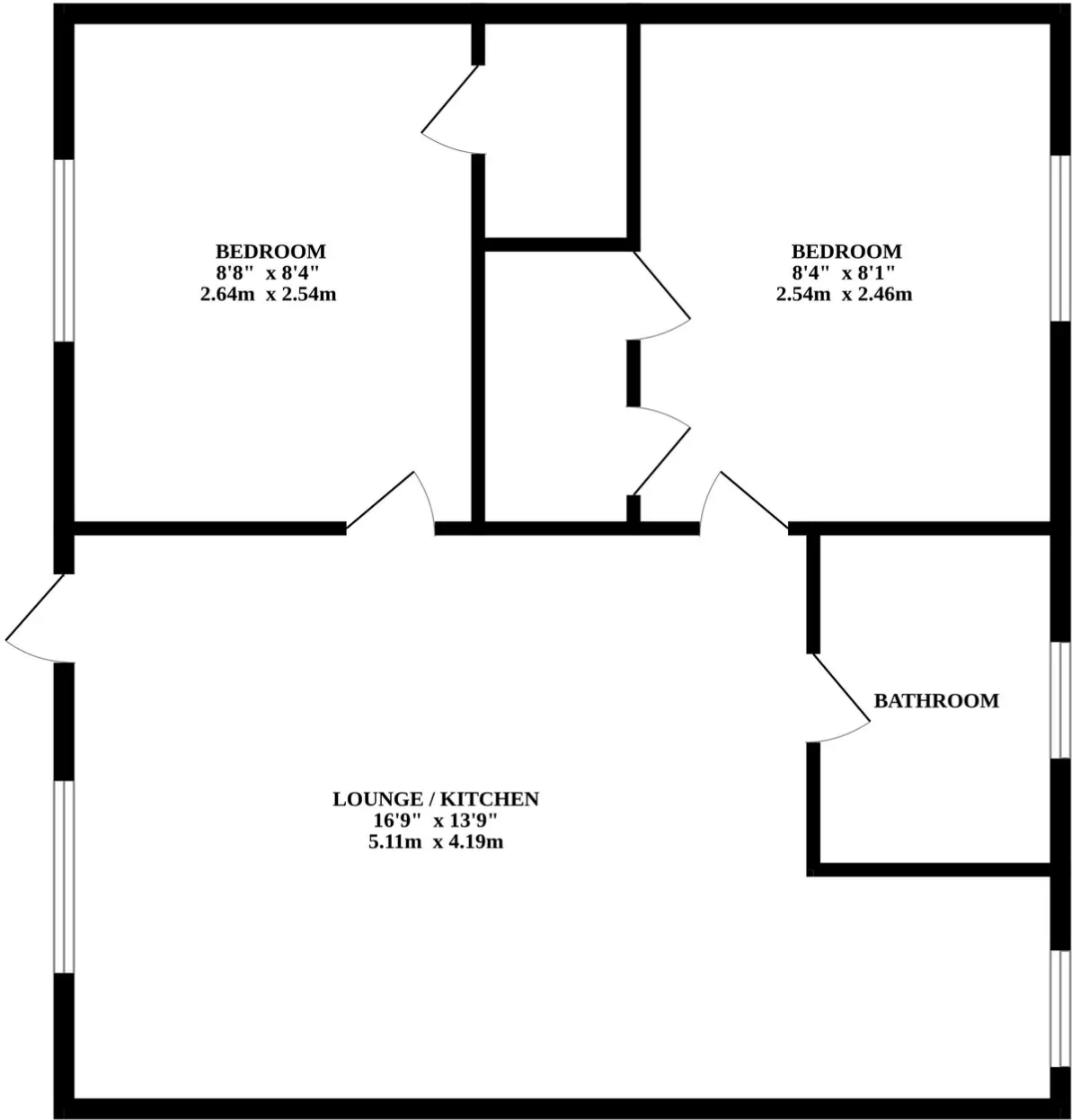

Whilst every attempt has been made to ensure the accuracy of the floorplan contained here, measurements of doors, windows, rooms and any other items are approximate and no responsibility is taken for any error, omission or mis-statement. This plan is for illustrative purposes only and should be used as such by any prospective purchaser. The services, systems and appliances shown have not been tested and no guarantee as to their operability or efficiency can be given.
Made with Metropix ©2024