



ESTATE AGENT



Rangefield Road

, BR1 4QZ

£450,000



Rangefield Road, , BR1 4QZ



Description

An extended, three-bedroom end of terrace family home with driveway and south facing rear garden. The property comprises; entrance hall leading to the extended 25'9 x 16'8 living / dining room and a separate kitchen. There is a modern family bathroom that completes the downstairs accommodation. Upstairs boasts three good size bedrooms. Externally there is a sunny south facing rear garden, mainly laid to lawn with useful side access that backs on to Shaftsbury Park Recreation Ground. Further benefits include, UPVC double glazing throughout. A new gas central heating system and new roof.

This property on Rangefield Road is conveniently located, just a stone's throw from the 'Ofsted Outstanding' Burnt Ash Primary School as well as only being half a mile from the highly regarded Bonus Pastor Catholic College. There are great transport links to London Bridge, taking just 18 minutes from Grove Park Train Station (Zone 4) just 0.8 miles away. Close by is Bromley Town Centre which offers a larger range of shops and amenities including The Glades, cinema, picture house and a range of restaurants and pubs. EPC Rating C.

- Three Bedrooms
- 25'9 x 16'8 Reception
- South Facing Rear Garden
- New Roof
- Choice of 'Outstanding' Schools
- End of Terrace
- 891 Sq.Ft
- Modern Bathroom
- Driveway
- 0.6 Miles from Sundridge Station





Floor Plan

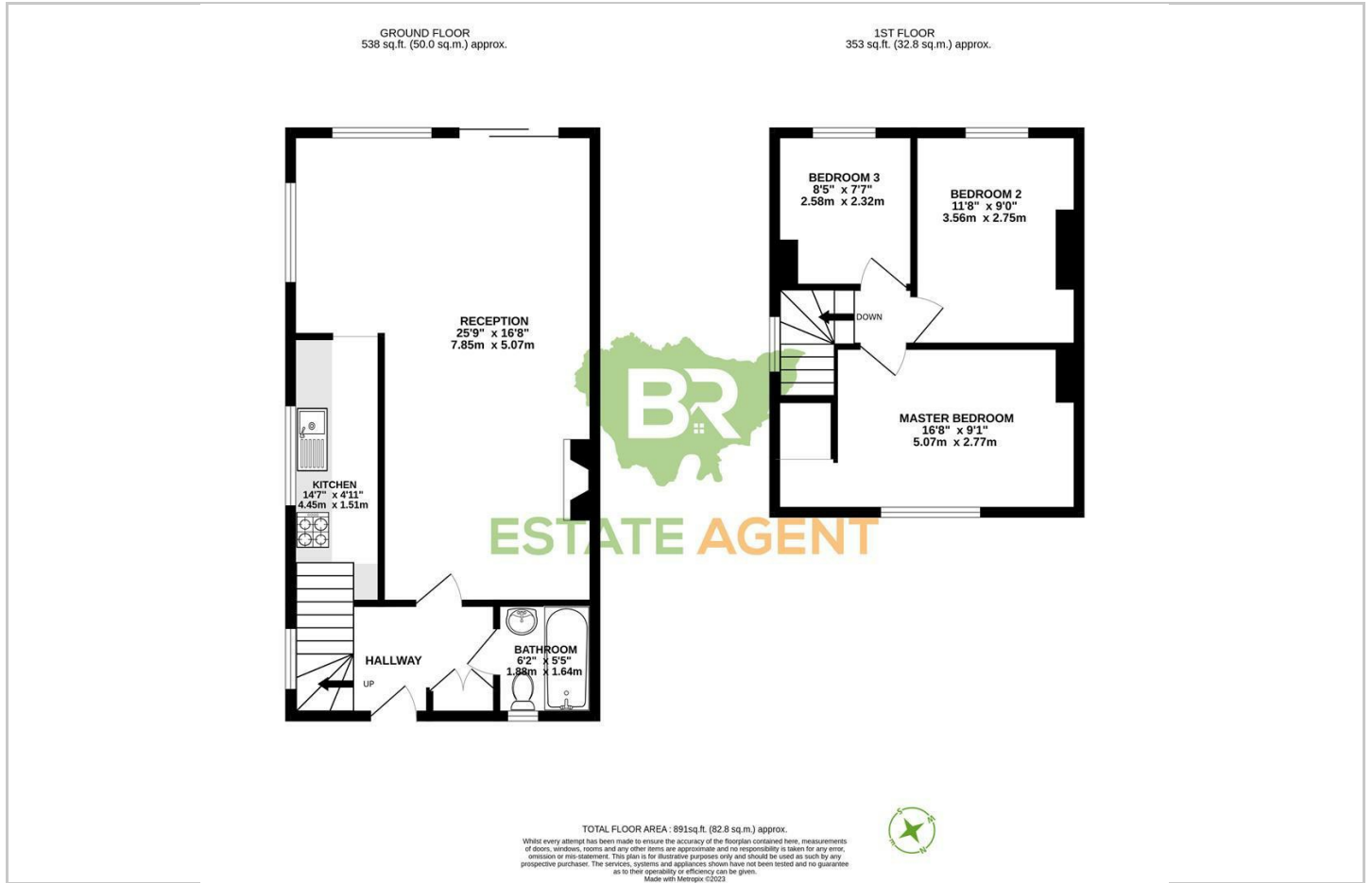

Area Map

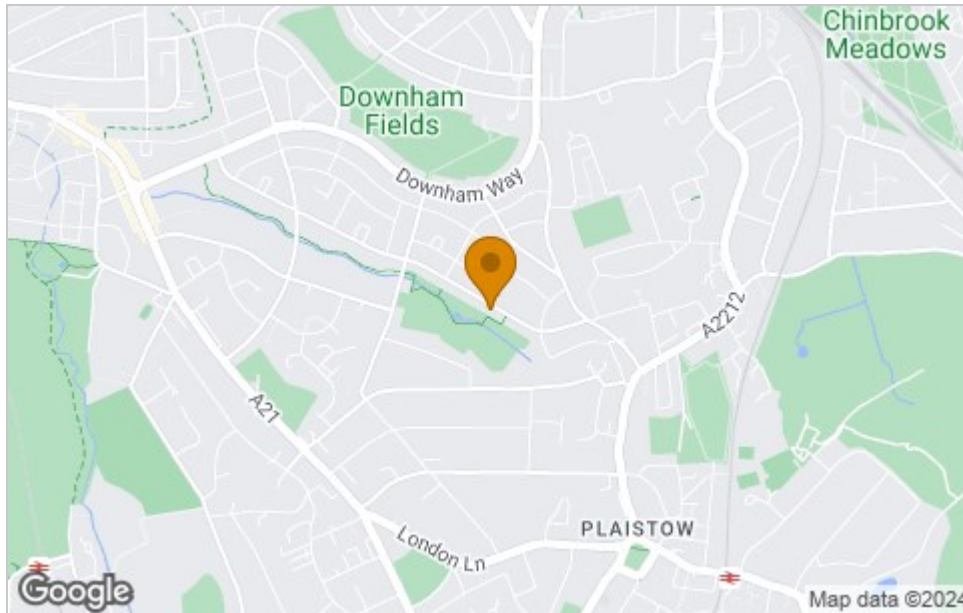

Energy Efficiency Graph

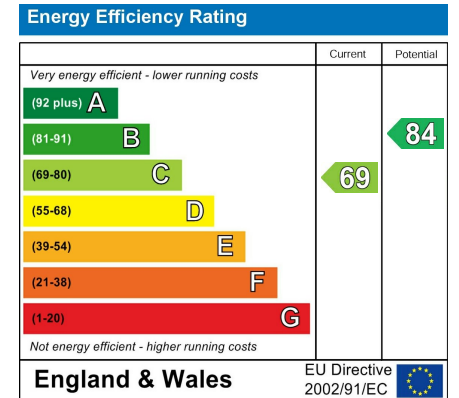

Viewing

Please contact our Bromley Office on 020 3633 8620 if you wish to arrange a viewing appointment for this property or require further information.

These particulars, whilst believed to be accurate are set out as a general outline only for guidance and do not constitute any part of an offer or contract. Intending purchasers should not rely on them as statements of representation of fact, but must satisfy themselves by inspection or otherwise as to their accuracy. No person in this firm's employment has the authority to make or give any representation or warranty in respect of the property.