



18 Old Oak Common Lane  
Acton  
London  
W3 7EL  
T: 020 8749 9798  
E: sales@churchillmathesons.com  
www.churchillmathesons.com

**Churchill&Mathesons**

Cumberland Park, London, W3 6SY

£460 Per Week



**KEY FEATURES:**

- 2 Spacious and bright double bedrooms
- Stylish and new fully fitted kitchen
- Off street parking
- UNFURNISHED ~ AVAILABLE 9 JAN 2024

Fantastic opportunity to rent this just refurbished 2 double bedroom second floor flat  
2 Spacious and bright double bedrooms  
Stylish and new fully fitted kitchen with integrated washing machine, dryer and dishwasher  
Spacious open plan reception room  
Modern bathroom  
Off street parking for one car and communal garden  
Offered in excellent condition, with wooden flooring throughout, new double glazing, new central heating  
Located on a quiet leafy street. Moments from all amenities of Acton  
Excellent transport links  
UNFURNISHED ~ AVAILABLE 9 JAN 2024



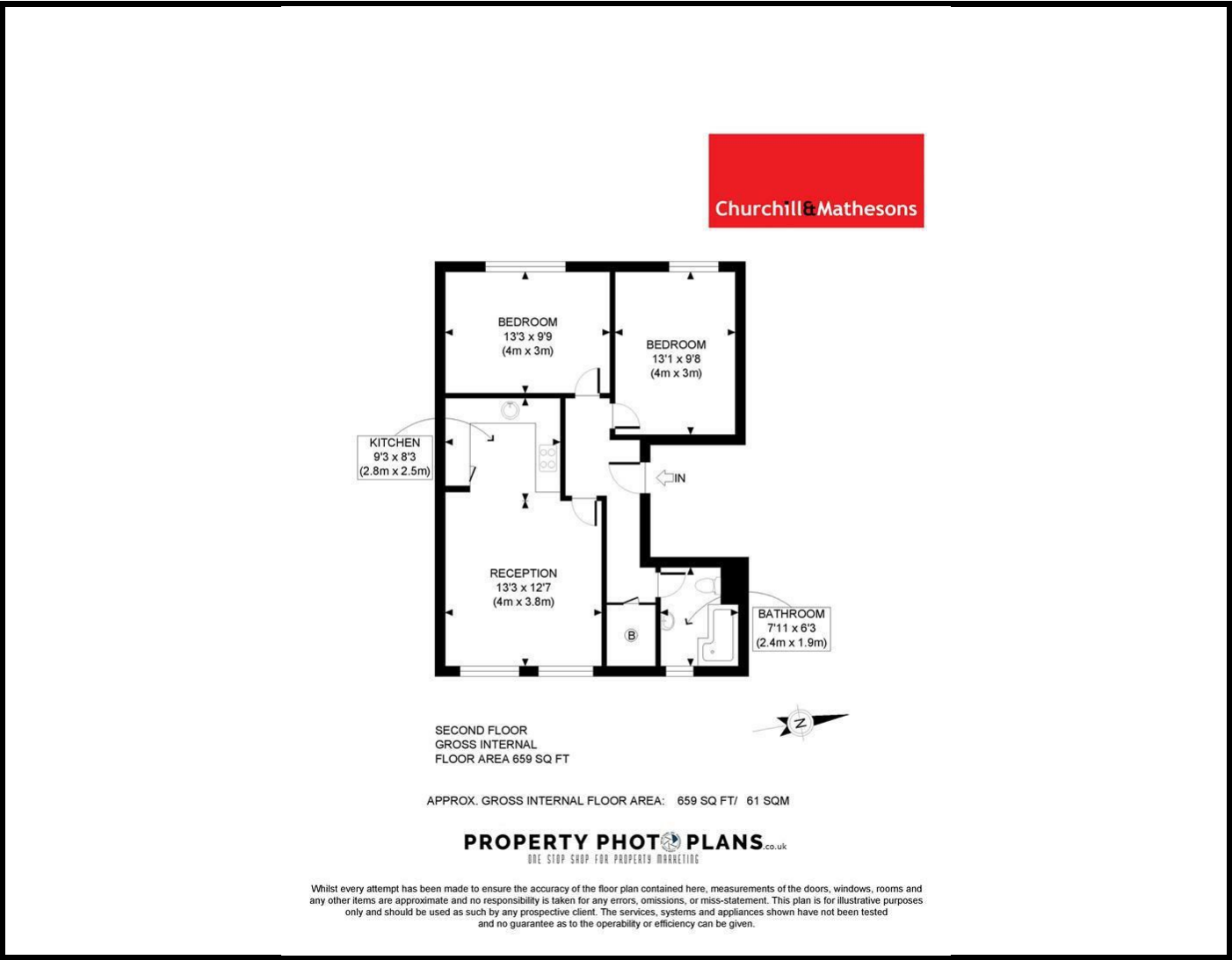

Energy Efficiency Rating

	Current	Potential
Very energy efficient - lower running costs		
(92 plus) A		
(81-91) B		
(69-80) C		
(55-68) D		
(39-54) E		
(21-38) F		
(1-20) G		
Not energy efficient - higher running costs		
England & Wales	EU Directive 2002/91/EC	

Environmental Impact (CO<sub>2</sub>) Rating

	Current	Potential
Very environmentally friendly - lower CO <sub>2</sub> emissions		
(92 plus) A		
(81-91) B		
(69-80) C		
(55-68) D		
(39-54) E		
(21-38) F		
(1-20) G		
Not environmentally friendly - higher CO <sub>2</sub> emissions		
England & Wales	EU Directive 2002/91/EC	

Whilst every effort is made to give a fair description, the accuracy of these particulars is not guaranteed, neither do they constitute an offer or contract.

**CHURCHILL & MATHESONS ESTATE AGENTS** have not tested any apparatus, equipment, fitting or services and so cannot verify that they are in working order. The buyer is advised to obtain verification from their solicitor or surveyor. Measurements are correct to within +/- 6 A sonic tape is used. None of the statements contained in these particulars or any of our properties are to be relied upon as a representation of fact.