



Constable Court, London, W4 4BD

£350,000

**WHITMAN & CO.**

SALES · LETTINGS · COMMERCIAL



- Private gated development
- Tree lined area with communal gardens
- Designated parking
- Great transport links
- Fitted wardrobes & storage
- No chain

Tenure - Leasehold with a Share of Freehold  
 Ground Rent - Peppercorn  
 Service Charge - £885.82 pa  
 Local authority - Hounslow  
 Council tax - Band C

## THE PROPERTY

A nicely presented, purpose-built second floor one bedroom apartment, situated within this highly sought after, well managed residential development, in a popular residential area within walking distance of Chiswick High Road with its extensive array of boutique restaurants, shops, and leisure facilities. Convenient for supermarkets; M&S, Waitrose, Sainsbury's, Tesco and Co-op. The accommodation comprises of a reception room, fitted kitchen, double bedroom with fitted wardrobes and storage, spacious toilet and a bath with shower, dual aspect overlooking communal gardens, allocated parking bay and coded security gates. Transport links; Gunnersbury, Kew Bridge and Chiswick Park stations (District/Overground), Turnham Green station (Piccadilly), numerous local bus routes and Chiswick cycle superhighway. Road access to Central London via A4/M4 and walking distance to Brentford Football Club.

### Chaseley Drive, W4

Approximate gross internal area

29.73 sq m / 320 sq ft

Key :  
 CH - Ceiling Height

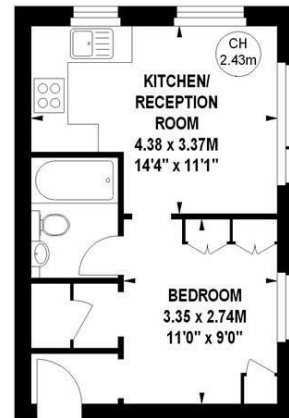

### Second Floor

The floor plan is not to scale and measurements and areas shown are approximate and therefore should be used for illustrative purposes only. The plan has been prepared in accordance with the RICS code of Measuring Practice and whilst we have confidence in the information produced, it must not be relied on. If there is any aspect of particular importance, you should carry out or commission your own inspection of the property.  
 Copyright of FeaturePRO.

## SITUATION

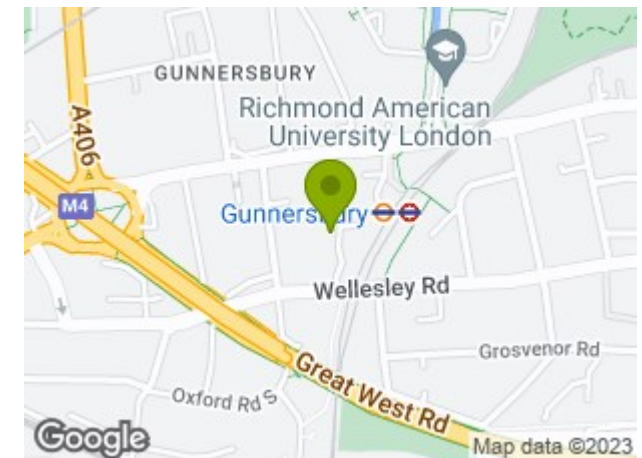

5-7 Turnham Green Terrace, Chiswick, London, W4 1RG

Tel 020 8747 8800

E-mail [sales@whitmanandco.com](mailto:sales@whitmanandco.com)

Website [www.whitmanandco.com](http://www.whitmanandco.com)