

GROUND FLOOR
APPROX. FLOOR
AREA 330 SQ.FT.
(30.6 SQ.M.)

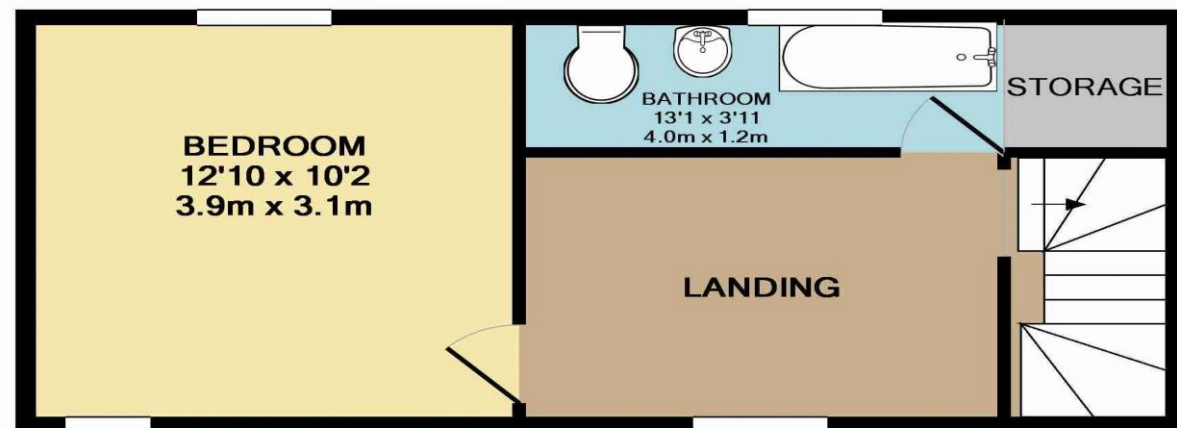

1ST FLOOR
APPROX. FLOOR
AREA 352 SQ.FT.
(32.7 SQ.M.)

TOTAL APPROX. FLOOR AREA 681 SQ.FT. (63.3 SQ.M.)

Whilst every attempt has been made to ensure the accuracy of the floor plan contained here, measurements of doors, windows, rooms and any other items are approximate and no responsibility is taken for any error, omission, or mis-statement. This plan is for illustrative purposes only and should be used as such by any prospective purchaser. The services, systems and appliances shown have not been tested and no guarantee as to their operability or efficiency can be given
Made with Metropix ©2016

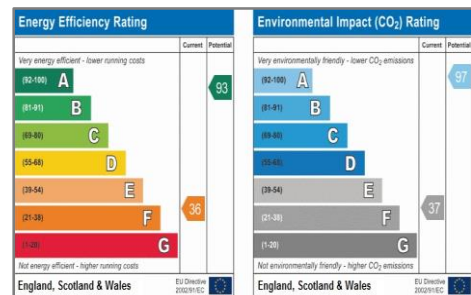

Council tax band = A

Misrepresentation Act 1967

These particulars are believed to be correct but their accuracy is not guaranteed nor do they form part of any contract.

Registered office: Cedar House, 41 Thorpe Road, Norwich, NR1 1ES
Incorporated in England and Wales, Company Registration Number: 6606900

T: 01328 862222
E: info@purenorthnorfolk.co.uk
2 Oak Street, Fakenham, NR21 9DY



www.purenorthnorfolk.co.uk

Residential Sales ● Lettings ● Property Management



The Green, Hempton, Fakenham, NR21 7LG

£129,950

Freehold

This attractive, period brick and flint, end-terrace cottage is situated in an excellent position, looking over the Green and Common land. The property has original features including; impressive fireplace, exposed floorboards, latch doors and small courtyard garden. The property briefly comprises: Kitchen / breakfast room, lounge, large bedroom, bathroom and a first floor landing area that has previously been used as a bedroom. The property also benefits from having UPVC double glazing and gas-fired radiator central heating. This property is offered to the market CHAIN FREE.

- End of Terrace Cottage
- 1 Bedroom
- Gas Central Heating
- UPVC Double Glazing
- Courtyard Garden
- Village Location
- Period Features
- Chain Free
-



Kitchen 10' 2" x 12' 10" (3.1m x 3.9m)

Door to rear courtyard, vinyl flooring, wall and base units, stainless steel sink, space for washing machine, oven and fridge / freezer, UPVC window to front aspect, door to lounge.

Lounge 10' 2" x 13' 1" (3.1m x 4m)

Laminate flooring, UPVC window to front aspect, character fireplace with wood burning stove, door to stairwell, door to kitchen, exposed beams.

Landing 11' 6" x 8' 6" (3.5m x 2.6m)

Large landing area which has previously been used as a bedroom, UPVC window to front aspect, carpet flooring, doors to bathroom and bedroom, stairs to ground floor.

Bedroom 13' 1" x 11' 10" (4m x 3.6m)

UPVC windows to front and rear aspect, carpet flooring, door to landing

Bathroom 13' 1" x 3' 11" (4m x 1.2m)

Vinyl flooring, UPVC window to rear aspect, bath with shower over, WC, basin, storage cupboard, door to landing.

Outside

To the rear of the property is an enclosed courtyard with access to the house.

Services

The property is serviced by mains water, electricity and gas.