



Four bedroom family home in a private estate

exclusive to

SAUNDERS

richardsaunders.co.uk

Dorking RH5

Dorking Town 2.0 miles
Dorking & Dorking Deepdene 2.5 miles
London by rail 55 minutes
M25 (Junction 8) 9.4 miles

All times and distances are approximate

This good sized four bedroom detached house is set within the desirable, rarely available private estate of Bentsbrook Park. The property consists of two reception rooms a modern kitchen with fully fitted appliances. Upstairs you have four well proportioned bedrooms with a brand newly installed bathroom and separate toilet. Additional benefits include a large rear enclosed garden, driveway for multiple cars and a garage.



- Available Now
- Four Bedrooms
- Unfurnished
- Rent Includes Gardener
- Short Walk To Dorking Town
- Newly Refurbished Throughout

Price £3,350pcm





Approximate Area = 124.8 sq m / 1343 sq ft
 Garage = 12.6 sq m / 136 sq ft
 Total = 137.4 sq m / 1479 sq ft
 Including Limited Use Area (2.6 sq m / 28 sq ft)

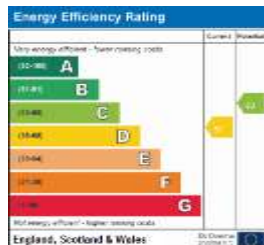
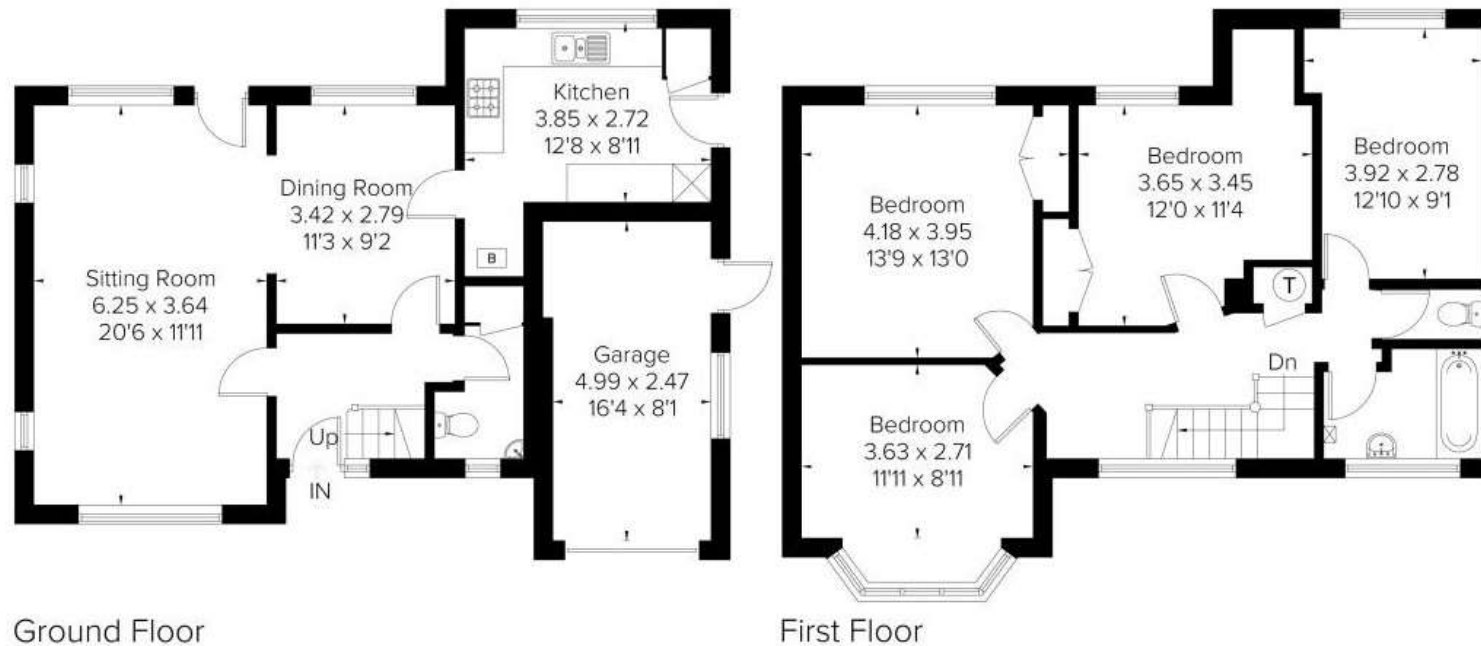

discover more at richardsaunders.co.uk



IMPORTANT NOTICE TO PURCHASERS: We endeavour to make our sales particulars accurate and reliable, however, they do not constitute or form part of an offer or any contract and none is to be relied upon as statements of representation or fact. The services, systems and appliances listed in this specification have not been tested by us and no guarantees as to their operating ability or efficiency are given. All measurements have been taken as guide to prospective buyers only, and are not precise. If you require clarification or further information on any points, please contact us, especially if you are travelling some distance to view.

Viewing
 Please call us to arrange
 a viewing appointment

1 Waterhouse Lane
 Kingswood
 01737 360000

2 High Street
 Banstead
 01737 363333

Residential Lettings
 All Areas
 01737 370700

SAUNDERS
richardsaunders.co.uk