



ESTATE AGENT



## Southlands Road

Bromley, BR2 9QT

Guide price £415,000

\*\*\* Guide Price £415,000 - £425,000 \*\*\*

Offering over a thousand square-feet in living space is this three-bedroom split-level maisonette in Chatterton Village, Bromley South.

The property benefits from its own front door on the ground floor, with internal stairs leading to the first floor accommodation. Tastefully decorated, and presented in excellent condition, the first floor comprises a spacious hallway, three-piece family bathroom, separate kitchen with dining space, and a large south-east facing reception room with bay window. Upstairs, the second floor consists of a master-bedroom with bespoke fitted wardrobes, as well as a private WC ensuite. There is also an additional double-bedroom with fitted wardrobes, as well as a third single-bedroom.

Additional benefits include an allocated off-street parking space, gas central heating, combi-boiler, smart meter, and skylights to bedrooms.

The property is within easy walking distance to Chatterton Village - offering a selection of local shops, cafes and amenities. Within walking distance is Bromley South Rail Station, offering fast and frequent services into London Blackfriars and London Victoria in as little as sixteen minutes. Bromley Town Centre also hosts a vast choice of bars, restaurants and shops, as well as the Glades Shopping Centre, also all within walking distance. As well as amenities, the property is within easy reach of an abundance of green spaces, including Whitehall Recreation Ground as well as Norman

- Three Bedrooms
- Split-level Maisonette
- Off-Street Parking
- Chatterton Village
- Tastefully Decorated
- Zero Service Charge
- Share of Freehold
- 101 Year Lease
- Bespoke Fitted Wardrobes
- Very Spacious

### Viewing

Please contact our Bromley Office on 020 3633 8620 if you wish to arrange a viewing appointment for this property or require further information.



## Floor Plan

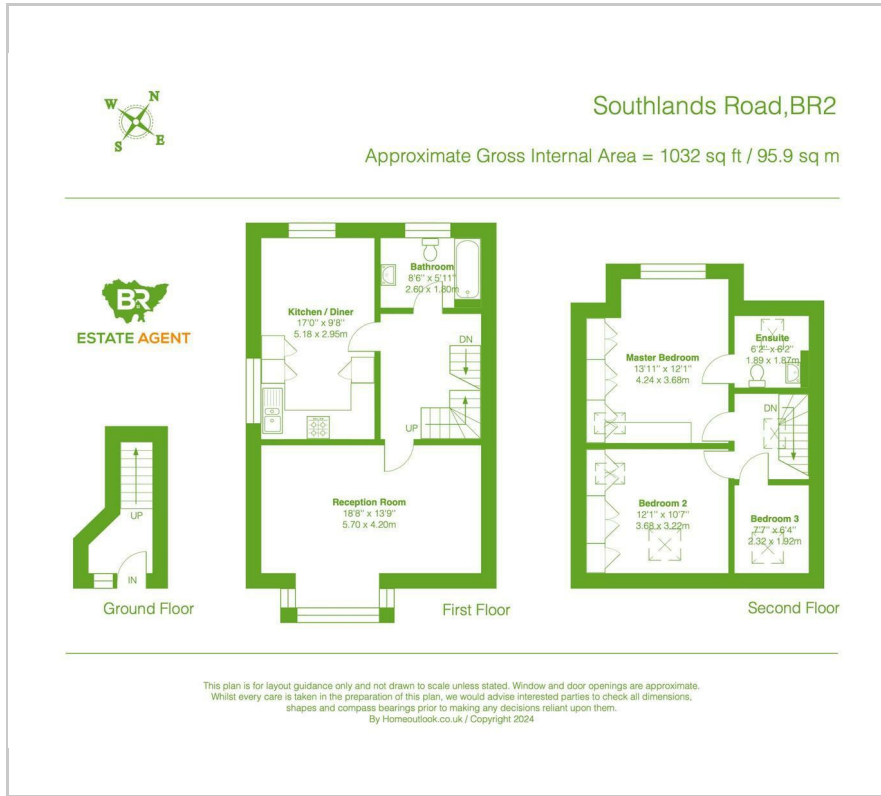

## Area Map



## Energy Efficiency Graph

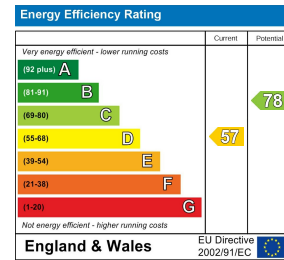

These particulars, whilst believed to be accurate are set out as a general outline only for guidance and do not constitute any part of an offer or contract. Intending purchasers should not rely on them as statements of representation of fact, but must satisfy themselves by inspection or otherwise as to their accuracy. No person in this firm's employment has the authority to make or give any representation or warranty in respect of the property.

107 Burnt Ash Lane, Bromley, BR1 5AB

Tel: 020 3633 8620 Email: [info@br-estateagent.co.uk](mailto:info@br-estateagent.co.uk) [www.br-estateagent.co.uk](http://www.br-estateagent.co.uk)