

roundtree

real estate



Sunningfields Road, Hendon NW4

£625,000



2



2



Y

Leasehold



BRITISH
PROPERTY
AWARDS

2022



GOLD WINNER

ESTATE AGENT
IN NW4



BRITISH
PROPERTY
AWARDS

2022 - 2023



GOLD WINNER

LETTING AGENT
IN NW4

A fresh approach to your property journey...

A stunning and beautifully presented two bedroom, two bathroom (one ensuite) penthouse apartment situated within this lovely modern purpose built block with lift to top floor, within walking distance of shopping facilities and local amenities of Brent Street, as well close proximity to Sunny Hill park.



- TWO DOUBLE BEDROOMS
- TWO BATHROOMS (ONE EN-SUITE)
- SPACIOUS ENTRANCE HALLWAY
- LARGE LIVING ROOM
- FULLY FITTED MODERN KITCHEN/BREAKFAST ROOM
- LIFT ACCESS TO APARTMENT
- ALLOCATED PARKING SPACE
- COMMUNAL GARDENS





The property comprises of large reception room, a fully fitted kitchen/breakfast room, two double bedrooms, two bathrooms (one Ensuite) an allocated parking space and well maintained communal gardens. Sole Agent

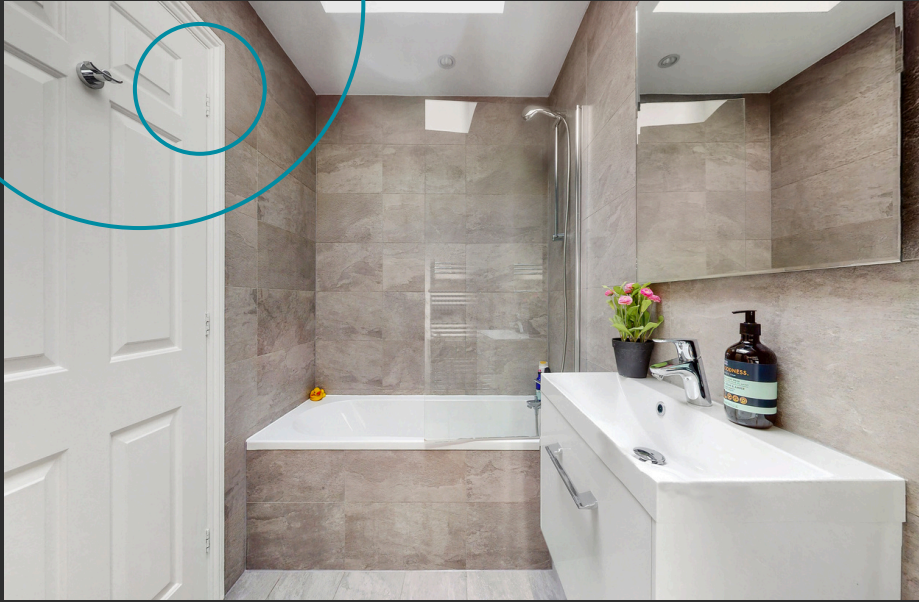

FLOOR PLAN

Summer Court Sunningfields Road NW4 4RH

Approx. Gross Internal Area = 105.9 sq m / 1139 sq ft

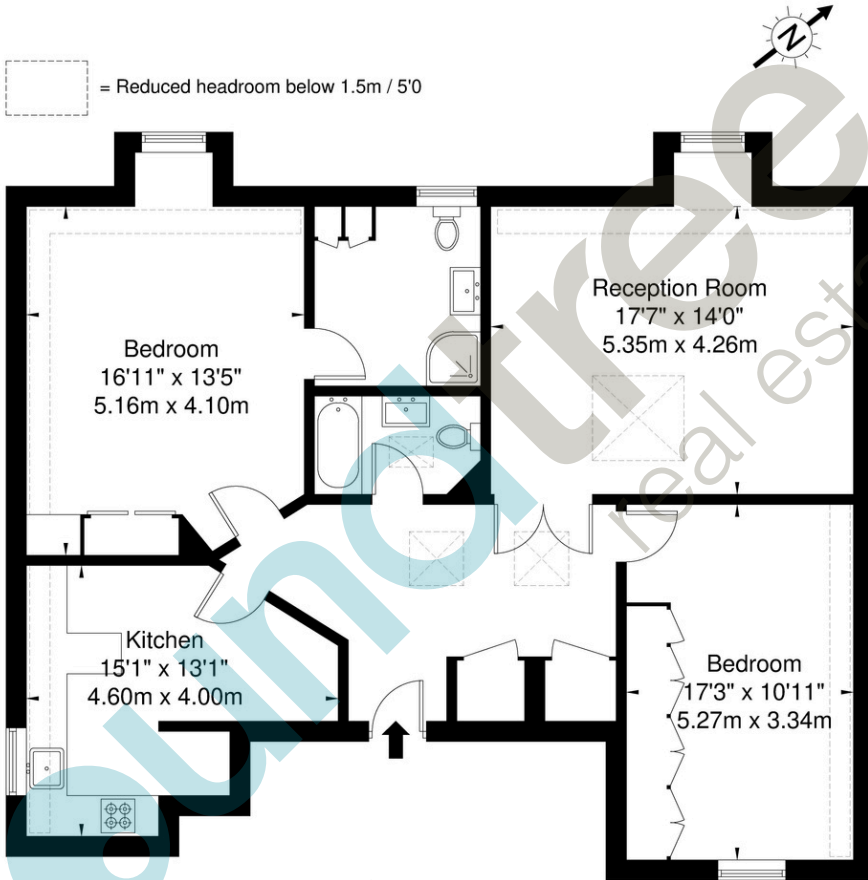

Second Floor

Ref

Copyright

**BLEU
PLAN**

The Floor plan is not to scale and measurements and areas shown are approximate and therefore should be used for illustrative purposes only. The plan has been prepared in accordance with the RICS code of Measuring Practice and whilst we have confidence in the information produced it must not be relied on. If there is any aspect of particular importance, you should carry out or commission your own inspection of the property.

Copyright © BLEUPLAN

1 Sentinel Square, Brent Street
Hendon, NW4 2EL

020 8203 21111

mail@theroundtree.com

theroundtree.com

Selling your home?

If you are considering selling your home please contact us today for your no obligation free market appraisal.

Our dedicated and friendly team will assist you.

Get in touch today!



General: While we endeavor to make our sales particulars fair, accurate and reliable, they are only a general guide to the property and, accordingly, if there is any point which is of particular importance to you, please contact the office and we will be pleased to check the position for you, especially if you are contemplating travelling some distance to view the property. Measurements: These approximate room sizes are only intended as general guidance. You must verify the dimensions carefully before ordering carpets or any built-in furniture. Services: Please note we have not tested the services or any of the equipment or appliances in this property, accordingly we strongly advise prospective buyers to commission their own survey or service reports before finalizing their offer to purchase. THESE PARTICULARS ARE ISSUED IN GOOD FAITH BUT DO NOT CONSTITUTE REPRESENTATIONS OF FACT OR FORM PART OF ANY OFFER OR CONTRACT. THE MATTERS REFERRED TO IN THESE PARTICULARS SHOULD BE INDEPENDENTLY VERIFIED BY PROSPECTIVE BUYERS OR TENANTS. NEITHER ROUNDTREE NOR ANY OF ITS EMPLOYEES OR AGENTS HAS ANY AUTHORITY TO MAKE OR GIVE ANY REPRESENTATION OR WARRANTY WHATSOEVER IN RELATION TO THIS PROPERTY.

A fresh approach to your property journey...