



Grayswood Gardens, Raynes Park

Guide Price £525,000 Freehold

5 Double Bedroom House - Off Street Parking - 2 Bathrooms
2 Cloakrooms - Courtyard Garden - Living Room - Kitchen
Close to Waitrose/Tescos & Central Raynes Park - EPC E
Rear Access - Spacious & Flexible Living Space - Garden Shed



Grayswood Gardens, Raynes Park

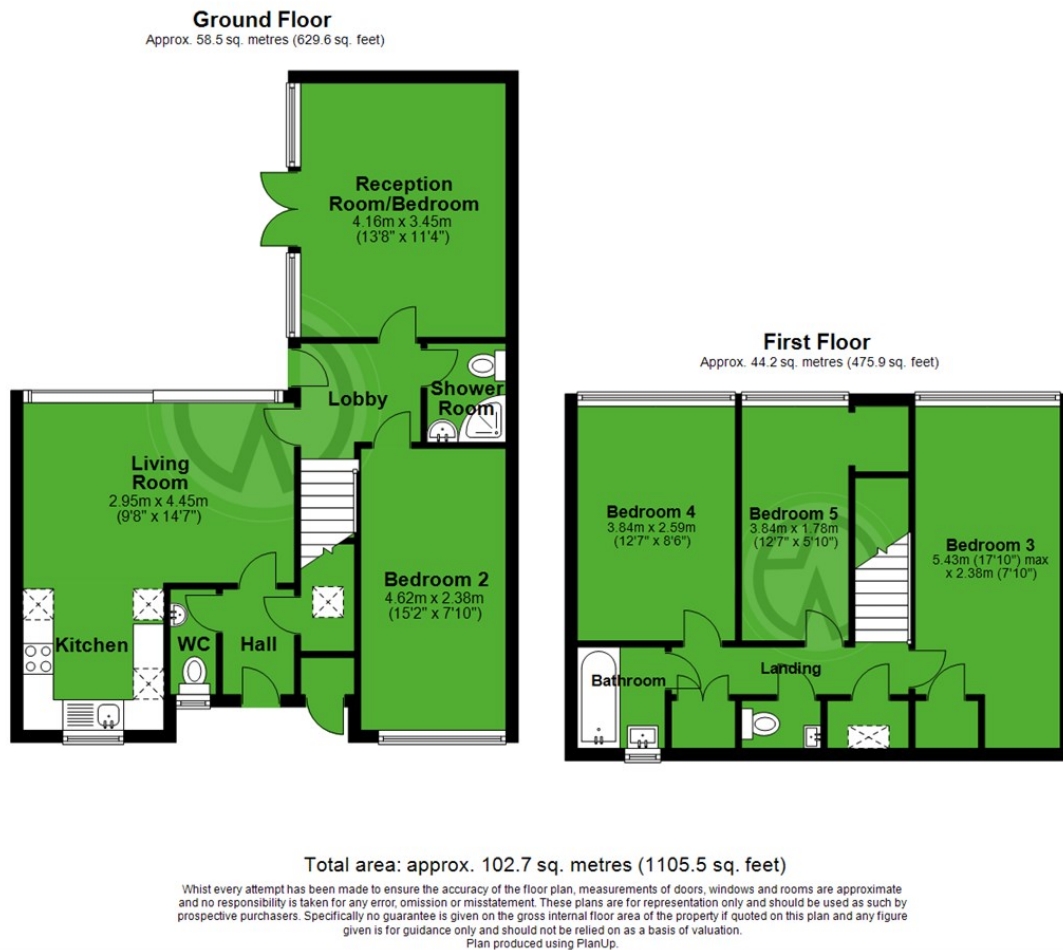

London Borough of Merton
Tax Band C
Freehold

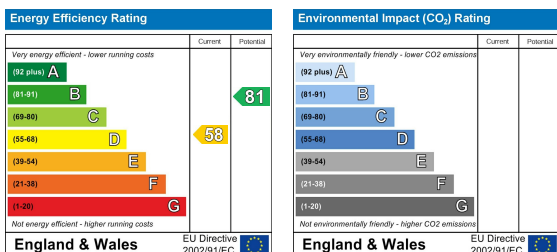

These details and any pictures or plans represent our opinion and are given in good faith for guidance only. They must not be construed as statements or fact. These particulars do not constitute part of an offer or contract. We have not tested the services, appliances or specified fittings and would highly recommend a purchaser to carry out their own survey on the property.