



Finchley Road, London NW3 6HT

WAYNE
& SILVER

Finchley Road, London NW3 6HT

An immaculately presented three double bedroom, three bathroom apartment, situated on the fifth and sixth floors of this portered block.

The apartment comprises of a bright and spacious reception room and dining area, separate kitchen and bedroom (including an en suite shower room) with access to a balcony. Located on the upper floor is the master bedroom with an en suite bathroom, a further double bedroom and family bathroom. The second balcony can be accessed by both bedrooms.

Cresta House is located within close proximity to the local amenities and underground stations of both Swiss Cottage and St. John's Wood (Jubilee and Metropolitan Lines).

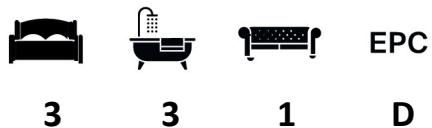

Guide price: £995 Per Week

Tenure:

Service Charge: Add text here

Local Authority:

Council Tax Band:









CRESTA HOUSE

Approximate Gross Internal Area 1087 sq ft / 101.0 sq m

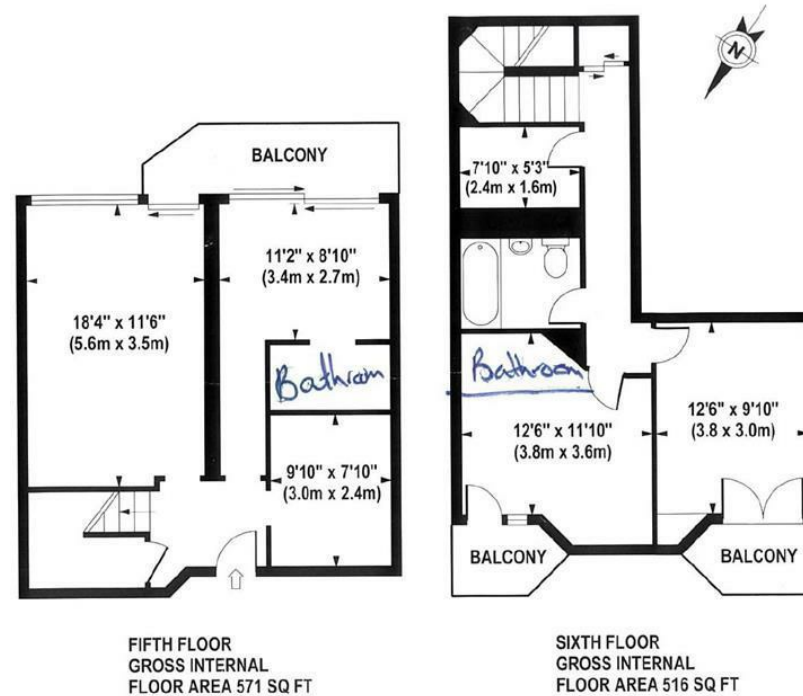

Although every attempt has been made to ensure accuracy, all measurements are approximate.
The floor plan's for illustrative purposes only and not to scale. Measured in accordance to RICS standards.

DE-PHOTOGRAPHY.NET

41 Heath Street
Hampstead
London
NW3 6UA

We would be delighted to tell you more
020 7431 4488
info@wayne-silver.com

wayne-silver.com

Important Notice: Wayne & Silver, its clients and any joint agents give notice that 1: They are not authorised to make or give any representations or warranties in relation to the property either here or elsewhere, either on their own behalf or on behalf of their client or otherwise. They assume no responsibility for any statement that may be made in these particulars. These particulars do not form part of any offer or contract and must not be relied upon as statements or representations of fact. 2: Any areas, measurements or distances are approximate. The text, photographs and plans are for guidance only and are not necessarily comprehensive. It should not be assumed that the property has all necessary planning, building regulation or other consents and Wayne & Silver have not tested any services, equipment or facilities. Purchasers must satisfy themselves by inspection or otherwise.