



Steele Road, London, W4 5AA

£495,000

WHITMAN & CO.

SALES · LETTINGS · COMMERCIAL

- Newly refurbished period conversion flat
- South facing landscaped garden
- Reception room with bay window
- Stylishly presented throughout
- Close to numerous amenities
- Quiet residential street

Tenure - Leasehold
 Lease Length - 103 Years remaining
 Ground rent - £75 pa
 Maintenance costs - 50% of outgoings
 Local Authority - Ealing
 Council Tax - Band C

THE PROPERTY

A newly refurbished, stylishly presented period garden flat located on this quiet residential street close to Chiswick High Road. The accommodation comprises a 14'7" reception room with bay window and wood floors, a double bedroom with wall-to-wall fitted wardrobes, a luxury shower room, a newly fitted kitchen, private south-facing landscaped garden. Steele Road is located within a short walk of local parks, gastro pubs and Chiswick High Road's extensive facilities. Transport links include Chiswick Park and Turnham Green tube stations, South Acton Overground station, local bus routes and the A4/M4 for routes in and out of London.

Steele Road, W4

Approximate gross internal area
 44.87 sq m / 483 sq ft



Key :
 CH - Ceiling Height

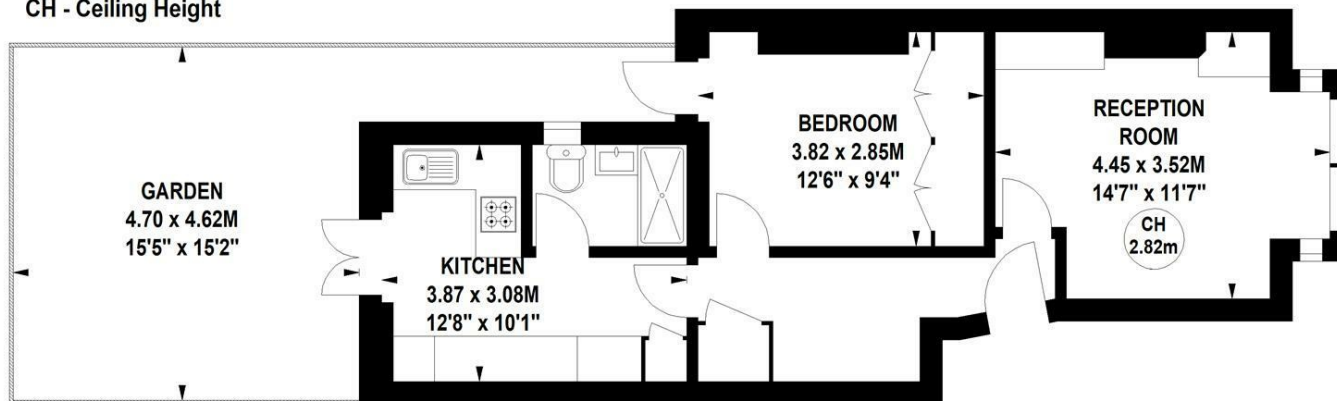

Ground Floor

Not to scale, for guidance only and must not be relied upon as a statement of fact.
 All measurements and areas are approximate only

SITUATION



5-7 Turnham Green Terrace, Chiswick, London, W4 1RG

Tel 020 8747 8800

E-mail sales@whitmanandco.com

Website www.whitmanandco.com