



56 St. Cleres Way, Danbury , Essex CM3 4AF  
£575,000

**Church & Hawes**

Est.1977

Estate Agents, Valuers, Letting & Management Agents



An attractive, refurbished three (potentially four) bedroom family home located in an elevated position within Danbury, just a short walk from Danbury Park Primary School & Danbury Common. This property has undergone extensive renovation by the current vendors including replacement kitchen, windows, creating a large master bedroom suite which includes an ensuite and walk in wardrobe, garden landscaping and air conditioning plus various other decorative improvements. The property also has work started to convert the garage into a usable room which has potential to be a fourth bedroom, or games room (Subject to planning). Energy rating E.

FIRST FLOOR

Master Suite:

Bedroom One 13'1 x 11' (3.99m x 3.35m)

Dressing Room 7'2 x 5'3 (2.18m x 1.60m)

Ensuite Shower Room 7'2 x 5'4 (2.18m x 1.63m)

Bedroom Two 11' x 9'8 (3.35m x 2.95m)

Bedroom Three 9'6 x 9'5 (2.90m x 2.87m)

GROUND FLOOR

Porch Area

Open Plan Lounge/Dining Room & Kitchen 34'3 x 20'6 max (10.44m x 6.25m max)

Garage Conversion (Potential Bedroom Four/Garage C 12' x 7'8 (3.66m x 2.34m)

EXTERIOR

Rear Garden

Front

Agents Notes

These particulars do not constitute any part of an offer or contract. All measurements are approximate. No responsibility is accepted as to the accuracy of these particulars or statements made by our staff concerning the above property. We have not tested any apparatus or equipment therefore cannot verify that they are in good working order. Any intending purchaser must satisfy themselves as to the correctness of such statements within these particulars. All negotiations to be conducted through Church and Hawes. No enquiries have been made with the local authorities pertaining to planning permission or building regulations. Any buyer should seek verification from their legal representative or surveyor.



GROUND FLOOR

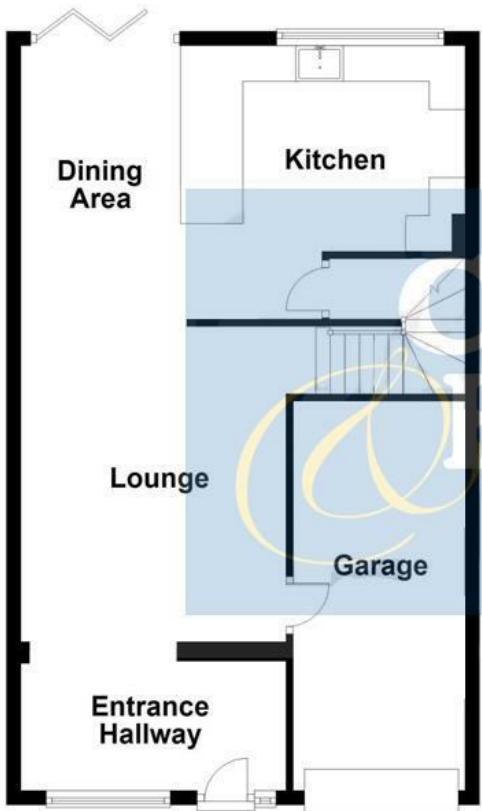

FIRST FLOOR

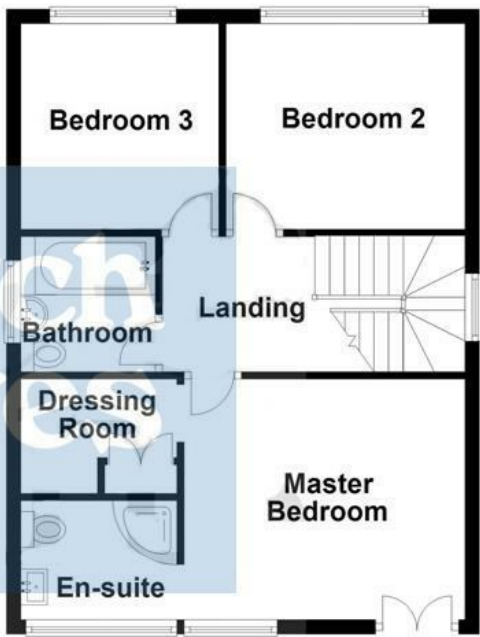

NOT TO SCALE