



# The Lanterns Coast Road, Walcott

Guide Price £700,000

# The Lanterns Coast Road

Walcott, Norwich

\*Guide Price £700,000 - £750,000\* This exceptional home seamlessly blends refined living and versatility, positioned against the breathtaking backdrop of the Norfolk countryside. This contemporary detached residence includes a self-contained annex currently thriving as a successful Airbnb. The interior boasts expansive living spaces and three generously proportioned double bedrooms, each featuring luxurious ensuite bathrooms, complemented by a galleried landing that opens to a private balcony with stunning views. The magnificent garden features a spacious open-air pool, a fish pond, and landscaped shrubbery that enhances its appeal. This property presents a rare opportunity to indulge in the finest elements of both coastal and countryside living.

Council Tax band: E

Tenure: Freehold

EPC Energy Efficiency Rating:

EPC Environmental Impact Rating:





## The Lanterns Coast Road

Walcott, Norwich

\*Guide Price £700,000 - £750,000\* This exceptional home seamlessly blends refined living and versatility, positioned against the breathtaking backdrop of the Norfolk countryside. This contemporary detached residence includes a self-contained annex currently thriving as a successful Airbnb. The interior boasts expansive living spaces and three generously proportioned double bedrooms, each featuring luxurious ensuite bathrooms, complemented by a galleried landing that opens to a private balcony with stunning views. The magnificent garden features a spacious open-air pool, a fish pond, and landscaped shrubbery that enhances its appeal. This property presents a rare opportunity to indulge in the finest elements of both coastal and countryside living.

### The Location

Situated along the picturesque Coast Road in Walcott, The Lanterns boasts a coastal location with breathtaking sea views and easy access to the beach just steps away. The nearby village of Happisburgh, famous for its iconic lighthouse, is just 2 miles away, offering local pubs and coastal walks. The bustling market town of North Walsham is 7 miles inland, providing a range of supermarkets, shops and schooling options, while the charming seaside resort of Mundesley is only 5 miles along the coast, perfect for a day out.

For a broader range of shopping, dining, and cultural experiences, the historic city of Norwich is 19 miles away, easily accessible via the A149 and A1151. Cromer, known for its traditional pier and seafood, is just 12 miles to the north, offering



GROUND FLOOR

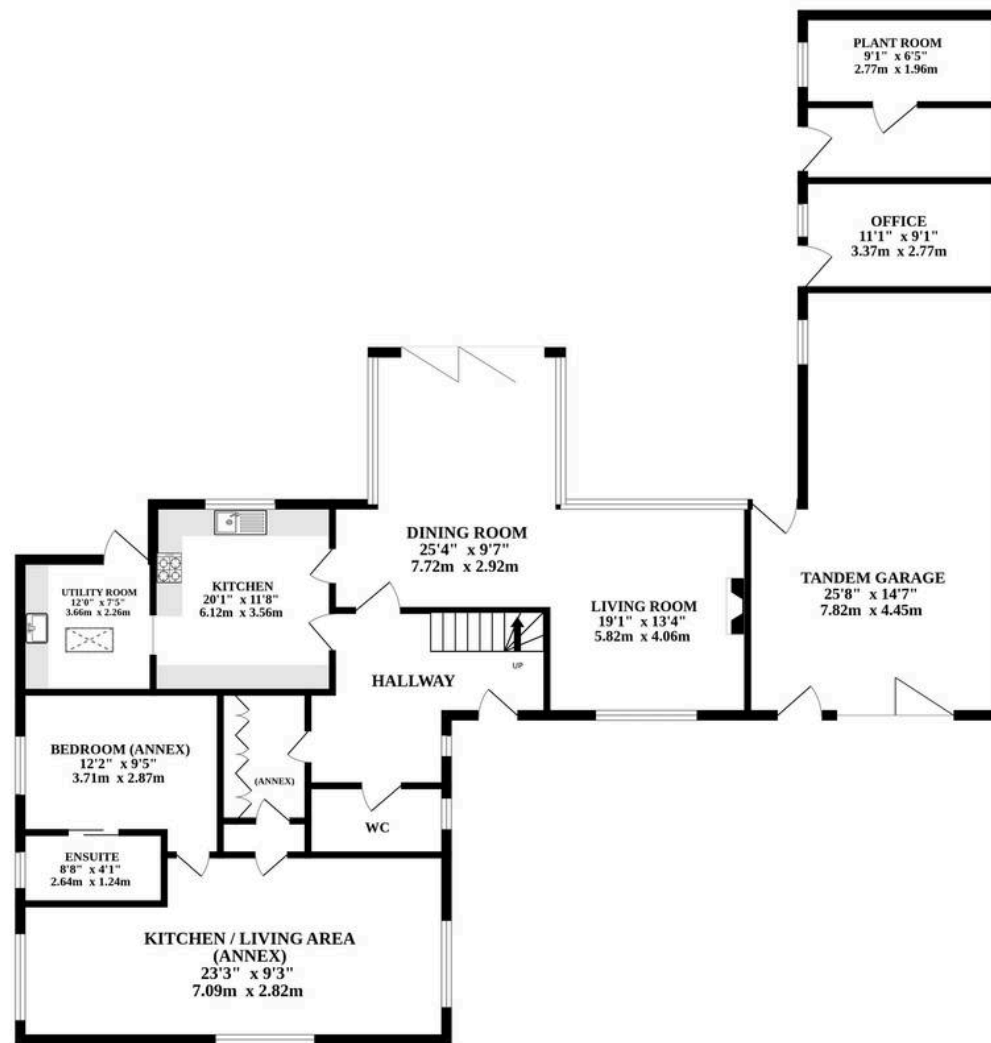

1ST FLOOR

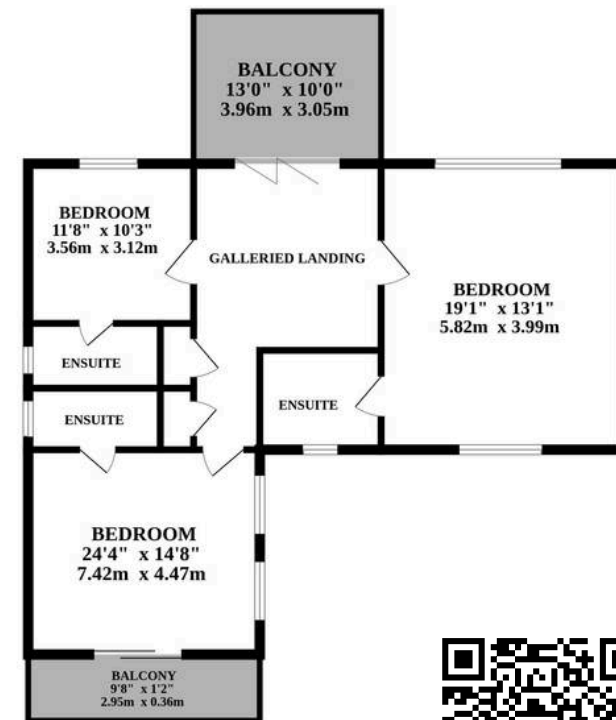

Whilst every attempt has been made to ensure the accuracy of the floorplan contained here, measurements of doors, windows, rooms and any other items are approximate and no responsibility is taken for any error, omission or mis-statement. This plan is for illustrative purposes only and should be used as such by any prospective purchaser. The services, systems and appliances shown have not been tested and no guarantee as to their operability or efficiency can be given.  
 Made with Metropix ©2024