



Palmer & Partners



Palmer & Partners

GLENEAGLES DRIVE

Gleneagles Drive, Ipswich, Suffolk, IP4 5SQ

GP: £375,000 to £385,000

Gleneagles Drive, Ipswich, Suffolk, IP4 5SQ

Situated towards the popular east side of Ipswich close to Ipswich Hospital and falling within the Copleston School catchment (subject to availability), lies this substantial three bedroom detached bungalow which is being sold with no onward chain. This spacious bungalow benefits from gas central heating; replacement soffits, fascias and double glazed windows and doors; good size south-facing side garden with additional garden to the rear; driveway providing off-road parking; and detached garage to the rear.

As agents, we recommend the earliest possible internal viewing to appreciate the quality of accommodation on offer which comprises front porch, entrance hall, lounge / dining room, conservatory, kitchen / breakfast room with large walk-in pantry cupboard, three good size double bedrooms, and refitted shower room.

Agent's note.

In 2011, full plans were drawn up and an official application was made to Ipswich Borough Council for planning permission for an additional dwelling on the side garden, for the severance of the garden, and erection of a bungalow. At the time, planning permission was refused and the application reference number is IP/11/00973/FULL.

The county town of Ipswich offers a range of local amenities including schools, university, shops, doctors, dental surgeries, hospital, two theatres, parks including the popular Orwell Country Park, recreational facilities, and mainline railway station providing direct links to London Liverpool Street Station. The vibrant waterfront has undergone an extensive rebuilding and gentrification programme and now boasts some fashionable bars and restaurants, together with the University of Suffolk.

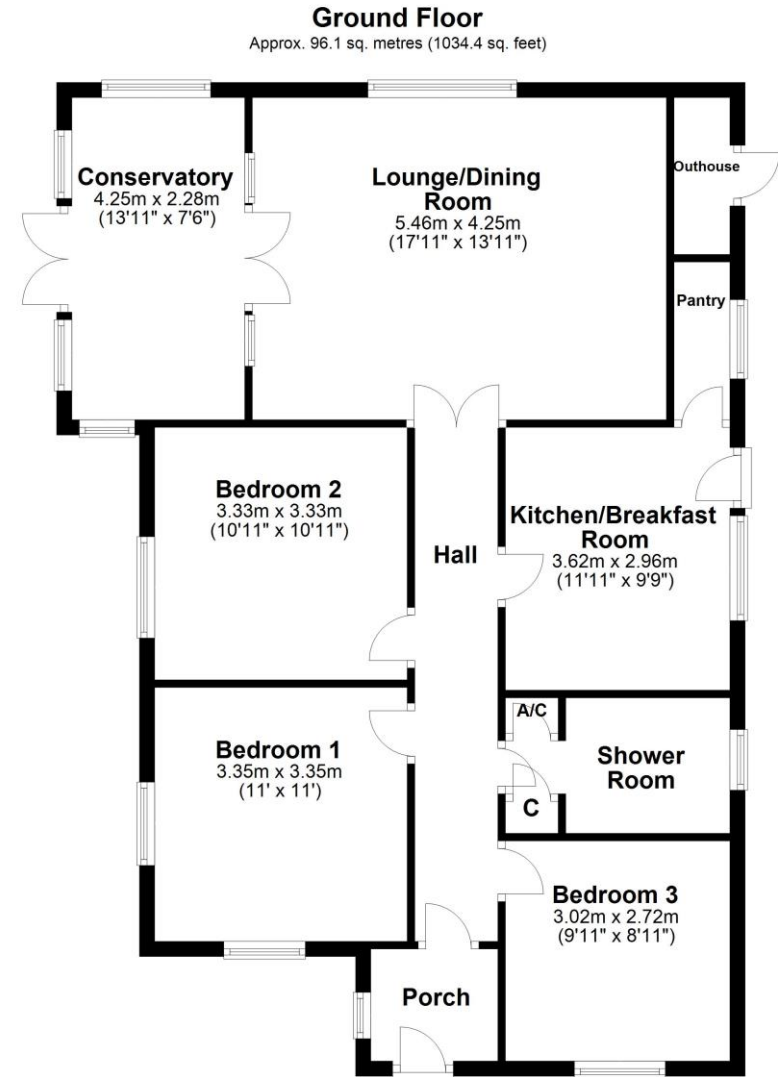

Total area: approx. 96.1 sq. metres (1034.4 sq. feet)

Although every attempt has been made to ensure the accuracy of this floorplan measurements of doors, windows, rooms and any other items are approximate and no responsibility is taken for any error, omission or mis-statement. This plan is for illustrative purposes only.
Plan produced using PlanUp.



