



## 450 Cowley Road, Cowley, Oxford, Oxfordshire, OX4 2DW

A well located five bedroom semi-detached house situated on the popular Cowley Road.

The property benefits from large driveway parking for multiple cars. This spacious house consists of good size living room, kitchen, bathroom, WC, 4 double size bedrooms and further single bedroom. Double glazing, gas central heating and private rear garden.

- 5 Bedrooms
- 1 Receptions
- 1 Bathroom
- House
- Furnished Property
- Medium Sized Garden
- Driveway Parking Available

**£2,700 PCM**

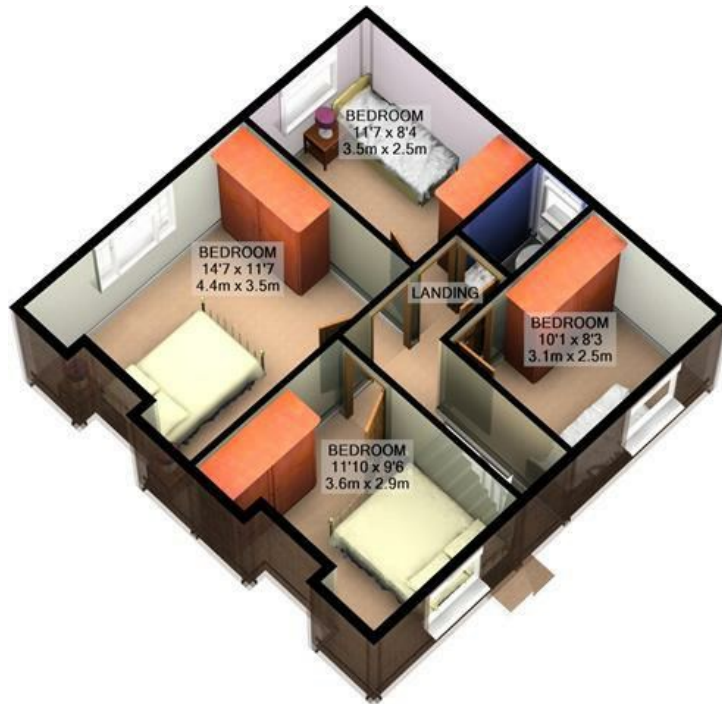

1ST FLOOR



GROUND FLOOR

Made with Metropix ©2010

Energy Efficiency Rating		Current	Potential
Very energy efficient - lower running costs			
(92 plus) <b>A</b>			
(81-91) <b>B</b>			
(69-80) <b>C</b>			
(55-68) <b>D</b>			
(39-54) <b>E</b>			
(21-38) <b>F</b>			
(1-20) <b>G</b>			
Not energy efficient - higher running costs			
		<b>60</b>	<b>80</b>
<b>England &amp; Wales</b>	EU Directive 2002/91/EC		

Environmental Impact (CO <sub>2</sub> ) Rating		Current	Potential
Very environmentally friendly - lower CO <sub>2</sub> emissions			
(92 plus) <b>A</b>			
(81-91) <b>B</b>			
(69-80) <b>C</b>			
(55-68) <b>D</b>			
(39-54) <b>E</b>			
(21-38) <b>F</b>			
(1-20) <b>G</b>			
Not environmentally friendly - higher CO <sub>2</sub> emissions			
<b>England &amp; Wales</b>	EU Directive 2002/91/EC		