



Auckland Hill, SE27 | £600,000

02087029999

development@pedderproperty.com

pedder
NEW HOMES



In General

- Three Bedrooms
- Two Modern Bathrooms
- South Facing Private Garden
- Communal Garden
- Cycle Storage
- Internal Storage
- Lift
- Modern Finish throughout
- Long lease of 123 Years
- No onward chain

In Detail

Pedder are delighted to market this stunning 3-bedroom, 2-bathroom apartment located in the prestigious DoultonPark development on Auckland Hill, West Norwood. This modern residence offers a perfect blend of contemporary living and convenience, making it an ideal home for families and professionals alike.

The apartment features three bedrooms that provide ample space for relaxation and comfort. The two sleek, modern bathrooms are equipped with high-quality fittings. With an abundance of natural light, the apartment creates a bright and welcoming atmosphere throughout. Additionally, you can enjoy your own private south facing garden, perfect for outdoor dining, gardening, or simply unwinding. Secure cycle storage is also available, catering to your active lifestyle. The apartment boasts floor to ceiling windows allowing an abundance of light into the flat with modern fixtures and fittings throughout including Bosch appliances to the contemporary kitchen with quartz worktops, Duravit bathroom suite and underfloor heating throughout, there is also six years cover under the full structural warranty.

Situated on Auckland Hill, this apartment benefits from excellent transport links. West Norwood Station is just a short walk away, offering direct services to London Bridge and London Victoria. Several bus routes provide easy access to surrounding areas.

West Norwood boasts a vibrant community with a variety of amenities right on your doorstep. Enjoy a diverse selection of bars, shops, and restaurants, including the popular West Norwood Picturehouse, a local cinema. The area also features several green spaces, such as Norwood Park, perfect for outdoor activities and relaxation.

This apartment in the DoultonPark development offers a unique opportunity to experience modern living in a well-connected and thriving neighborhood. Don't miss out on making this exceptional property your new home!

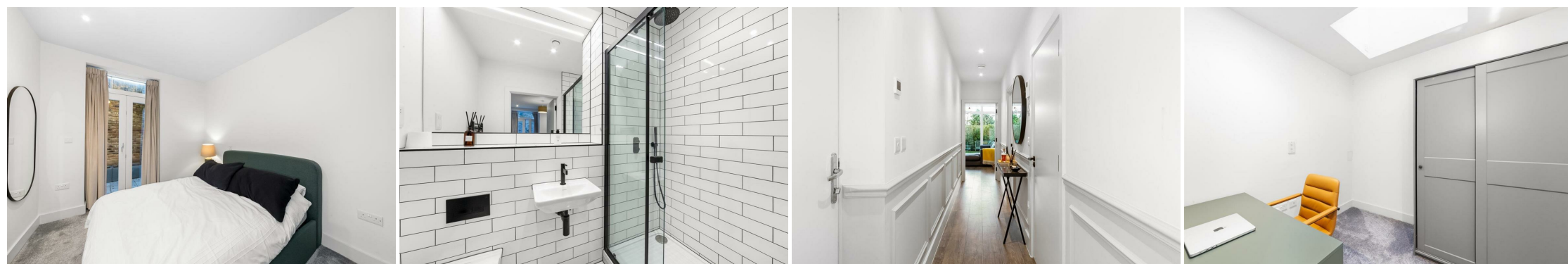

Floorplan

Auckland Hill, SE27

Approximate Gross Internal Area
74.5 sq m / 802 sq ft

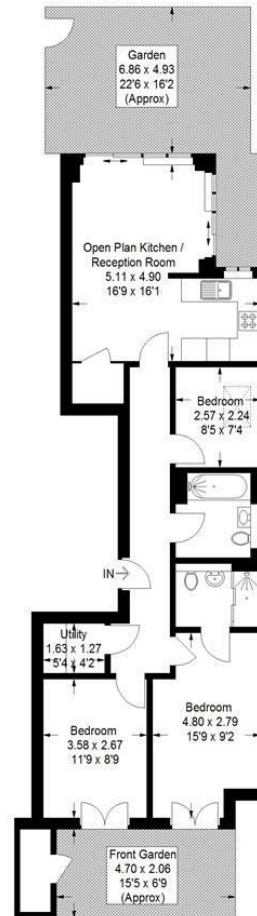

Lower Ground Floor

Copyright www.pedderproperty.com © 2024
These plans are for representation purposes only as defined by RICS - Code of Measuring Practice. Not drawn to Scale. Windows and door openings are approximate. Please check all dimensions, shapes and compass bearings before making any decisions reliant upon them.

Energy Efficiency Rating		Current	Potential
Very energy efficient - lower running costs			
102 plus) A		84	
81-101) B			
69-80) C			
55-68) D			
39-54) E			
21-38) F			
1-20) G			
Not energy efficient - higher running costs			
England & Wales		EU Directive 2002/91/EC	

Pedder Property Ltd trading as Pedder for themselves and for the vendor/landlord of this property whose agents they are, give notice that (1) these particulars do not constitute any part of an offer or contract, (2) all statements contained within these particulars are made without responsibility on the part of Pedder or the vendor/landlord, (3) whilst made in good faith, none of the statements contained within these particulars are to be relied upon as a statement of representation or fact, (4) any intending purchaser/tenant must satisfy him/herself by inspection or otherwise as to the correctness of each of the statements contained within these particulars, (5) the vendor/landlord does not make or give either Pedder or any person in their employment any authority to make or give representation or warranty whatsoever in relation to this property.