

Matilda Groome Road Hadleigh, Ipswich, IP7

Offers in excess of:
£450,000





Palmer & Partners

- Potentially No Onward Chain
- Four Bedroom Detached House
- One Bedroom Annexe / Office
- Bathroom & En-Suite Shower Room
- 20ft Dual Aspect Sitting Room
- Garage & Off-Road Parking
- Solar Panels
- Lovely Front & Rear Gardens



Situated on the edge of a popular residential development in the market town of Hadleigh, close to the town centre and offering good access to Ipswich and Sudbury mainline train stations, lies this substantial four bedroom detached house which comes with a self-contained one bedroom annexe which could be used as additional accommodation or as a home office / studio. The beautifully presented family home occupies a good size plot and benefits from solar panels, off-road parking for multiple vehicles, detached single garage, well-maintained rear garden housing the annexe, and the vendor could offer the property with no onward chain. As agents, we recommend the earliest possible internal viewing to appreciate the quality of accommodation on offer which comprises entrance hall; ground floor cloakroom; 20ft dual aspect sitting room; generous kitchen / dining room with integrated appliances; first floor landing; family bathroom; and four bedrooms, one of which has an en-suite shower room. The annexe accommodation comprises entrance hall, bedroom / living / office with kitchenette area, and shower room.



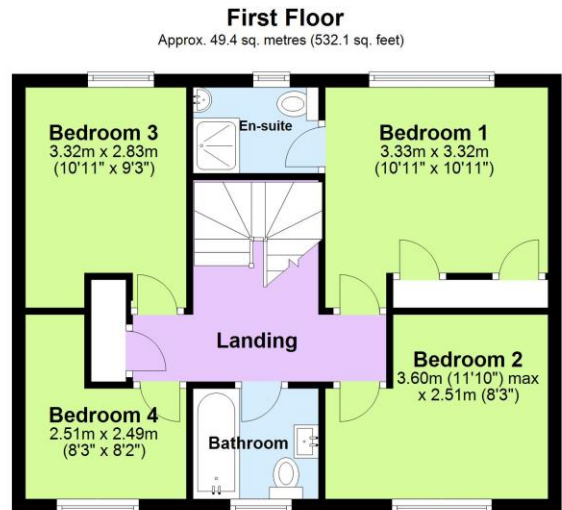
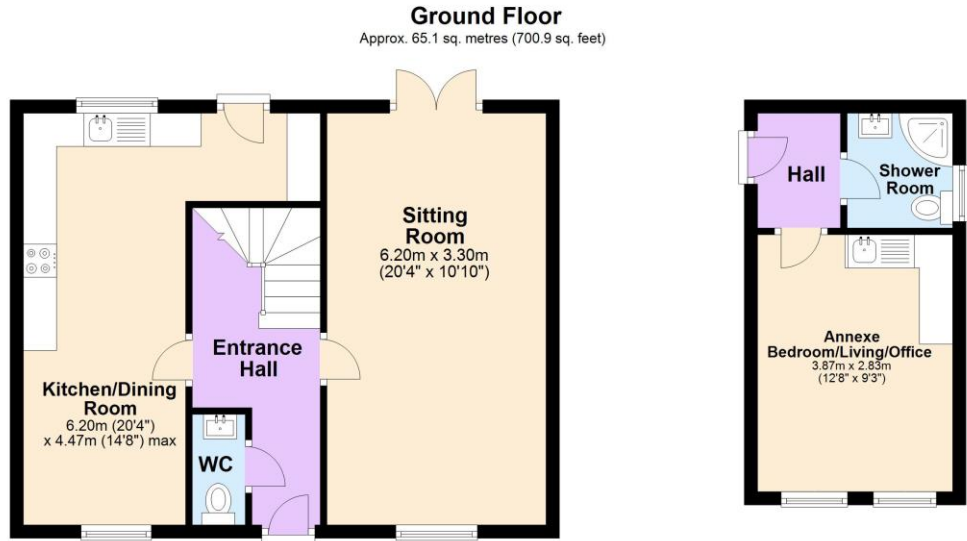

Total area: approx. 114.6 sq. metres (1233.1 sq. feet)

Although every attempt has been made to ensure the accuracy of this floorplan measurements of doors, windows, rooms and any other items are approximate and no responsibility is taken for any error, omission or mis-statement. This plan is for illustrative purposes only.
Plan produced using PlanUp.



Palmer & Partners

2 St Nicholas Street

Ipswich, Suffolk, IP1 1TJ

T: 01473 211705

E: suffolk@palmerpartners.com

www.palmerpartners.com

Whilst every attempt has been made to ensure the accuracy of the floor plans contained here, measurements of doors, windows and rooms are approximate and no responsibility is taken for any error, omission or mis-statement. These plans are for representation purposes only as defined by RICS Code of Measuring Practice and should be used as such by any prospective purchaser. The services, systems and appliances listed in this specification have not been tested and no guarantee as to their operating ability or their efficiency can be given.

