

BLOOMSBURY HOUSE, HIGHFIELD ROAD **£220,000**
BIRMINGHAM, B15 3EH **LEASEHOLD**

Gated Residence | South Facing Gardens | Top Floor | Allocated Parking | Low Service Charge | Located on the Calthorpe Estate | Walking distance to Birmingham City Centre | High Spec throughout.

Davidson

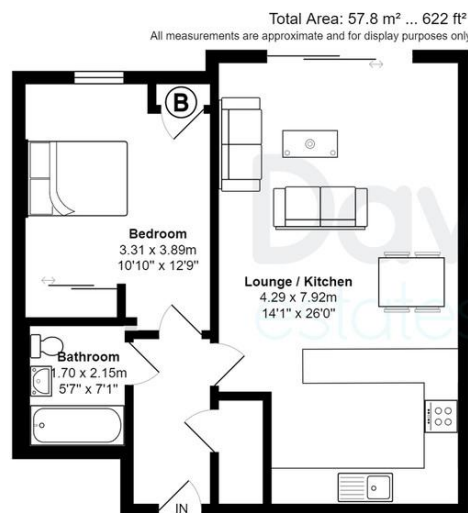

Floorplan measurements are for illustrative purpose only. Floor plan by www.sebastiano.co.uk.

Energy Efficiency Rating			
Score	Energy rating	Current	Potential
92+	A		
81-91	B	83 B	83 B
69-80	C		
55-68	D		
39-54	E		

Davidson

OFFICE
 14 Frederick Road
 Birmingham
 West Midlands
 B15 1JD

0121 455 7727
 info@davidsonstates.co.uk
 www.davidsonstates.co.uk

Agents Note: Whilst every care has been taken to prepare these particulars, they are for guidance purposes only. All measurements are approximate and are for general guidance purposes only and whilst every care has been taken to ensure their accuracy, they should not be relied upon and potential buyers/tenants are advised to recheck the measurements