



Alconbury Close, Borehamwood

£299,999

- RENTAL INVESTORS ONLY (TENANTED PROPERTY)
- BUY TO LET INVESTMENT OPPERTUNITY
- 2 double bedroom flat
- Parking space
- Separate kitchen
- Good condition
- £1,300 PER calender month rental income
- Communal gardens

Sommerville Court, Alconbury Close, Borehamwood, Hertfordshire WD6 4QH

Approximate Area = 60 sq m / 646 sq ft
For identification only - Not to scale

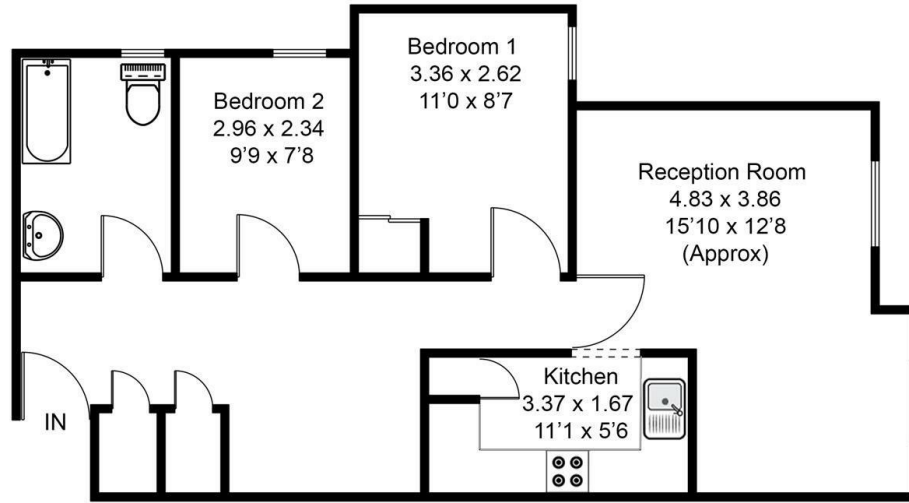

GROUND FLOOR FLAT

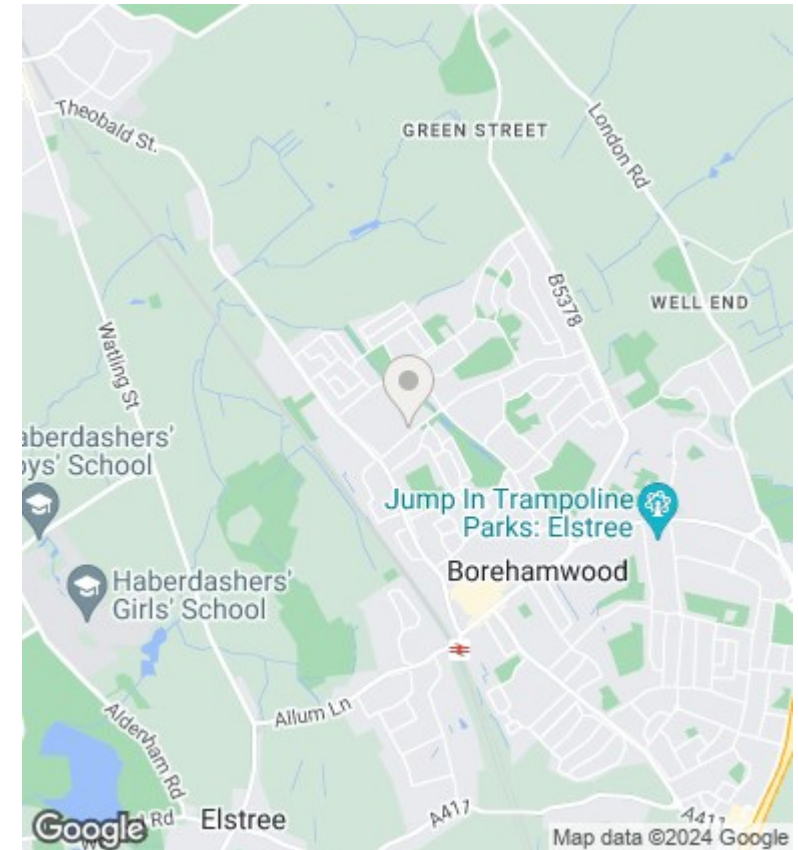

Directions

The property is located 0.9 miles from Elstree & Borehamwood train station and a short walk to the local schools, shops and places of worship.

Viewings

Viewings by arrangement only. Call +44 20 3300 3550 to make an appointment.

Council Tax Band

C

EPC Rating:

C

Energy Efficiency Rating		
	Current	Potential
Very energy efficient - lower running costs		
(92 plus) A		
(81-91) B	77	
(69-80) C		
(55-68) D		
(39-54) E		
(21-38) F		
(1-20) G		
Not energy efficient - higher running costs		
England & Wales	EU Directive 2002/91/EC	