



Main Road, Woodham Ferrers, Essex CM3 8RN
£280,000

Church & Hawes

Est. 1977

Estate Agents, Valuers, Letting & Management Agents

A WONDERFUL CHARACTER SEMI-DETACHED COTTAGE having undergone many improvements. The property is located in a non-estate position with farmland views to the front and rear aspects. Features include a lovely open plan kitchen and dining area, a second bedroom with 'Juliet' balcony overlooking the gardens and a solid fuel cast iron wood burner. The cottage affords many of the period features one would expect including, oak floors, fireplaces, original internal doors and exposed ceiling timbers. Less than 2 miles away is South Woodham Ferrers with it's many shops, amenities, supermarkets and railway station. Energy rating E.



FIRST FLOOR

Bedroom One 11'5 x 10' (3.48m x 3.05m)

Bedroom Two 9'8 x 8'8>6'8 (2.95m x 2.64m>2.03m)

Bathroom

Landing

GROUND FLOOR

Entrance Porch

Lounge 11'6 x 11'4 (3.51m x 3.45m)

Kitchen 11'5 x 7'7 (3.48m x 2.31m)

Dining Area 10' x 9'3 (3.05m x 2.82m)

EXTERIOR

Front

West Facing Rear Garden

Agents Notes

These particulars do not constitute any part of an offer or contract. All measurements are approximate. No responsibility is accepted as to the accuracy of these particulars or statements made by our staff concerning the above property. We have not tested any apparatus or equipment therefore cannot verify that they are in good working order. Any intending purchaser must satisfy themselves as to the correctness of such statements within these particulars. All negotiations to be conducted through Church and Hawes. No enquiries have been made with the local authorities pertaining to planning permission or building regulations. Any buyer should seek verification from their legal representative or surveyor.





Ground Floor

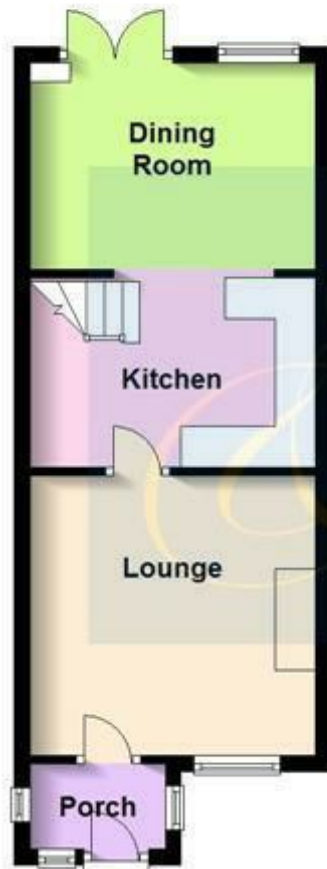

First Floor

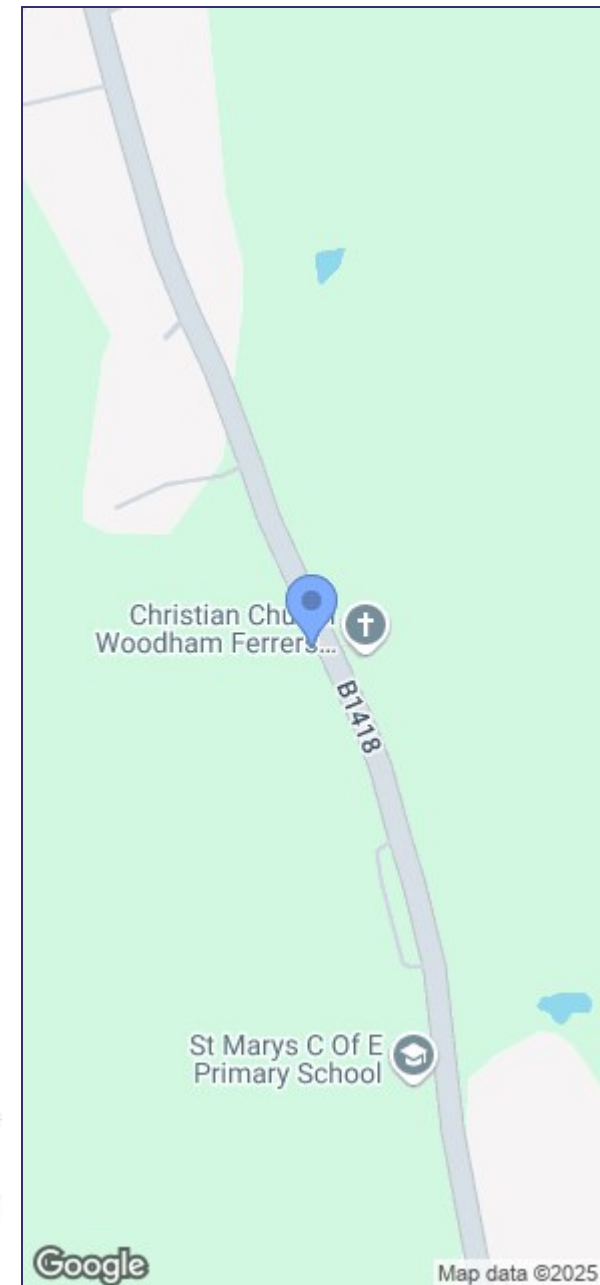

Produced by Property Trader 01245 323355Disclaimer:All floorplans are provided for informational and illustrative purposes only. Although we endeavour to provide truthful representation, we do not in any way warrant the accuracy of the floorplan information and the floorplan layout and measurements may contain errors and omissions. We are not liable for and do not accept any liability relating to any loss or damage suffered as a direct or indirect result of use of any information You or your advisors should conduct a careful, independent investigation of the property to determine to your satisfaction as to the suitability of the property for your full requirements.
Plan produced using The Mobile Agent.