



The Tower, 1 St George Wharf, Vauxhall SW8 2DU

£1,999,950

- 24/7 concierge
- VIDEO VIEWING AVAILABLE
- dining / meeting room
- SWIMMING POOL OVERLOOKING RIVER

- 24 HOUR CONCIERGE
- cinema
- DINNING / MEETING ROOM

- gym/spa
- DIRECT RIVER VIEWS
- business lounge

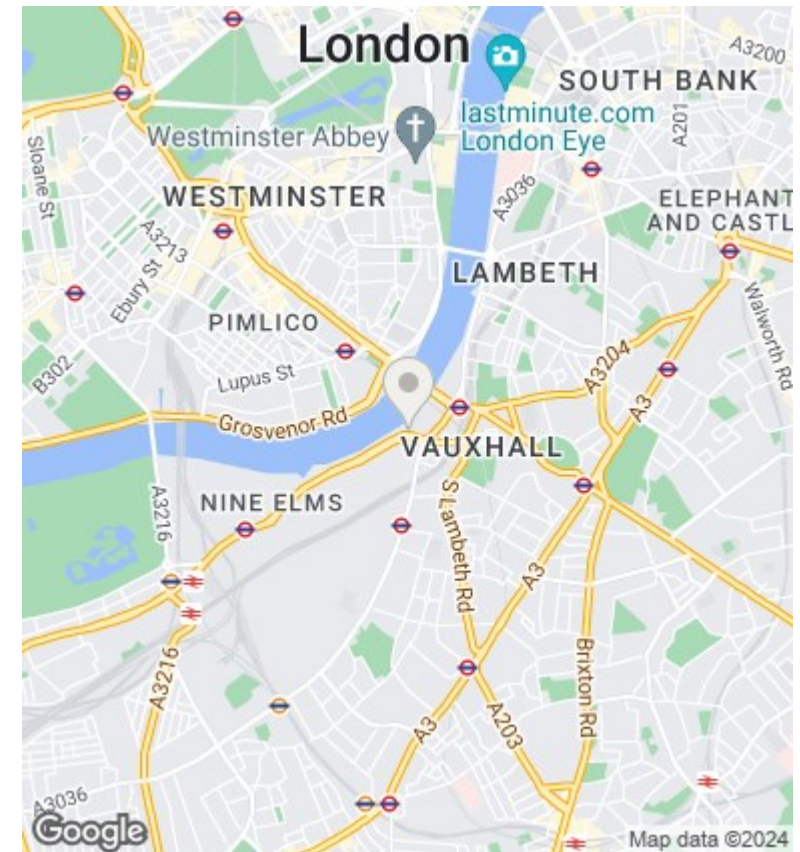
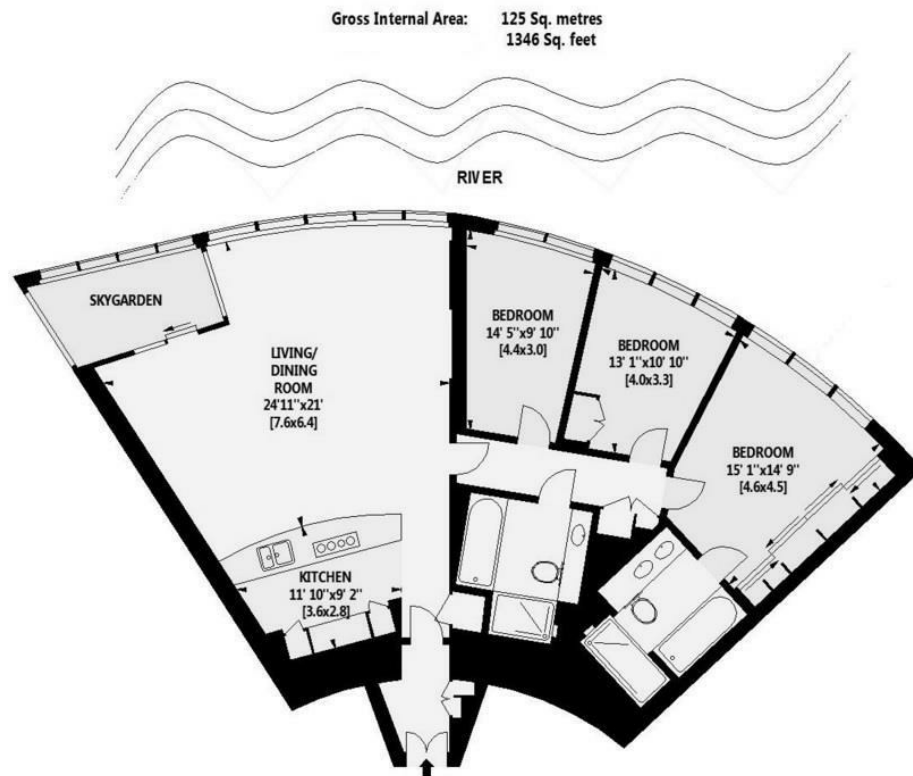

Viewings

Viewings by arrangement only.
Call 02077225022 to make an appointment.

Council Tax Band

H

EPC Rating:

B

Energy Efficiency Rating		Current	Potential
<i>Very energy efficient - lower running costs</i>			
(92 plus)	A		
(81-91)	B	84	84
(69-80)	C		
(55-68)	D		
(39-54)	E		
(21-38)	F		
(1-20)	G		
<i>Not energy efficient - higher running costs</i>			
England & Wales		EU Directive 2002/91/EC	