

SW19

it's all in the postcode...



Brangwyn Crescent

Colliers Wood

425000

- Two bedrooms
- Garden and balcony
- Split level
- Own front door
- Modern inside



020 8544 2828

Wimbledon: Wimbledon Park: Colliers Wood

www.SW19.com

SW19 Estate Agents Ltd. Is registered in England & Wales No. 05508737

'it's all in the postcode...'

SW19 are proud to present this two double bedroom split level maisonette located on a quiet residential cul-du-sac walking distance to Colliers Wood town and the Northern line tube. Short walk from Morden Hall National Trust Park. Private entrance, long lease and ample parking, including designated space. Perfect for the first time buyers. Spacious reception with doors leading to a balcony. fitted kitchen with plenty of storage. Spacious bedrooms, loft and garden. A really attractive property. Call us now to arrange your viewing and avoid disappointment.



020 8544 2828

Wimbledon: Wimbledon Park: Colliers Wood

www.SW19.com

SW19 Estate Agents Ltd. Is registered in England & Wales No. 05508737

'it's all in the postcode...'

Brangwyn Crescent

Approximate Gross Internal Area
733 sq ft / 68.13 sq m

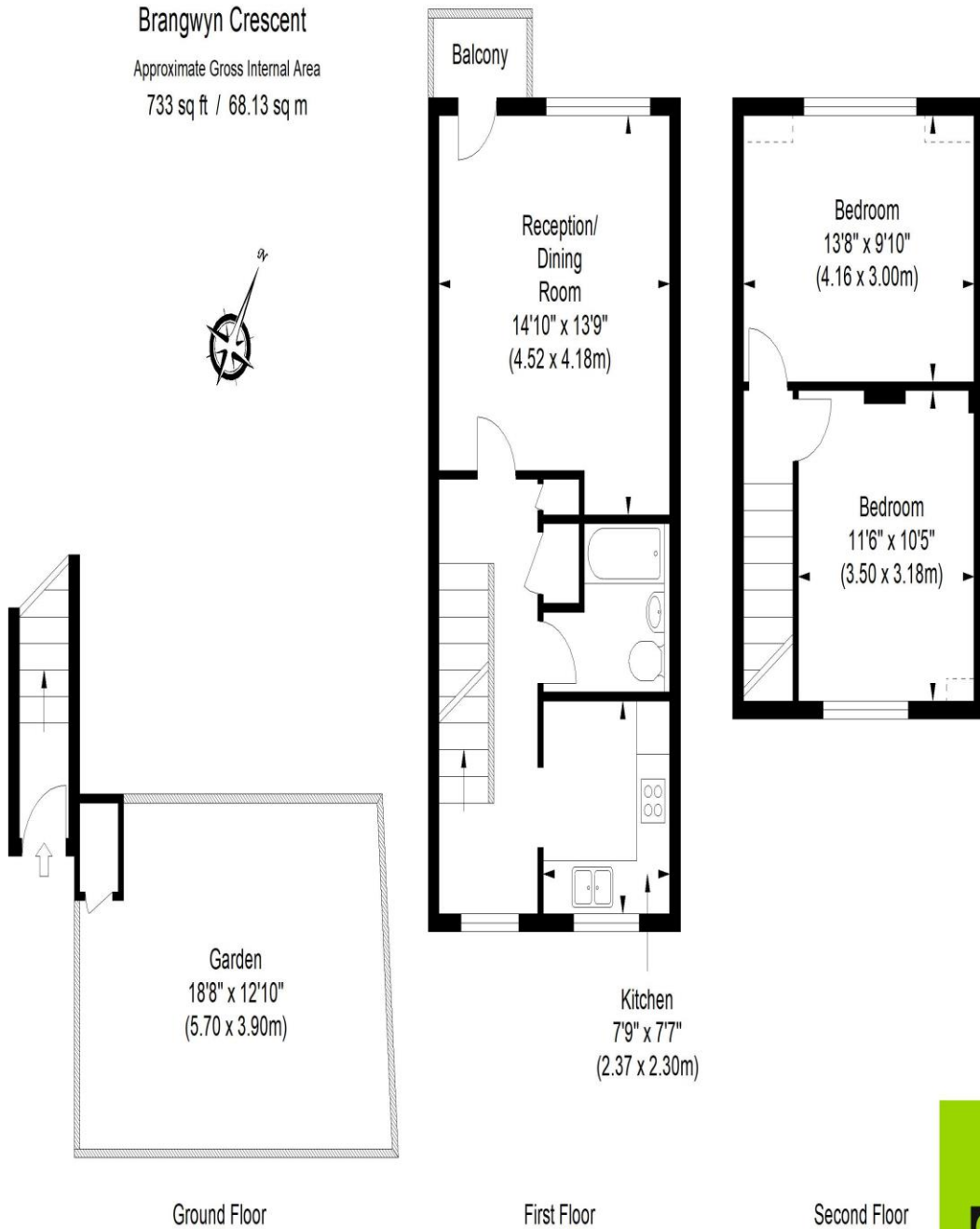

ILLUSTRATION FOR IDENTIFICATION PURPOSES ONLY

ALL MEASUREMENTS ARE MAXIMUM, AND INCLUDE WINDOW BAYS AND WARDROBES WHERE APPLICABLE
THIS PLAN MUST NOT BE REPRODUCED BY ANY OTHER PERSON WITHOUT PERMISSION



These particulars are for guidance only and should not be relied upon as a statement or representation of fact. All measurements given are approximate only and should not be relied upon for ordering carpets, equipment etc. Purchasers should satisfy themselves by inspection or otherwise as to the accuracy of the

020 8544 2828

Wimbledon: Wimbledon Park: Colliers Wood

www.SW19.com

SW19 Estate Agents Ltd. is registered in England & Wales No. 05508737

'it's all in the postcode...'

statements contained within. Neither SW19 estate agents ltd or related companies or their employees can confirm structural conditions of the property or that any appliances or other facilities are in working order. Purchasers are strongly recommended to arrange their own survey.

020 8544 2828

Wimbledon: Wimbledon Park: Colliers Wood

www.SW19.com

SW19 Estate Agents Ltd. Is registered in England & Wales No. 05508737

'it's all in the postcode...'