



Birnbeck Court, Temple Fortune, NW11

Leasehold

£199,999



800 finchley road, hampstead garden suburb, london, nw11 7tj

telephone 020 8458 5000 facsimile 020 8209 2068

email sales@litchfields.com web litchfields.com

offices also in crouch end & highgate

ONLY 55's ONLY. The first floor flat consists of one double bedroom, a shower room, a double reception room, and a kitchen. It is situated in a warden assisted block that was built in 1985 and is exclusively for individuals aged 55 and above. The property is conveniently located near the various amenities of Temple Fortune. Additional features include non-allocated off-street parking, well-kept communal gardens, a communal residents lounge, 24-hour resident management staff, and a Careline alarm service.

1 double bedroom | Lounge/dining room | Kitchen | Shower room | Close to Temple Fortune
| EPC=C



Birnbeck Court, NW11

Approximate Gross Internal Floor Area = 53.6 sq m / 577 sq ft

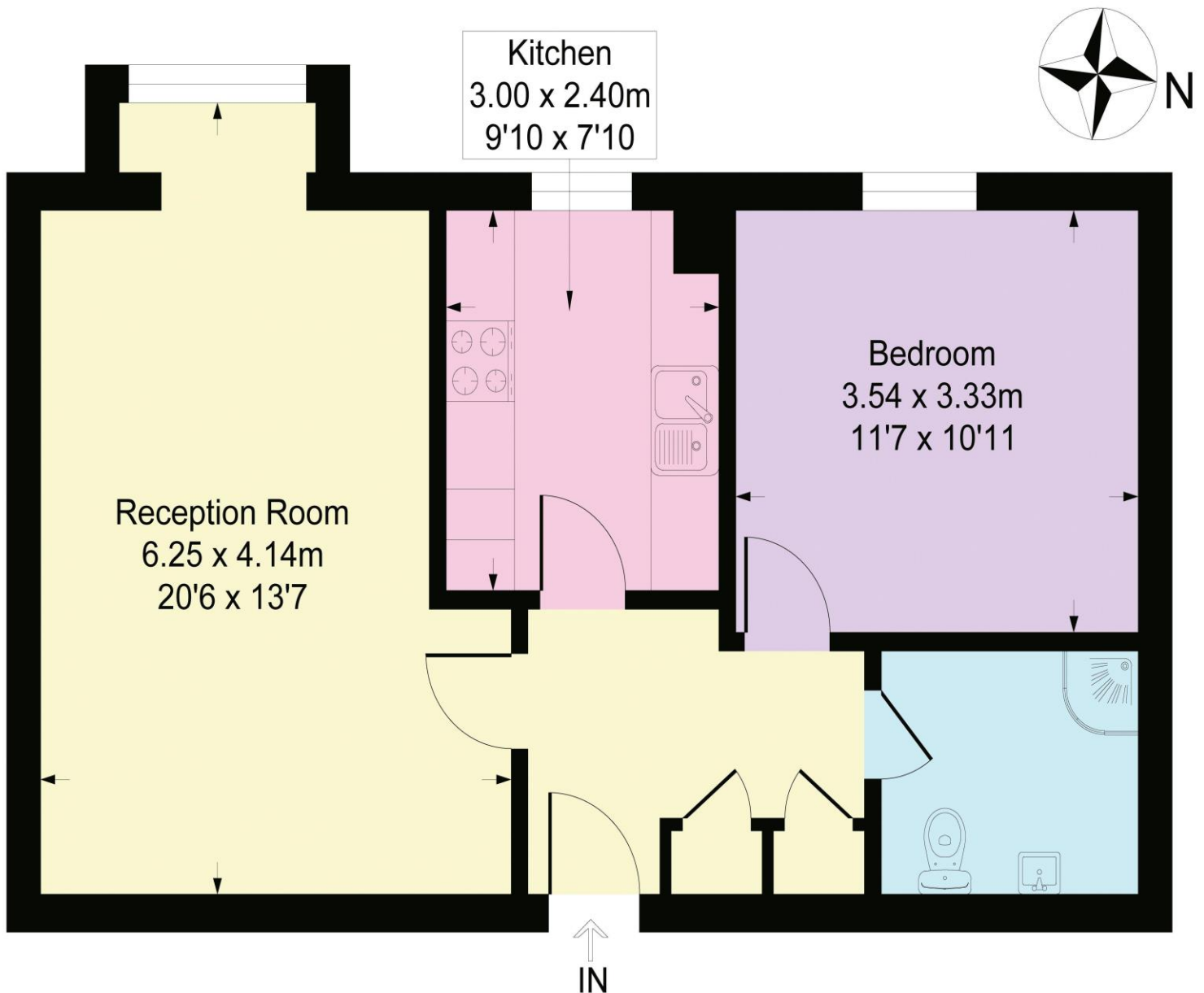

First Floor

This Plan is not to scale and must be used as layout guidance only. All measurements and areas are approximate and should not be relied upon to provide accurate information. This plan must not be relied upon when making property valuations, design considerations or any other such relevant decisions. We accept no responsibility or liability (whether in contract, tort or otherwise) in relation to any loss whatsoever arising from or in connection with any use of this plan or the adequacy or completeness of it or any information within it.

Whilst every effort is made to ensure these details are accurate, all measurements given are approximate and for guidance only. We are unable to comment on the structure of the building or services and any investigations should be carried out by a qualified surveyor. We strongly advise you to ensure that all legal aspects are fully investigated by your solicitor prior to a purchase. We have not applied tests to any appliances or equipment and therefore cannot verify these are in good working order. We understand from the vendor that the fixtures and fittings listed are to be included in the sale price but these may be subject to negotiation.