

# URBAN lettings



32 Burns Road, London, SW11 5AG

£2,500 PCM

- Immaculately Presented
- Two Double Bedrooms
- Ground Floor End of Terrace Flat
- Conservation Area
- Newly Refurbished
- Fitted Kitchen with Dishwasher & Washer Dryer
- Walk In Storage Cupboard
- Separate Living Room
- Large Rear Garden
- Wandsworth Council Tax

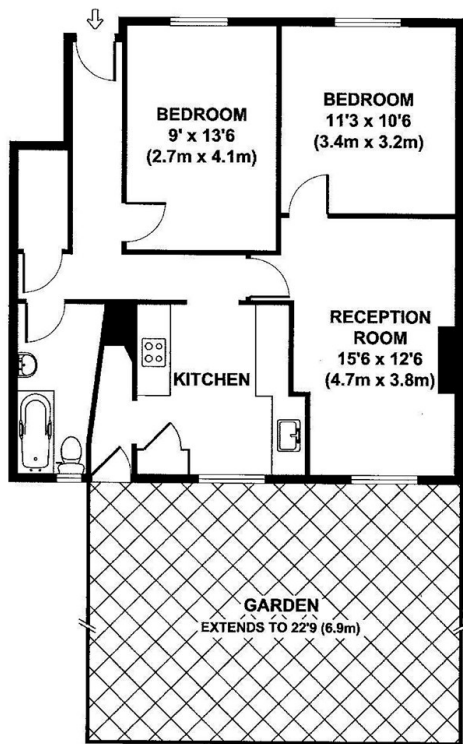

GROUND FLOOR  
GROSS INTERNAL  
FLOOR AREA 677 SQ FT

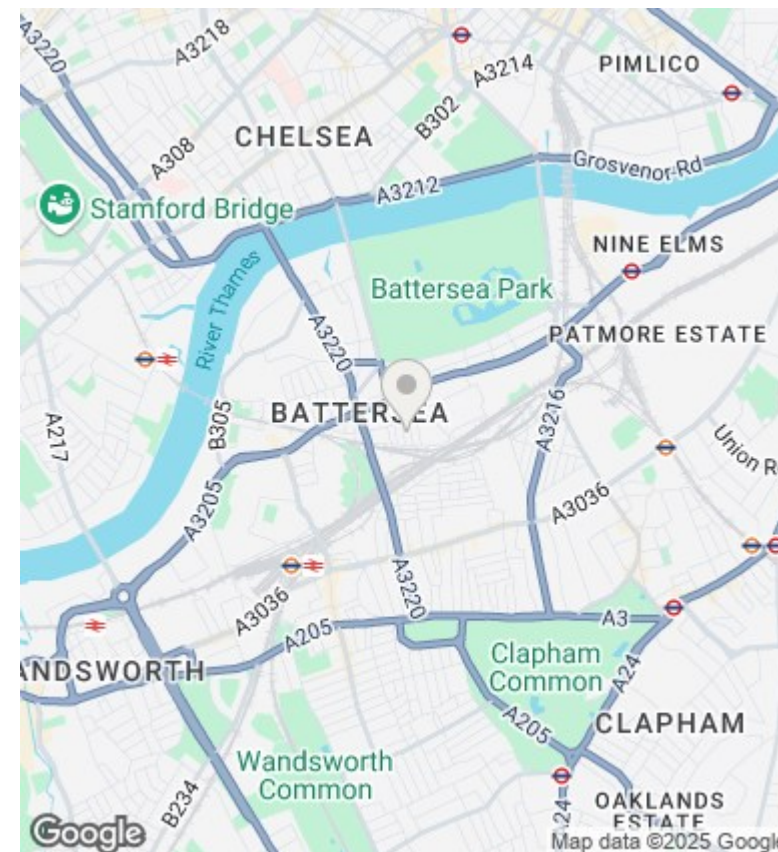

## Directions

## Viewings

Viewings by arrangement only. Call 020 7585 2761 to make an appointment.

## Council Tax Band

D

## EPC Rating:

D

Energy Efficiency Rating		Current	Potential
<i>Very energy efficient - lower running costs</i>			
(92 plus)	A		
(81-91)	B		
(69-80)	C		
(55-68)	D	65	
(39-54)	E		
(21-38)	F		
(1-20)	G		
<i>Not energy efficient - higher running costs</i>			
<b>England &amp; Wales</b>		EU Directive 2002/91/EC	