



## Coombe Road, London, W4 2HR

A recently renovated one bedroomed apartment situated in the ever-popular "Glebe Estate" area just a short walk from Chiswick High Road with its array of boutique shops and restaurants. Accommodation comprises: Living room, fitted galley style kitchen, double bedroom, double glazed sash style windows throughout, shower room and gas fired central heating. Local transport links include Turnham Green Tube Station, numerous local bus routes with convenient vehicular access via A4/M4 central London, Heathrow & The West. Council Tax: Hounslow Band D. The apartment is offered as furnished and available 18th February.

**£1,500 Per Calendar Month**

- Double Bedroom
- Recently Renovated
- Glebe Estate Location
- Close to the high road
- Great transport links
- Excellent location
- Hounslow Council Band D
- Furnished
- Available 18th February

# Coombe Road, W4

Approximate gross internal area

33.35 sq m / 359 sq ft

Key :  
CH - Ceiling Height

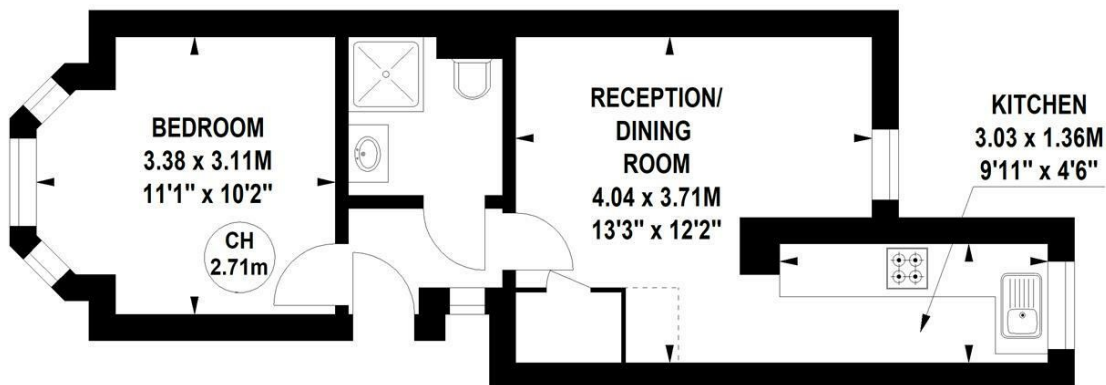

## Raised Ground Floor

Not to scale, for guidance only and must not be relied upon as a statement of fact.  
All measurements and areas are approximate only

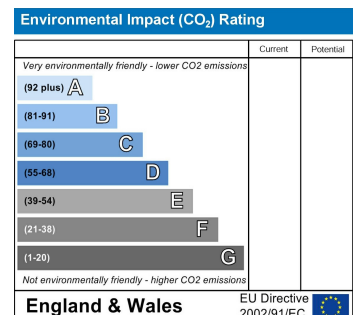
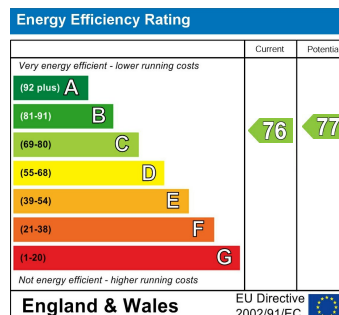

5-7 Turnham Green Terrace, Chiswick, London, W4 1RG

Tel 020 8747 8800

E-mail [lettings@whitmanandco.com](mailto:lettings@whitmanandco.com)

Website [www.whitmanandco.com](http://www.whitmanandco.com)

PrimeLocation.com

Zoopla.co.uk

rightmove

onTheMarket.com