

roundtree

real estate



Inkerman Road, Kentish Town, London

£885,000



2



1



N

Leasehold



BRITISH
PROPERTY
AWARDS

2022

★★★★★

GOLD WINNER

ESTATE AGENT
IN NW4



BRITISH
PROPERTY
AWARDS

2022 - 2023

★★★★★

GOLD WINNER

LETTING AGENT
IN NW4

A fresh approach to your property journey...

An outstanding two double bedroom duplex apartment, situated over the first and second floors, located within this stunning Edwardian Conversion with direct access to a good size private rear garden



- Two Double Bedrooms
- Spacious living room
- Large Kitchen/Breakfast room
- Beautiful High Ceilings Throughout
- Private Rear Garden
- Walking distance of Kentish Town Tube station
- Duplex apartment
- Approximately 942 SQ FT of Living Space
- Closer to Shops and Eateries
- Finished to a High Standard





The apartment offers very spacious accommodation with 942 SQ FT of living space, Huge ceiling height and is finished to a very high standard. Situated within the highly sought-after Inkerman Conservation Area, Inkerman Road is a very popular residential location, with this particular property being at the southern end close to the Victorian Swimming Baths and is moments from Kentish Town Road which has an array of shops and eateries and is within easy access of various rail stations including Kentish Town, Camden Town, Chalk Farm and Tufnell Park underground stations and Kentish Town, Kentish Town West and Gospel Oak overground stations.



FLOOR PLAN

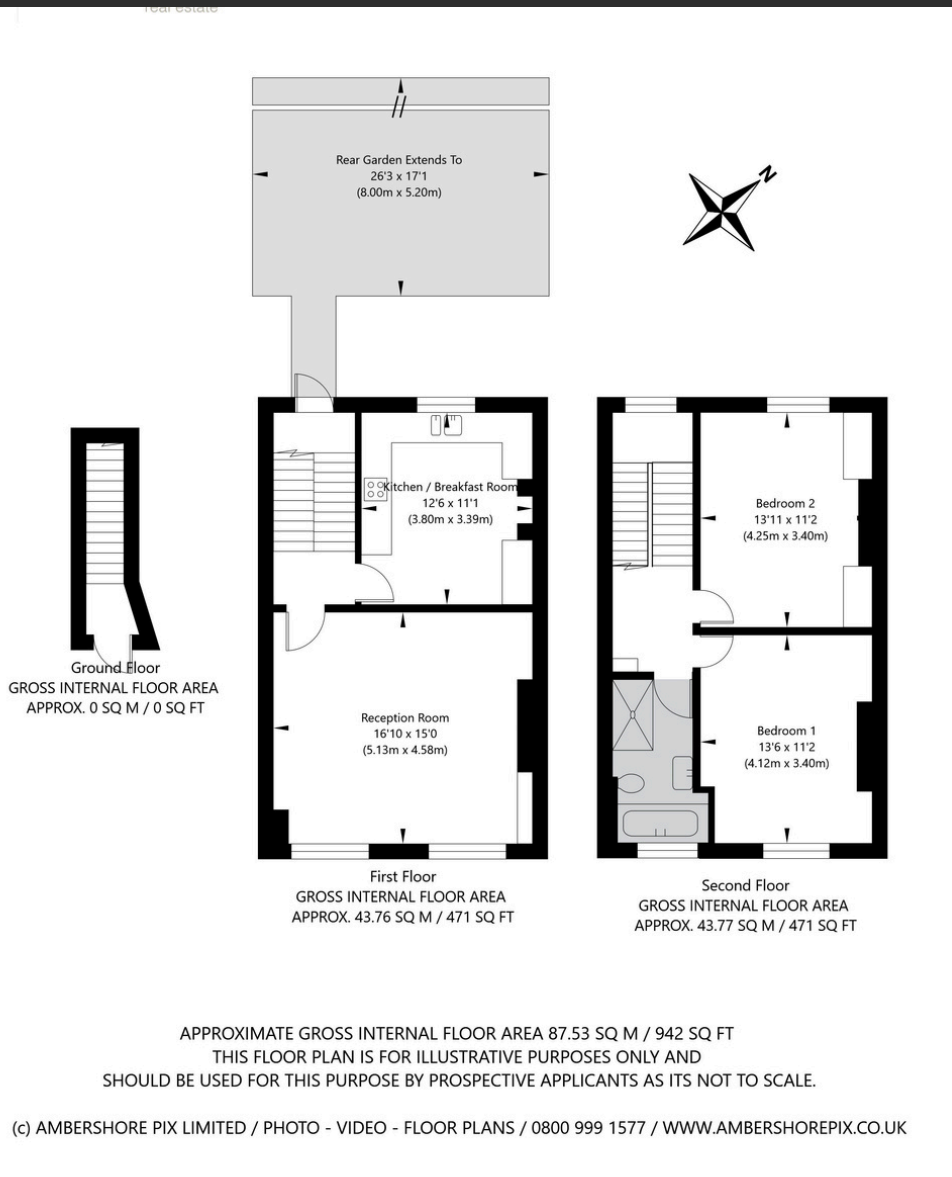

EPC

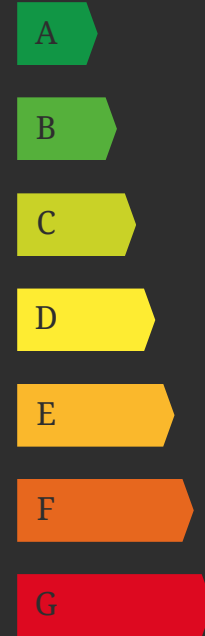

E

1 Sentinel Square, Brent Street
Hendon, NW4 2EL

020 8203 21111

mail@theroundtree.com

theroundtree.com

Selling your home?

If you are considering selling your home please contact us today for your no obligation free market appraisal.

Our dedicated and friendly team will assist you.

Get in touch today!



General: While we endeavor to make our sales particulars fair, accurate and reliable, they are only a general guide to the property and, accordingly, if there is any point which is of particular importance to you, please contact the office and we will be pleased to check the position for you, especially if you are contemplating travelling some distance to view the property. Measurements: These approximate room sizes are only intended as general guidance. You must verify the dimensions carefully before ordering carpets or any built-in furniture. Services: Please note we have not tested the services or any of the equipment or appliances in this property, accordingly we strongly advise prospective buyers to commission their own survey or service reports before finalizing their offer to purchase. THESE PARTICULARS ARE ISSUED IN GOOD FAITH BUT DO NOT CONSTITUTE REPRESENTATIONS OF FACT OR FORM PART OF ANY OFFER OR CONTRACT. THE MATTERS REFERRED TO IN THESE PARTICULARS SHOULD BE INDEPENDENTLY VERIFIED BY PROSPECTIVE BUYERS OR TENANTS. NEITHER ROUNDTREE NOR ANY OF ITS EMPLOYEES OR AGENTS HAS ANY AUTHORITY TO MAKE OR GIVE ANY REPRESENTATION OR WARRANTY WHATSOEVER IN RELATION TO THIS PROPERTY.

A fresh approach to your property journey...