

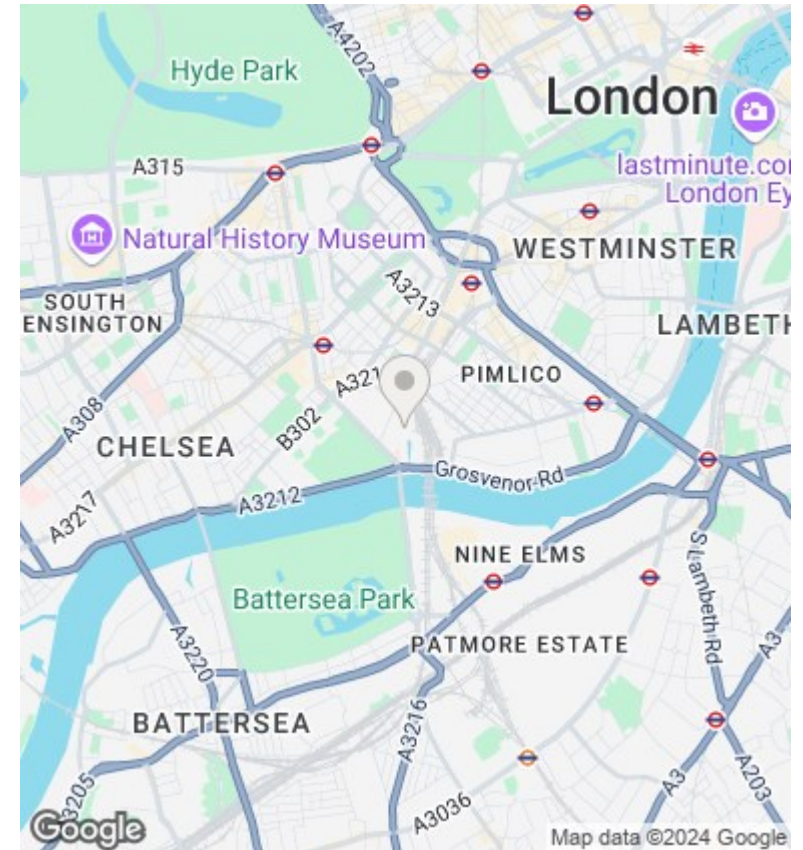

## Caro Point, Gatliff Road, Grosvenor Waterside, Sloane Square SW1W 8BD

£1,200,000

- 24/7 concierge
- underground parking
- private balcony
- minutes away from Battersea Park
- gym and spa
- air cooling
- on site nursery Purple Dragon
- west facing
- under floor heating
- minutes away from Sloane Square and Victoria stations

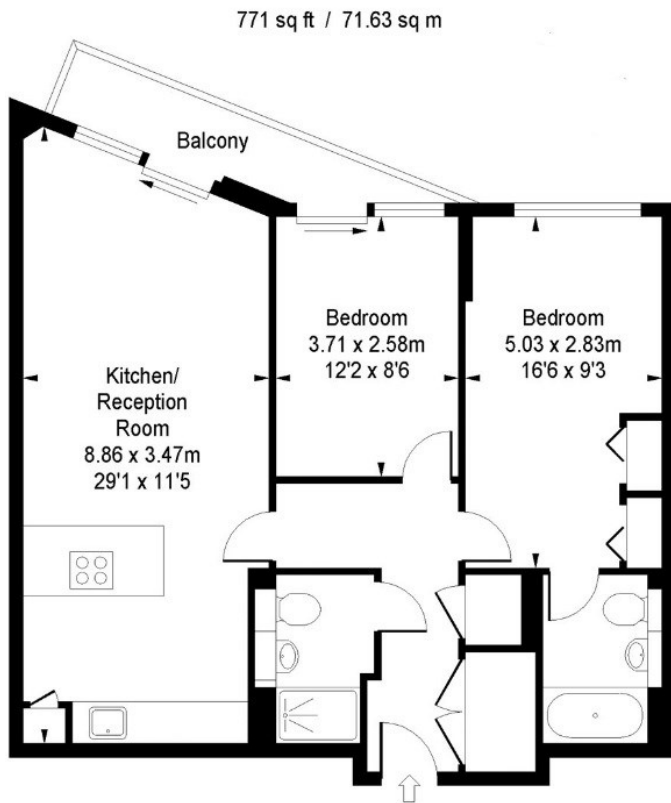

## Viewings

Viewings by arrangement only.  
Call 02077225022 to make an appointment.

## Council Tax Band

E

## EPC Rating:

Energy Efficiency Rating		
	Current	Potential
<i>Very energy efficient - lower running costs</i>		
(92 plus) <b>A</b>		
(81-91) <b>B</b>		
(69-80) <b>C</b>		
(55-68) <b>D</b>		
(39-54) <b>E</b>		
(21-38) <b>F</b>		
(1-20) <b>G</b>		
<i>Not energy efficient - higher running costs</i>		
<b>England &amp; Wales</b>	EU Directive 2002/91/EC	