

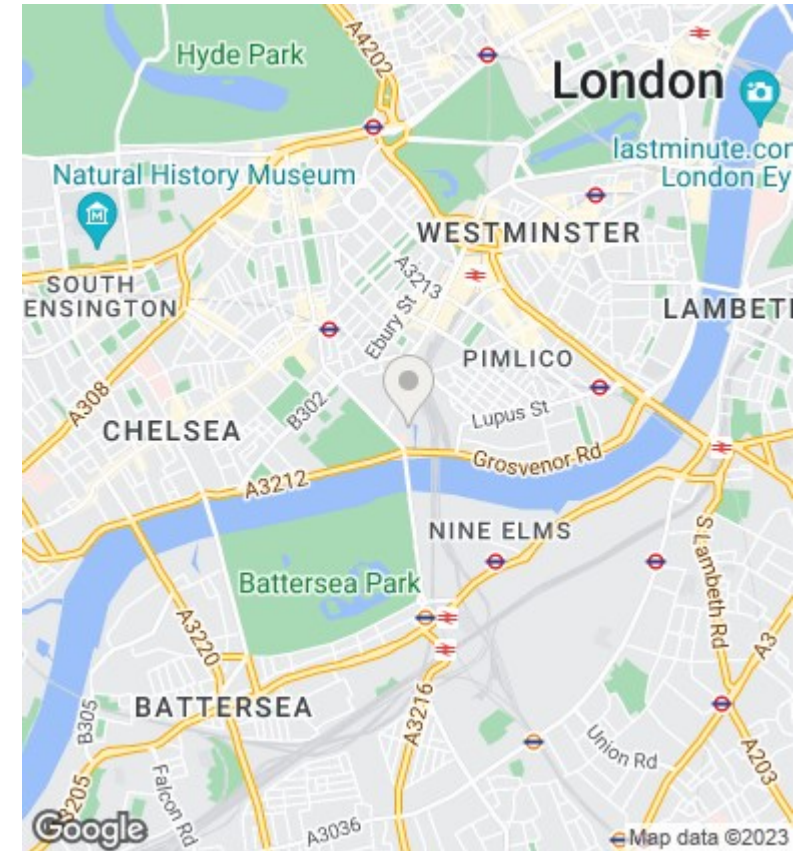

Hirst Court, Grosvenor Waterside, Gatliff Road SW1W 8QD

£2,700

- 24 hour concierge
- 2 bathrooms
- Onsite restaurant and food shop
- Gym and Spa located in the development
- Video viewing available
- Wooden floors throughout
- Walking distance to Sloane Square and Victoria
- Underfloor heating and air cooling
- Moments away from Battersea Park
- 617 sq foot

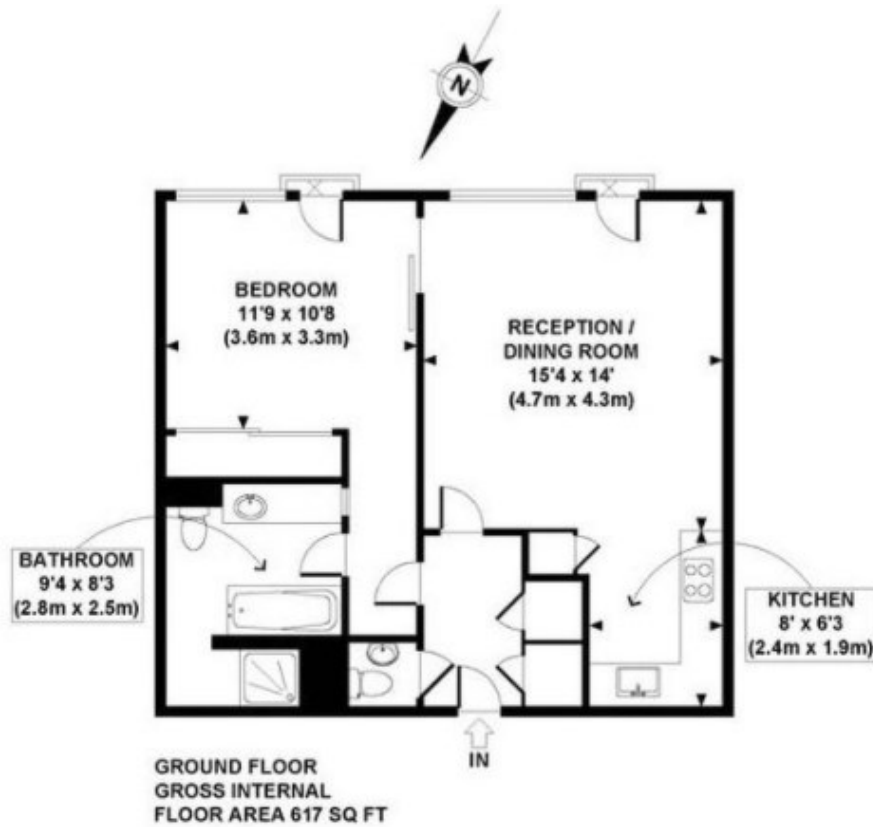

Viewings

Viewings by arrangement only.
Call 02077225022 to make an appointment.

Council Tax Band

E

EPC Rating:

| Energy Efficiency Rating | | |
|---|----------------------------|-----------|
| | Current | Potential |
| Very energy efficient - lower running costs | | |
| (92 plus) A | | |
| (81-91) B | | |
| (69-80) C | | |
| (55-68) D | | |
| (39-54) E | | |
| (21-38) F | | |
| (1-20) G | | |
| Not energy efficient - higher running costs | | |
| England & Wales | EU Directive 2002/91/EC | |