

# C JAMES & CO - TOOTING

SALES AND LETTINGS SPECIALISTS



**106-108 Tooting High Street, Tooting, SW17 0RR**

**£1,900**

Nestled in the heart of Tooting High Street, this well-presented flat offers a delightful blend of comfort and convenience. Boasting two spacious double bedrooms, this property is perfect for professionals, couples, or small families seeking a vibrant urban lifestyle.

The flat features a welcoming reception room, ideal for relaxation or entertaining guests. The bathroom is thoughtfully designed, complete with a separate shower cubicle, ensuring both practicality and comfort.

Its super central location means you will have easy access to a variety of shops, restaurants, and local amenities, making everyday life a breeze.

With its appealing features and prime location, this flat is an excellent opportunity for those looking to enjoy the lively atmosphere of Tooting. Don't miss the chance to view this charming property.



# Floor Plan

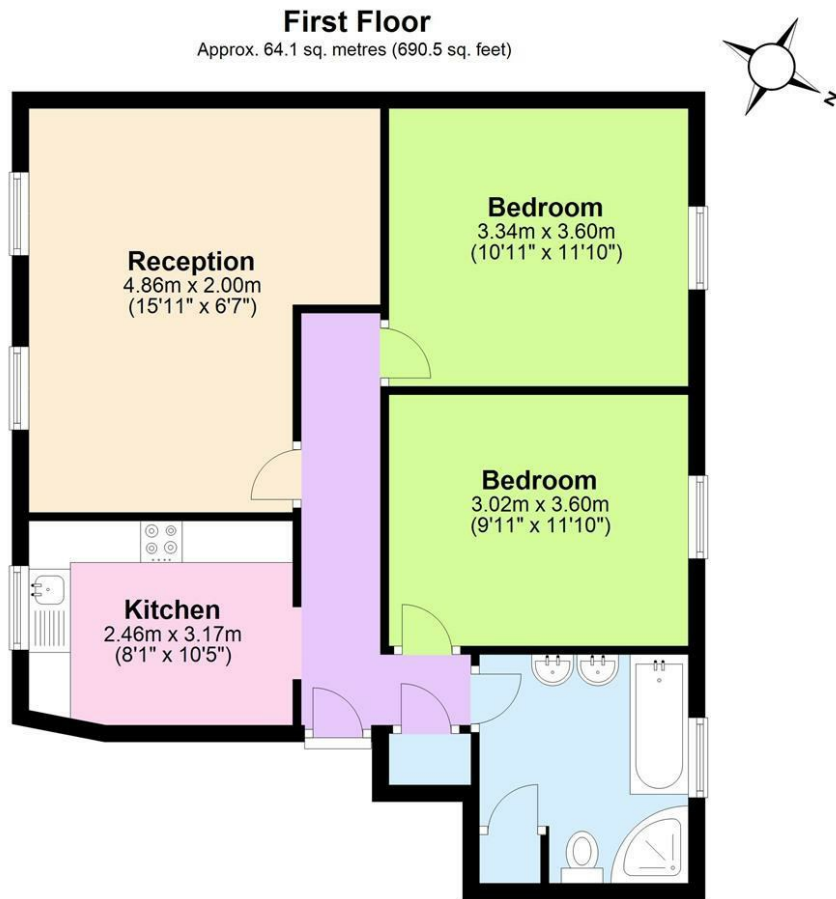

Total area: approx. 64.1 sq. metres (690.5 sq. feet)

Whilst every attempt has been made to ensure the accuracy of the floorplan contained here, measurements of doors, windows, rooms and any other items are approximate and no responsibility is taken for any error, omission or mis-statement. This plan is for illustrative purposes only.  
Plan produced using PlanUp.

# Area Map

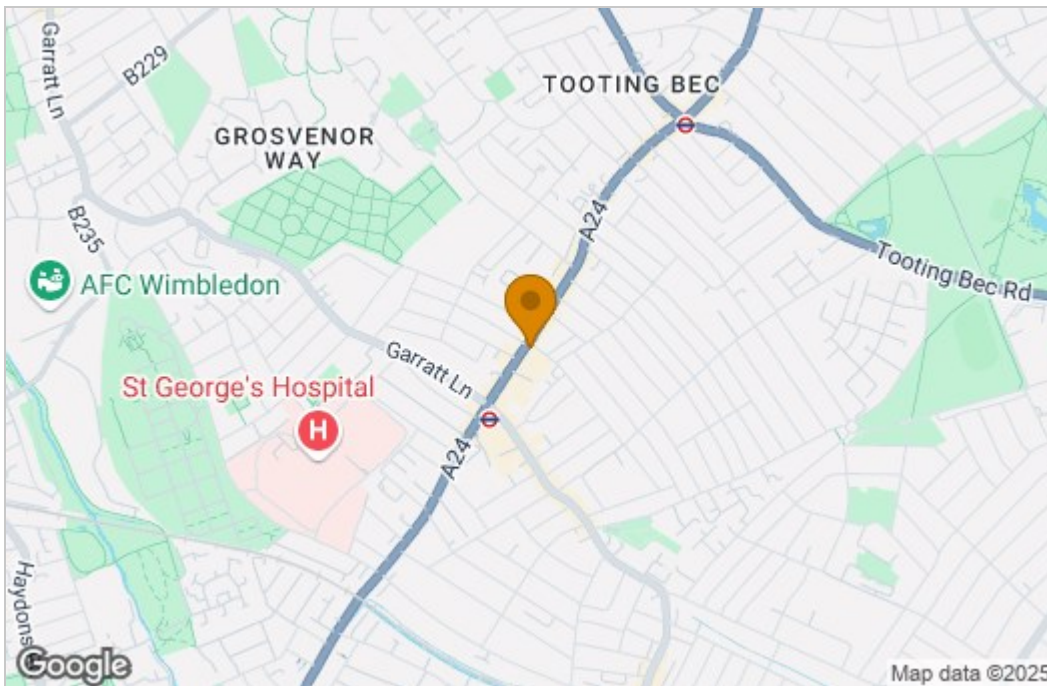

# Energy Efficiency Graph

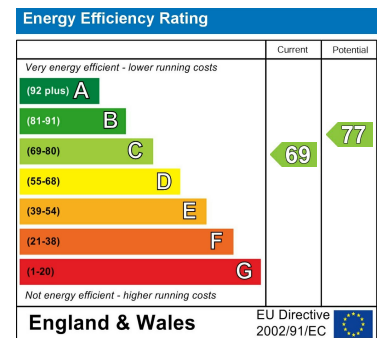

These particulars, whilst believed to be accurate are set out as a general outline only for guidance and do not constitute any part of an offer or contract. Intending purchasers should not rely on them as statements of representation of fact, but must satisfy themselves by inspection or otherwise as to their accuracy. No person in this firm's employment has the authority to make or give any representation or warranty in respect of the property.