



## Basterfield House, Golden Lane Estate, London, EC1Y 0TR

**£2,275 Per Month**

- Two Bed Duplex
- New Style Bathroom
- Available Now
- Grade II Listed Estate
- Balcony
- New Style Kitchen
- Furnished

# Basterfield House, Golden Lane Estate, London, EC1Y 0TR

Gorgeous & Highly sought after two bedroom duplex apartment located on the top two floors (fourth & fifth) of this Grade II Listed block, which has the advantage of various skylight windows & offers stylish contemporary living with a new style kitchen & bathroom.

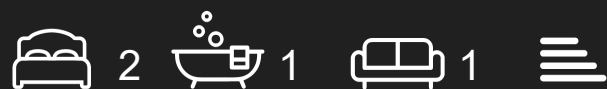

Council Tax Band:







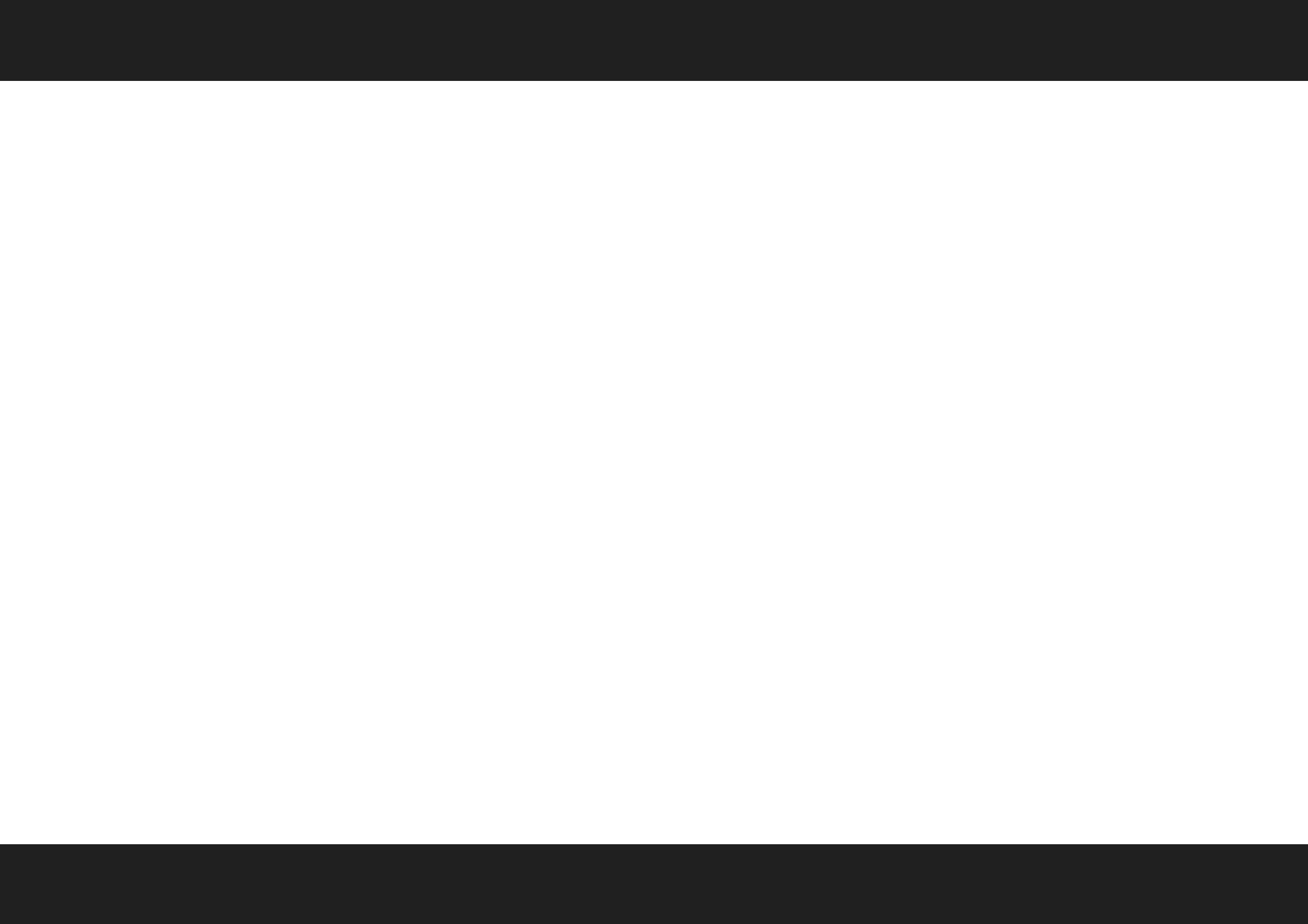

## Basterfield House

APPROX. GROSS INTERNAL FLOOR AREA 679 SQ FT / 63 SQ METRES

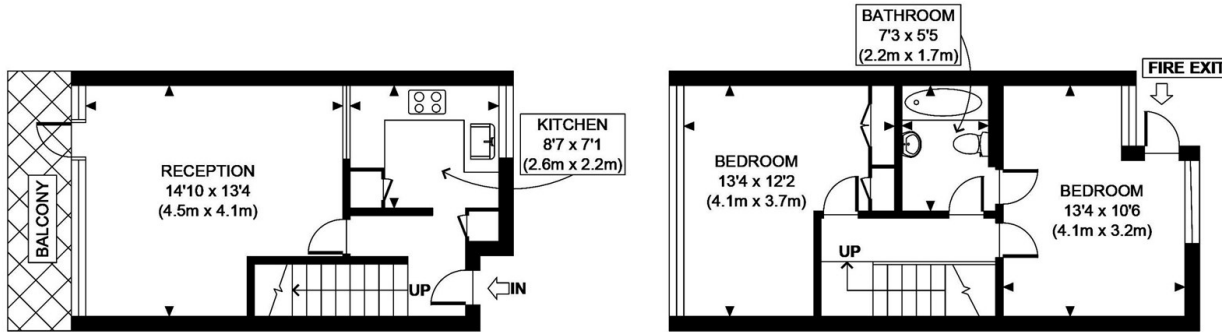

FOURTH FLOOR

FIFTH FLOOR

Whilst every attempt has been made to ensure the accuracy of the floor plan contained here, measurements of doors, windows and rooms are approximate and no responsibility is taken for any error, omission, or mis-statement. These plans are for representation purposes only as defined by RICS code of measuring practice and should be used as such by any prospective purchaser. Specially no guarantee is given on the total square footage of the property if quoted on this plan. Any figure given is for initial guidance only and should not be relied on as a basis of valuation.

Copyright Heywood Beacon Photography. Produced for Hamilton Brooks. Ref - 081

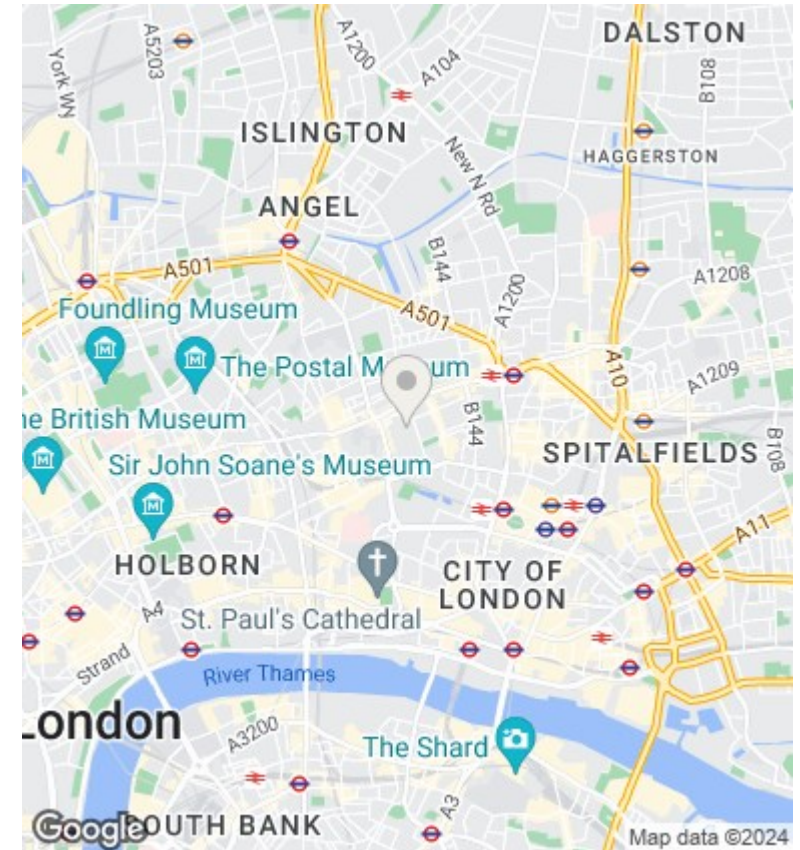

## Directions

## Viewings

Viewings by arrangement only. Call 020 7606 8000 to make an appointment.

## Council Tax Band

Energy Efficiency Rating		
	Current	Potential
<i>Very energy efficient - lower running costs</i>		
(92 plus) <b>A</b>		
(81-91) <b>B</b>		
(69-80) <b>C</b>		
(55-68) <b>D</b>		
(39-54) <b>E</b>		
(21-38) <b>F</b>		
(1-20) <b>G</b>		
<i>Not energy efficient - higher running costs</i>		
<b>England &amp; Wales</b>	EU Directive 2002/91/EC	