

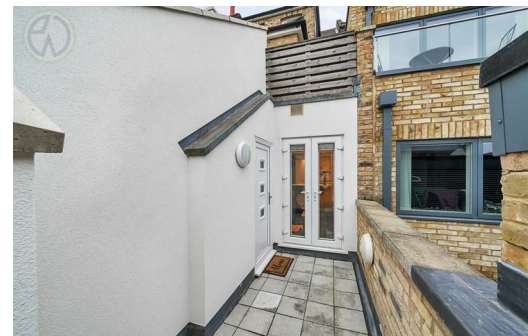

The Broadway, Wimbledon

Guide Price £499,999 Leasehold

Spacious Centrally Located Apartment - Two Bedrooms - 2 Bathrooms
Large Open Plan Living Room/Diner/Kitchen - Fully Fitted Kitchen
Private terrace - Lease Term 125 years - Well Presented - EPC C
1st Floor - No Chain - Period Conversion - 3 Minutes to Station



The Broadway, Wimbledon

Broadway Court, The Broadway, London, SW19



Approximate Area = 818 sq ft / 76 sq m
 Limited Use Area(s) = 13 sq ft / 1.2 sq m
 Total = 831 sq ft / 77.2 sq m
 For identification only - Not to scale

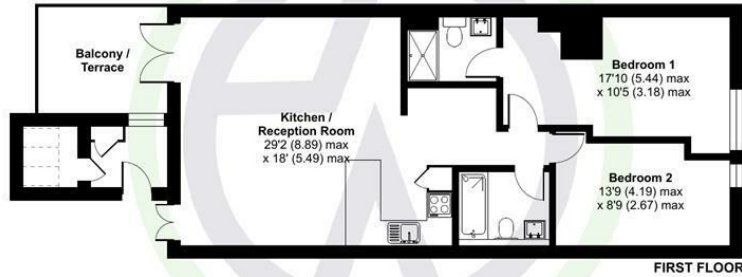

Floor plan produced in accordance with RICS Property Measurement 2nd Edition, Incorporating International Property Measurement Standards (IPMS2 Residential). © richcom 2024. Produced for Eddison White. REF: 1220198



London Borough of Merton
 Tax Band D
 Leasehold

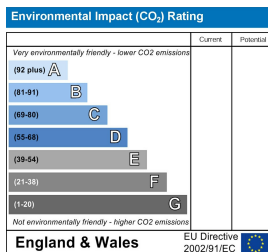
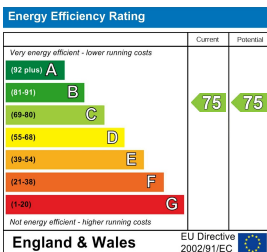

These details and any pictures or plans represent our opinion and are given in good faith for guidance only. They must not be construed as statements or fact. These particulars do not constitute part of an offer or contract. We have not tested the services, appliances or specified fittings and would highly recommend a purchaser to carry out their own survey on the property.



company registration no. 05068639 • vat registration no. 843560623

