



Whitley
Parish



Rose Lane Close, Palgrave, Diss

Guide Price £275,000

3 1 2



Found upon a small no through close, consisting of similar attractive houses, the property enjoys a pleasing position set upon a large plot. The traditional village of Palgrave is found just one and a half miles to the south of Diss within the beautiful countryside surrounding the Waveney Valley. The village still retains a strong and active local community most centred around a large unspoilt village green having a beautiful assortment of many period properties. The historic market town of Diss is within walking distance and offers an extensive and diverse range of many day to day amenities and facilities along with having the benefit of a mainline railway station with regular/direct services to London Liverpool Street and Norwich.

This charming property is a three bedroom semi detached house with a delightful and traditional 1950's design. Features attractive colour wash rendered elevations under a pitched clay peg tile roof, equipped with modern sealed unit upvc double glazed windows and doors and is heated by a gas fired combination boiler via radiators. (installed some 2 or so years ago).

The property is set back from the road within a small close sitting upon a spacious corner plot position and having extensive off-road parking to the front for a number of vehicles upon a shingle driveway. The main gardens lie to the rear and are of a generous size being predominantly laid to lawn and a good deal of privacy/ seclusion within and taking a south westerly aspect.

SERVICES:

- Drainage - Mains
- Heating type - Gas
- EPC rating - D
- Council Tax Band - B
- Tenure - Freehold



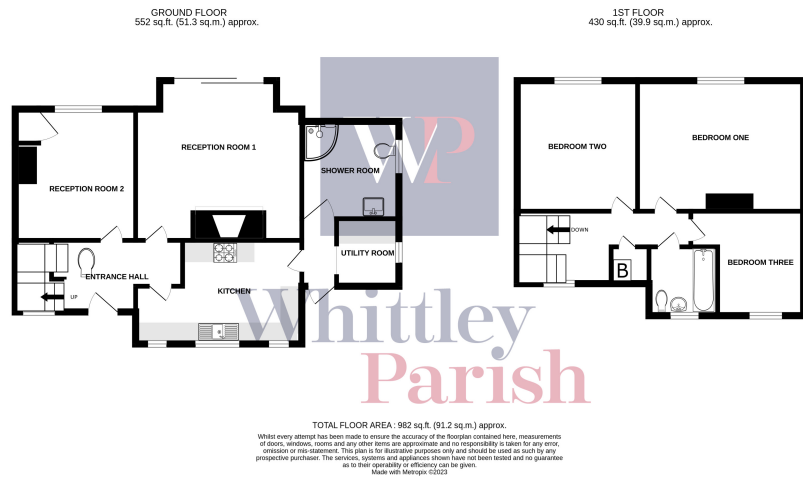

- South westerly facing gardens
- 2 Bathrooms 2 Reception rooms
- Corner plot position
- Council Tax Band B
- 982 sq ft
- Workshop
- Hartismere School catchment
- Freehold



Score	Energy rating	Current	Potential
92+	A		
81-91	B		84 B
69-80	C		
55-68	D	66 D	
39-54	E		
21-38	F		
1-20	G		