

St. Peters Avenue, Claydon, Ipswich, Suffolk, IP6 0HY **Offers In Excess Of: £230,000**



- No Onward Chain
- Semi-Detached Bungalow
- Two Bedrooms
- Living Room & Study
- Conservatory
- Good Size Rear Garden
- Communal Car Park
- Some Updating Required

This two bedroom semi-detached bungalow tucked away at the end of a cul-de-sac in the popular village of Claydon and offering good access out to the A14 commuter trunk road is being sold with no onward chain. The property would benefit from some updating and comes with a good size rear garden with brick-built storage, and there is a communal car park to the side. The accommodation comprises entrance hall, living room, kitchen / breakfast room, conservatory, bathroom, two bedrooms, and study.

Claydon is a popular village just North of Ipswich and offers two public houses, Post Office, church, hairdressers, travel agency, primary school and Claydon High School. There are regular bus connections to Ipswich, Bramford and Stowmarket from the centre of the village and good access to the A14 and A12 trunk roads. Adjoining the village of Claydon is the desirable village of Barham which is on the River Gipping approximately six miles North of Ipswich with its direct rail links to London Liverpool Street Station. Barham provides convenient access to the A14 commuter road link and is surrounded by the villages of Great Blakenham, Claydon and Henley. Barham has one pub, The Sorrel Horse and Barham is also known for the Gaps Fishing lakes. The Barham Picnic site is in the heart of the Gipping Valley and consists of a children's play area, car park, purpose-built toilets facilities and a visitors centre.



Council Tax Band: B

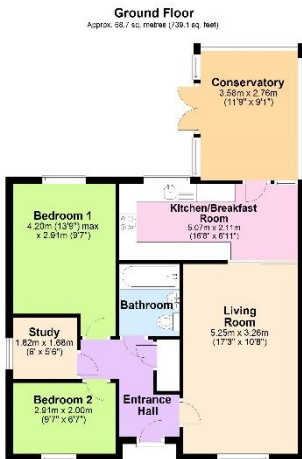

Total area: approx. 68.7 sq. metres (739.1 sq. feet)
Although every effort has been made to ensure the accuracy of this floor plan measurements of doors, windows, stairs and other items are approximate and no responsibility is taken for any error, omission or mis-statement. This plan is for illustrative purposes only.
Plan produced using PlotUp



Disclaimer

Every attempt has been made to ensure accuracy, however these property particulars are approximate and for illustrative purposes only. They have been prepared in good faith and they are not intended to constitute part of an offer of contract. We have not carried out a structural survey and the services, appliances and specific fittings have not been tested. All photographs, measurements, floor plans and distances referred to are given as a guide only and should not be relied upon for the purchase of any fixture or fittings. Lease details, service charges and ground rent (where applicable) are given as a guide only and should be checked prior to agreeing a sale.