



Northwood Hall, Hornsey Lane, Highgate, N6

Weekly Rental Of £346



44 highgate high street, highgate village, london, n6 5hx
telephone 020 8348 8000 facsimile 020 8348 8232
email highgate@litchfields.com litchfields.com
offices also in hampstead garden suburb & crouch end

We are pleased to offer this super 2 bedroom top floor flat (with lifts) in this landmark Art Deco purpose built block. This very bright south facing apartment features a sunny reception room with balcony and superb far reaching City views. With two bedrooms, bathroom and separate kitchen further benefits include ample off street parking, communal gardens and portorage. Northwood Hall is very conveniently located for fast access to Central London and the City, with all the amenities of both historic Highgate Village and bustling Crouch End Broadway on the doorstep with the green open spaces of the Parkland Walk, Highgate and Queen's woods and Waterlow Park on the doorstep. Unfurnished - Available Immediately.



Northwood Hall

Approximate Gross Internal Area = 607 sq ft / 56.4 sq m

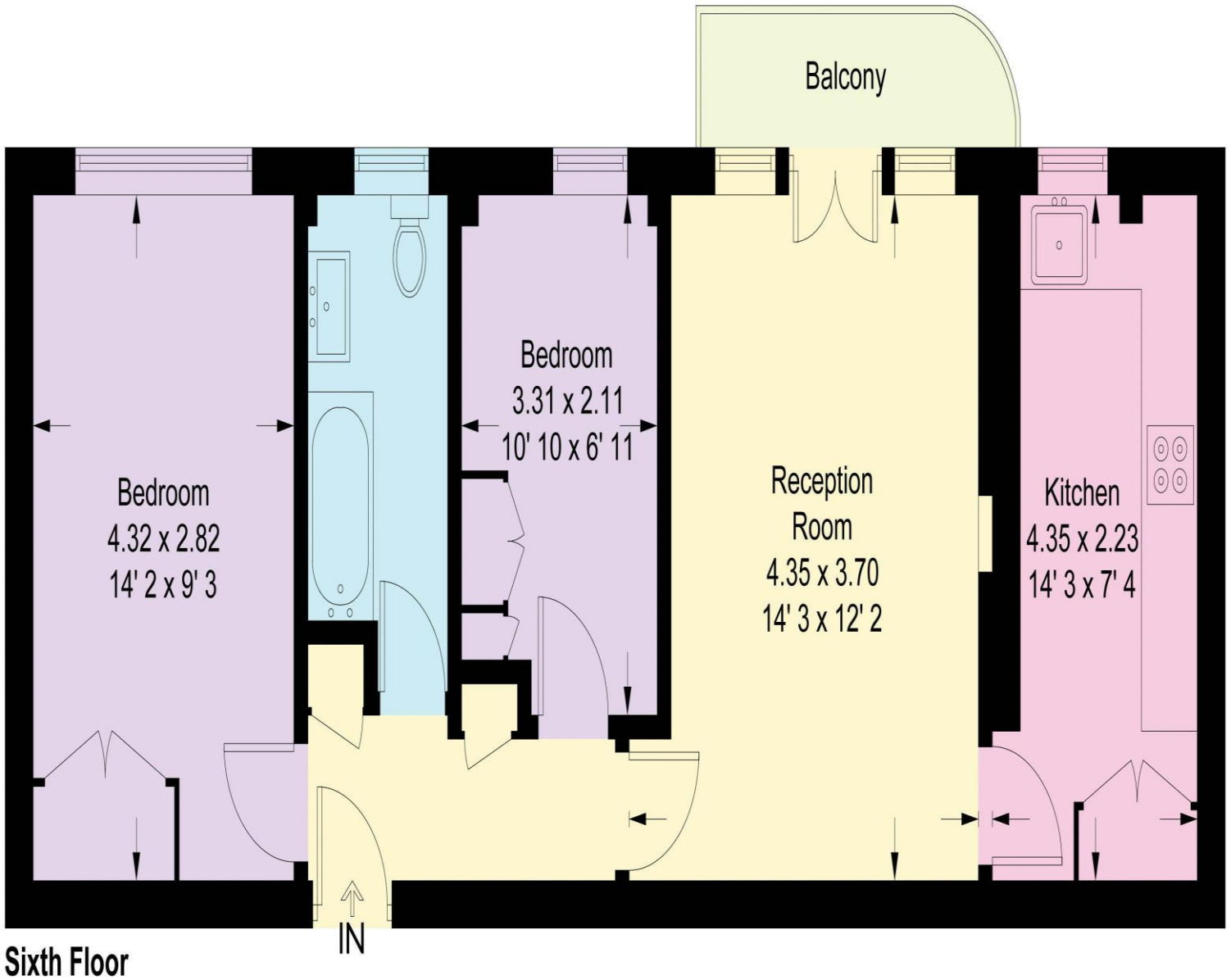

Not to scale, for guidance only and must not be relied upon as a statement of fact
All measurements and areas are approximate only and have been prepared in
accordance with the current edition of the RICS Code of Measuring Practice