

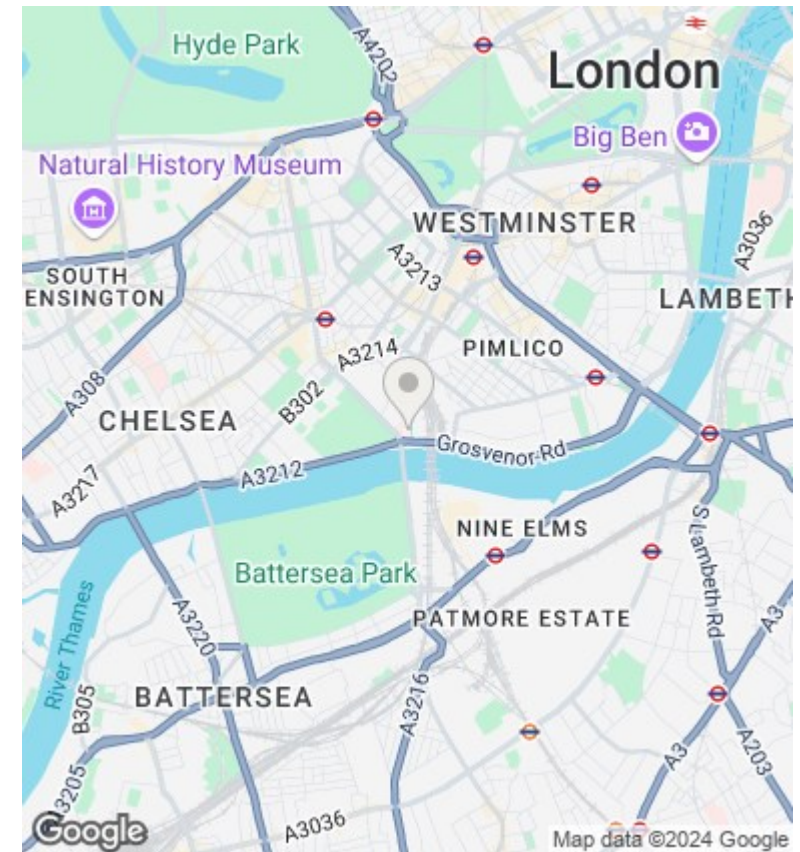

Hirst Court , Grosvenor Waterside , Gatliff Road, Sloane Square SW1W 8QD

£985,000

- 24 Hour concierge
- underfloor heating and air cooling
- moments away from Victoria and Sloane Square stations
- video viewing available
- west facing
- walking distance to Battersea Park
- gym and spa
- onsite restaurant and Sainsbury's

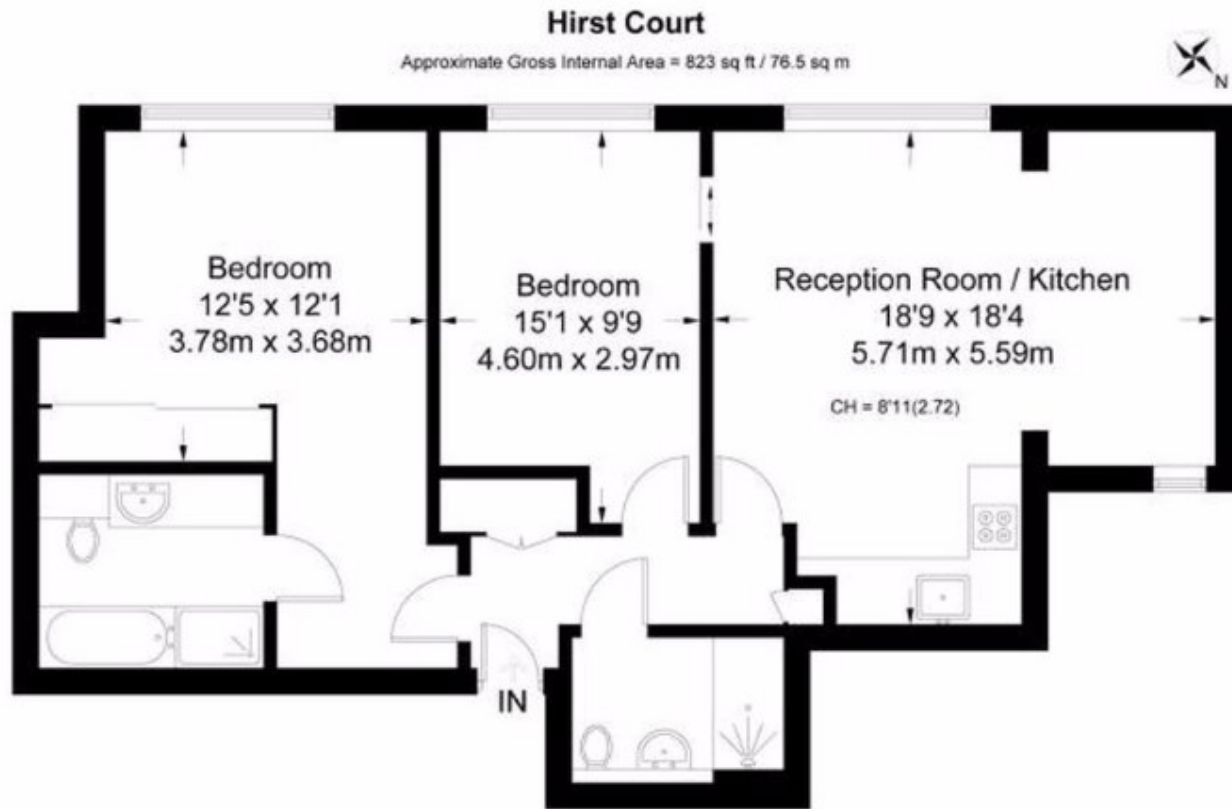

Viewings

Viewings by arrangement only.
Call 02077225022 to make an appointment.

Council Tax Band

C

EPC Rating:

Energy Efficiency Rating		
	Current	Potential
<i>Very energy efficient - lower running costs</i>		
(92 plus) A		
(81-91) B		
(69-80) C		
(55-68) D		
(39-54) E		
(21-38) F		
(1-20) G		
<i>Not energy efficient - higher running costs</i>		
England & Wales	EU Directive 2002/91/EC	