



Palmer & Partners



Palmer & Partners

Woodlands, Chelmondiston, Suffolk, IP9 1DT

Asking Price: £325,000

Woodlands, Chelmondiston, Ipswich, Suffolk, IP9 1DT

This three bedroom detached bungalow, situated in the sought after village of Chelmondiston is being sold with no onward chain and benefits from off-road parking for two cars, garage, lovely south-facing rear garden, and double glazing. The accommodation comprises entrance hall, three double bedrooms, family bathroom, and dining room which opens through to the sitting room and the kitchen. The property would benefit from some internal updating.

Chelmondiston is a vibrant and pretty parish village bordering the River Orwell with areas of outstanding natural beauty and wonderful National Trust walks throughout Pin Mill and surrounding areas. The village offers a range of local amenities including Primary School, Post Office and shops, Chinese takeaway, gastro pub, equestrian centre, sailing club, tennis courts, and play park. The village offers lots of community activities (yoga, dance, drama, book groups, etc.) with Jimmy's Farm, Suffolk Food Hall, Alton Water, and Harkstead Beach all just a stone's throw away. Chelmondiston is located just a few miles from The Royal Hospital and Ipswich High Schools as well as the Royal Harwich Yacht Club and MDL marina. The nearest train station is Ipswich mainline station providing direct links to London Liverpool Street Station. Chelmondiston is an easy 15 minute commute to Ipswich and Manningtree, has good transport (bus) networks, and is a dog walker's heaven.

Council tax band: C
EPC Rating: TBC

Ground Floor

Approx. 92.5 sq. metres (995.9 sq. feet)

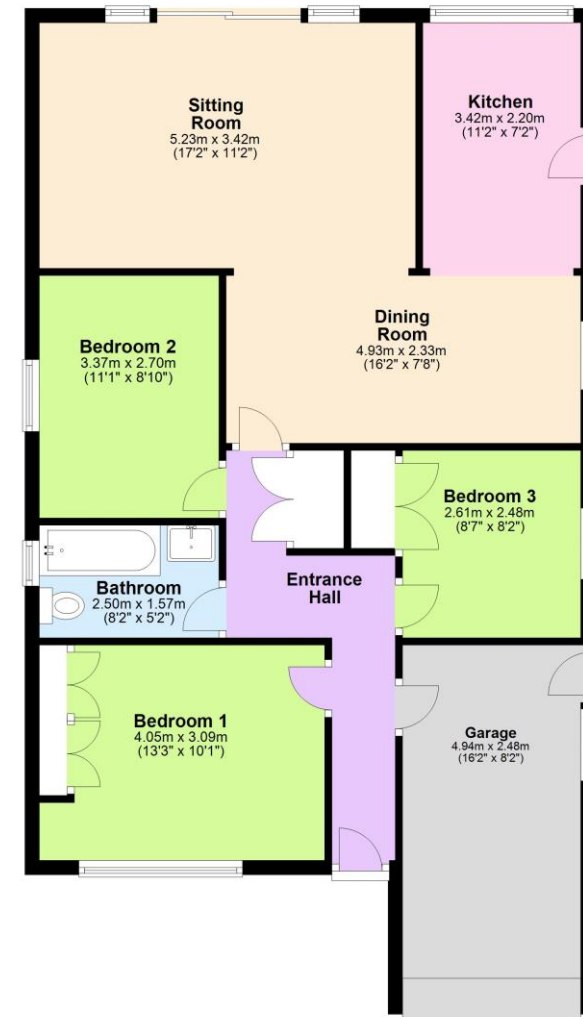

Total area: approx. 92.5 sq. metres (995.9 sq. feet)

Although every attempt has been made to ensure the accuracy of this floorplan measurements of doors, windows, rooms and any other items are approximate and no responsibility is taken for any error, omission or mis-statement. This plan is for illustrative purposes only.
Plan produced using PlanUp.



