

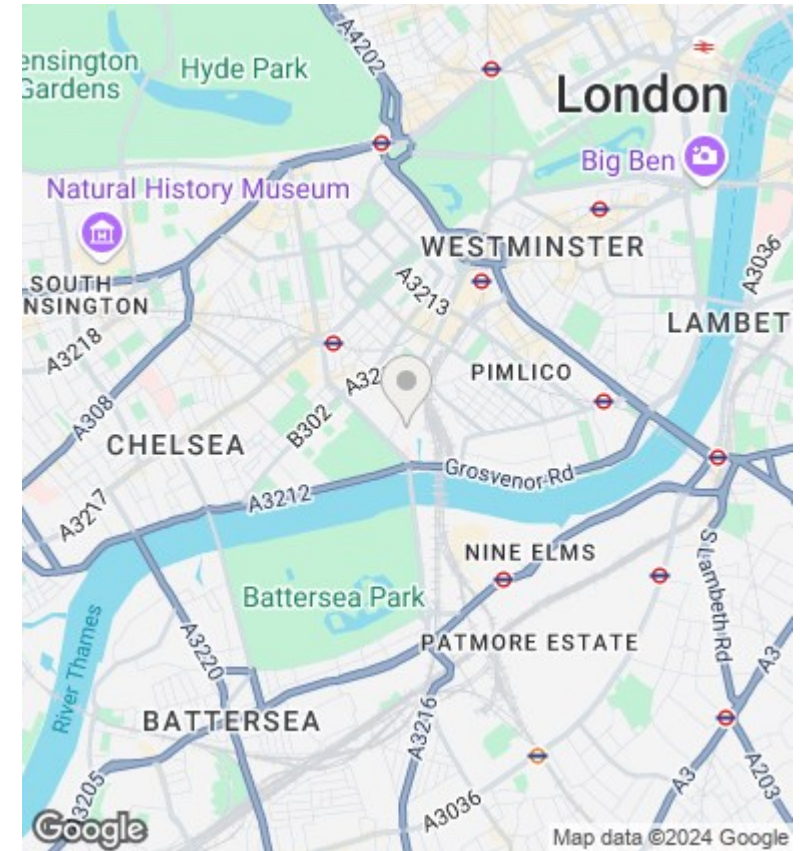

Hepworth Court, Grosvenor Waterside, Gatliff Road , Sloane Square SW1W 8QN

£1,700

- 24/7 concierge
- 3 double bedrooms
- underfloor heating
- on site restaurant and Sainsbury's
- gym and spa
- 3 bathrooms
- walking distance to Sloane Square and Victoria
- allocated parking space
- air cooling
- walking distance to Battersea Park

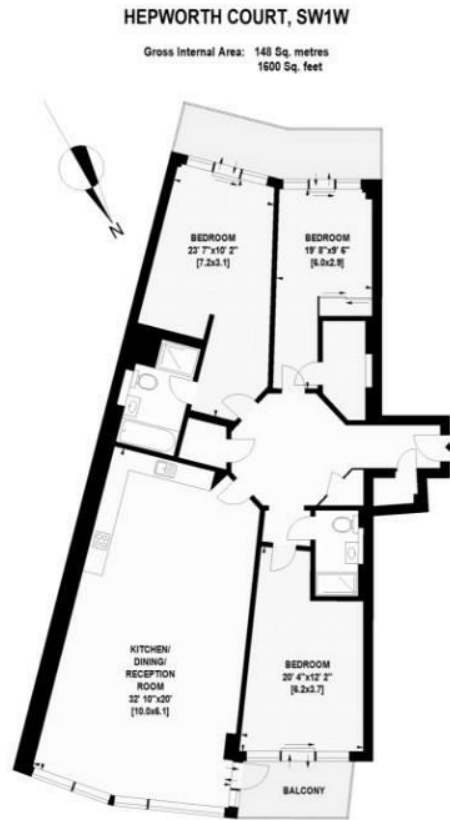

Viewings

Viewings by arrangement only.
Call 02077225022 to make an appointment.

Council Tax Band

EPC Rating:

Energy Efficiency Rating		
	Current	Potential
<i>Very energy efficient - lower running costs</i>		
(92 plus) A		
(81-91) B		
(69-80) C		
(55-68) D		
(39-54) E		
(21-38) F		
(1-20) G		
<i>Not energy efficient - higher running costs</i>		
England & Wales	EU Directive 2002/91/EC	