



Homefield Road, London, W4 2LN

Guide Price £2,250,000

**WHITMAN & CO.**

SALES · LETTINGS · COMMERCIAL



- Semi-detached period property
- Immense scope to redesign/extend
- Off street parking
- Chiswick's premier roads
- Generous rear garden
- No chain

Tenure - Freehold  
Local Authority - Hounslow  
Council Tax - Band G

## THE PROPERTY

Rare to the market, this very original three-storey semi-detached period family home ideally located in one of Chiswick's premier roads offering close proximity to all amenities. Currently arranged as a 5/6 bedroom and with immense scope to redesign/extend to suit personal needs subject to necessary planning permission. This impressive property benefits from a host of original features, generous rear garden and off street parking. Situated within close proximity of both Turnham Green and Stamford Brook stations as well as the extensive range of shops, bars and restaurants on Chiswick High Road. No chain.

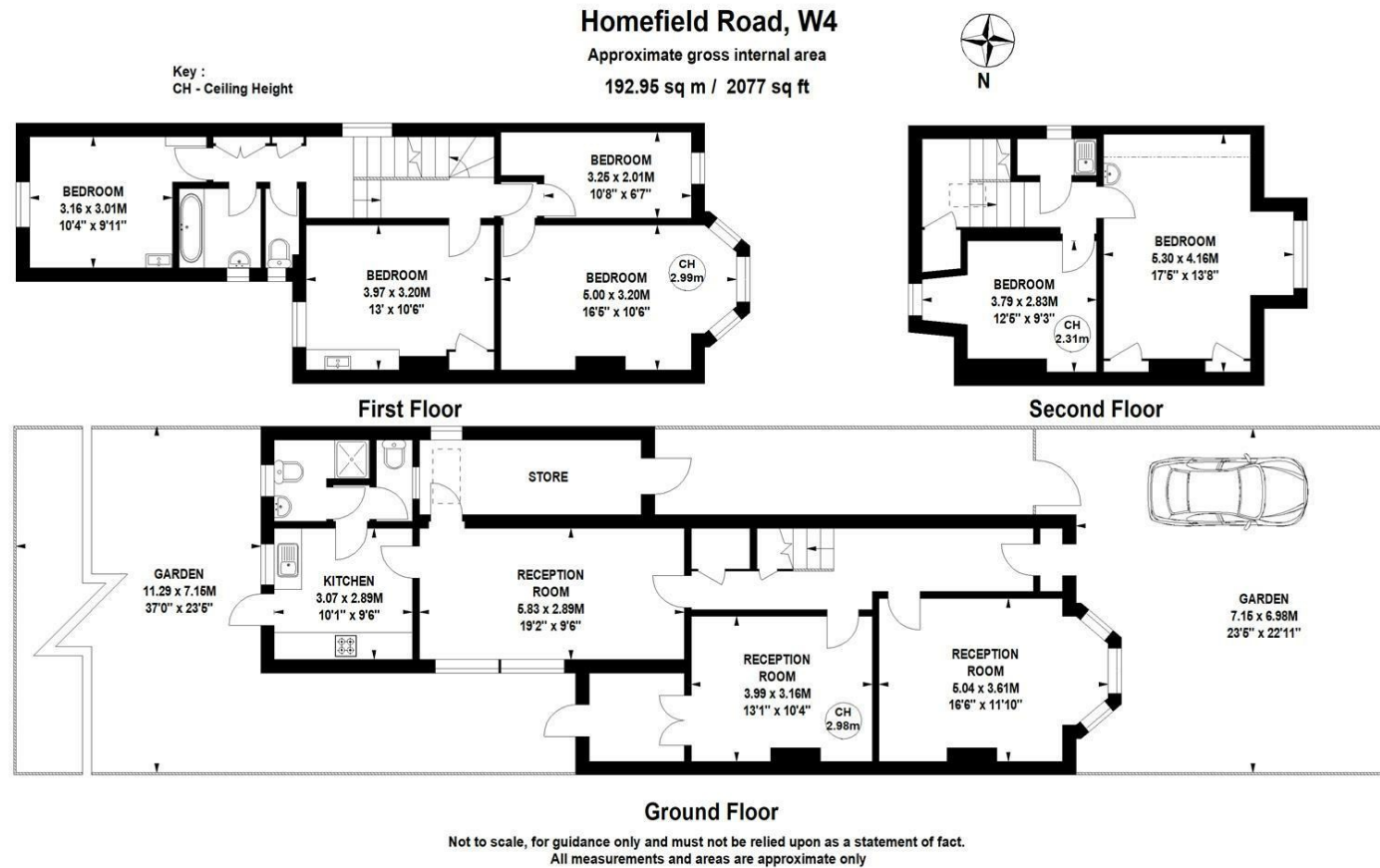

## SITUATION

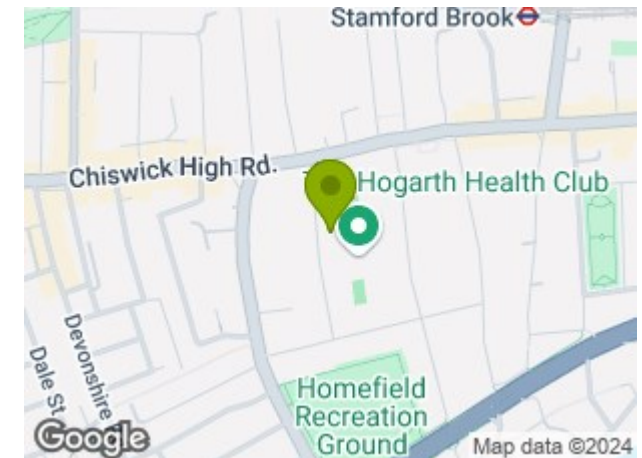

5-7 Turnham Green Terrace, Chiswick, London, W4 1RG

Tel 020 8747 8800

E-mail [sales@whitmanandco.com](mailto:sales@whitmanandco.com)

Website [www.whitmanandco.com](http://www.whitmanandco.com)