



Balcombe Street, London

£1,100,000

[Contact us about this property](#)

337 West End Lane, West Hampstead, London, NW6 1RS

E: nw6@alexanders-uk.com

T: 0207 431 0666

www.alexanders-uk.com

Alexanders

Property Consultants



About This Property

Refurbished to a high standard this superb apartment is located on one of Marylebone's most sought after residential roads. The property at approx 860sqft is situated in a period conversion and comprises a bright open plan fitted kitchen and reception room, 3 double bedrooms, 2 bathrooms and the property further benefits from a patio area.

The property is ideally located for the cosmopolitan shops and restaurants of Marylebone Village as well as the nearby green open spaces of Regent's Park.

The apartment is a 5 min walk to either Baker St or Marylebone stations providing access to the Jubilee, Bakerloo, Circle and Metropolitan lines.

Viewings highly recommended!

For further information or to book an appointment call on 020 74310666.



Alexanders

Property Consultants

 3 Bedroom |  1 Reception |  2 Bathroom |  null

Property Features

- 860 sq ft
- 3 bedrooms
- 2 bathrooms
- Open plan kitchen & reception
- Patio
- 5 mins walk to Regents Park
- 5 mins walk to Baker Street & Marylebone stations
- Share of Freehold

Property Size

860.00 sq ft

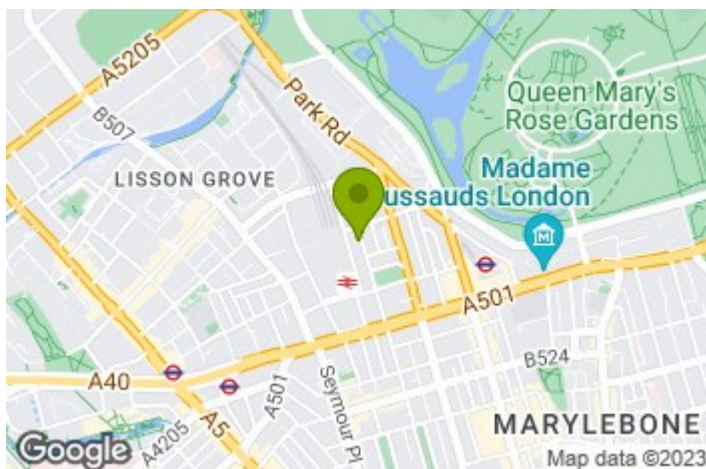

Alexanders

Property Consultants

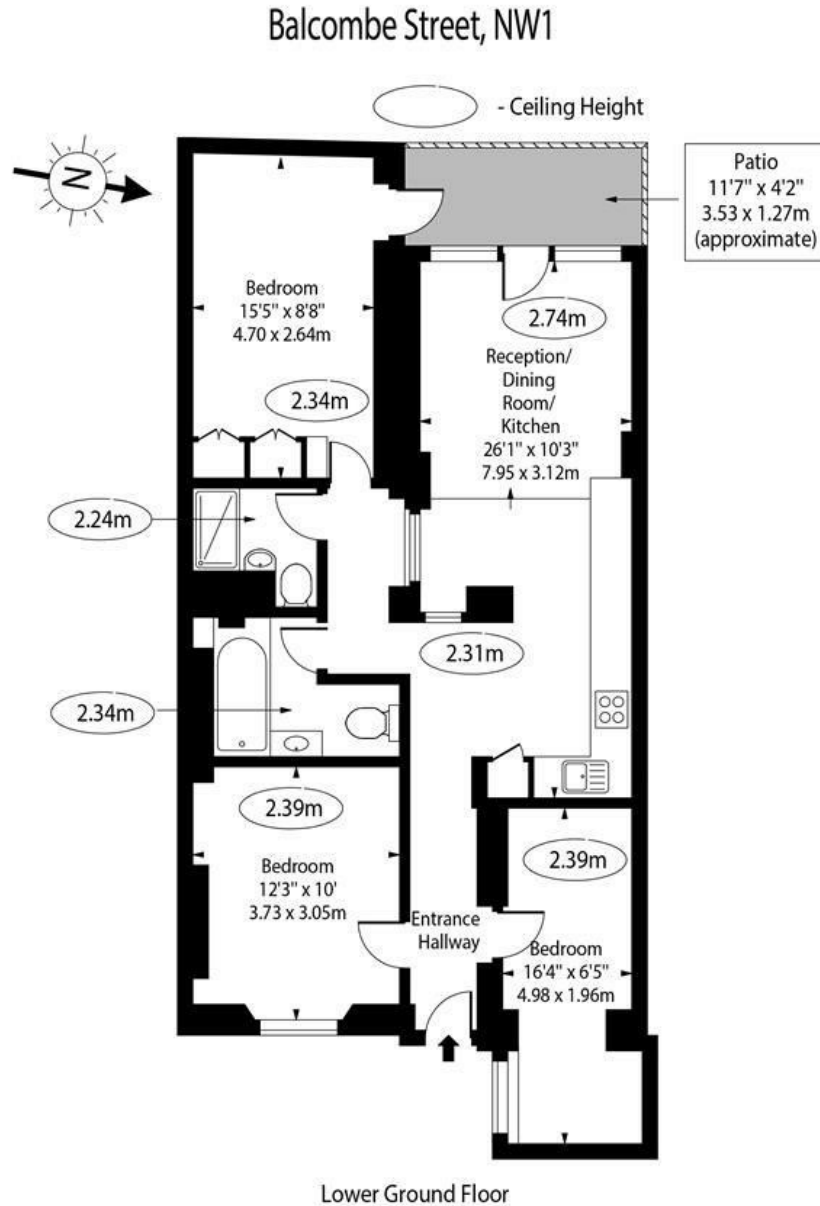

For Illustration Purposes Only - Not To Scale Floor Plan by www.nogaphotostudio.com Ref: No.46950

This floor plan should be used as a general outline for guidance only. Any intending purchaser or lessee should satisfy themselves by inspection, searches, enquiries and full survey as to the correctness of each statement. Any areas, measurements or distances quoted are approximate and should not be used to value a property or be the basis of any sale or let.

Contact us about this property

337 West End Lane, West Hampstead, London, NW6 1RS

E: nw6@alexanders-uk.com

T: 0207 431 0666

www.alexanders-uk.com

