

## Hillcross Avenue Morden, SM4 4AZ

£565,000 Freehold



**A spacious three bedroom end of terrace house with ground floor extension, and lovely views of Morden park to the rear. The property is ideally located for transport links including Morden Northernline tube and Thameslink train station. With parking, garage and great potential to update into your own ideal home.**

## HILLCROSS AVENUE, SM4

Approx. Gross Internal Floor Area  
**965 Sq. ft/89.64 Sq. m (Excluding Garage)**  
 Garage: 152 Sq. ft/14.1 Sq. m

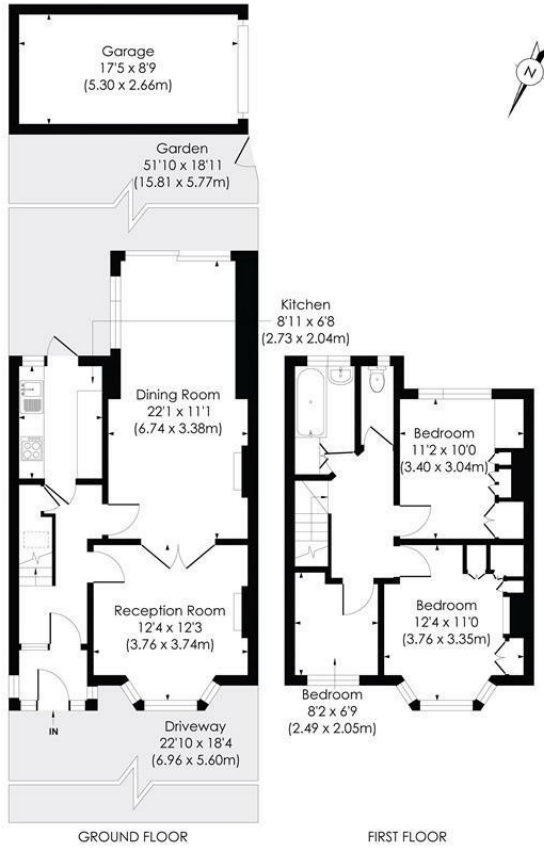

**pixangle** PROPERTY MARKETING  
 This floor plan has been prepared for the purpose of illustration only in accordance with the latest RICS code of measuring practice and is not to scale. All measurements and areas are approximate and whilst every effort has been made to ensure the accuracy of the plan contained here, no responsibility is taken for any error, omission or misstatement.

- End of terrace 3 bedroom house
- Popular residential location
- Ground floor extension
- Two reception rooms
- Garage and parking
- No onward chain
- Great potential to update/modernise

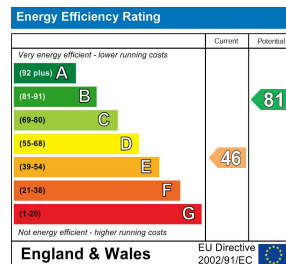

For Free Mortgage Quote and Best Mortgage Rates, call Ellisons Mortgage Advisor on 0208 543 1166



Although these particulars are believed to be correct, their accuracy is not guaranteed and they do not form part of any contract.

Celebrating 30 years of successful Sales and Lettings in Merton

