

# roundtree

real estate



## Endersleigh Court, Hendon NW4

£275,000



2



1



n

LEASEHOLD



BRITISH  
PROPERTY  
AWARDS

2022



GOLD WINNER

ESTATE AGENT  
IN NW4



BRITISH  
PROPERTY  
AWARDS

2022 - 2023



GOLD WINNER

LETTING AGENT  
IN NW4

*A fresh approach to your property journey...*

A two double bedroom ground floor maisonette located within close proximity to Hendon Central Tube station and Hendon Overground Station with direct access to the good size communal gardens. The property comprises of living room, separate kitchen, two double bedrooms, plus a family Shower room.



- Two double bedrooms
- Good size living room
- Separate Kitchen
- Long lease
- Ground Floor maisonette
- Communal Gardens
- Chain Free







**Outside there is a communal garden mainly laid to lawn, flowers and shrubs. The property offers easy access to the local shopping facilities as well as M1, A1 and A41 motorways. The property is offered with a long lease. Chain Free.**

# FLOOR PLAN

## EPC

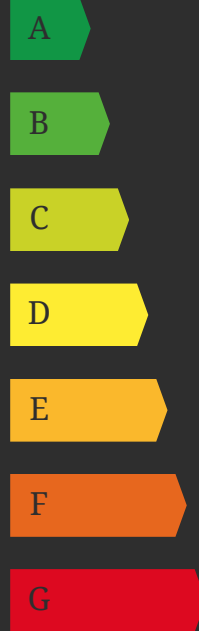

GROUND FLOOR  
612 sq.ft. (56.8 sq.m.) approx.

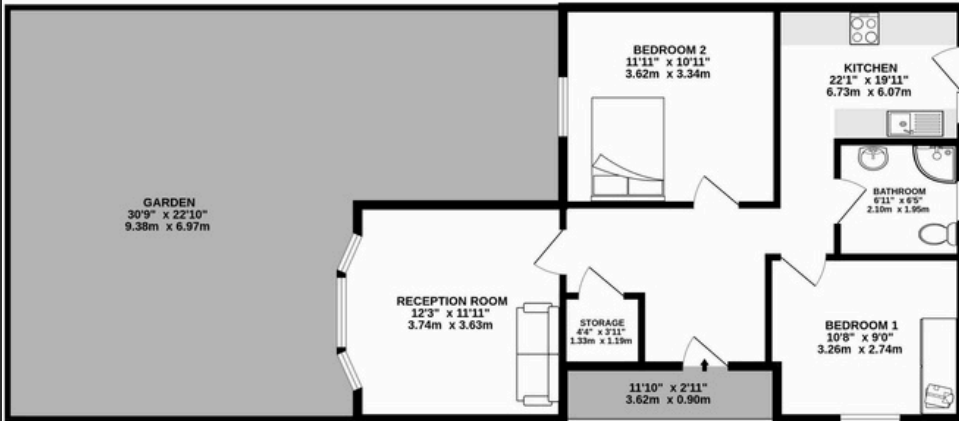

TOTAL FLOOR AREA : 612 sq.ft. (56.8 sq.m.) approx.

Whilst every attempt has been made to ensure the accuracy of the floorplan contained herein, measurements of doors, windows, rooms and any other items are approximate and no responsibility is taken for any error, omission or mis-statement. This plan is for illustrative purposes only and should be used as such by any prospective purchaser. The services, systems and appliances shown have not been tested and no guarantee as to their operability or efficiency can be given.  
Made with Metropix ©2022

1 Sentinel Square, Brent Street  
Hendon, NW4 2EL

020 8203 21111

mail@theroundtree.com

theroundtree.com

## Selling your home?

If you are considering selling your home please contact us today for your no obligation free market appraisal.

Our dedicated and friendly team will assist you.

**Get in touch today!**



General: While we endeavor to make our sales particulars fair, accurate and reliable, they are only a general guide to the property and, accordingly, if there is any point which is of particular importance to you, please contact the office and we will be pleased to check the position for you, especially if you are contemplating travelling some distance to view the property. Measurements: These approximate room sizes are only intended as general guidance. You must verify the dimensions carefully before ordering carpets or any built-in furniture. Services: Please note we have not tested the services or any of the equipment or appliances in this property, accordingly we strongly advise prospective buyers to commission their own survey or service reports before finalizing their offer to purchase. THESE PARTICULARS ARE ISSUED IN GOOD FAITH BUT DO NOT CONSTITUTE REPRESENTATIONS OF FACT OR FORM PART OF ANY OFFER OR CONTRACT. THE MATTERS REFERRED TO IN THESE PARTICULARS SHOULD BE INDEPENDENTLY VERIFIED BY PROSPECTIVE BUYERS OR TENANTS. NEITHER ROUNDTREE NOR ANY OF ITS EMPLOYEES OR AGENTS HAS ANY AUTHORITY TO MAKE OR GIVE ANY REPRESENTATION OR WARRANTY WHATSOEVER IN RELATION TO THIS PROPERTY.

*A fresh approach to your property journey...*