



The Avenue, London, W4 1HA

Guide Price £899,950

**WHITMAN & CO.**

SALES · LETTINGS · COMMERCIAL



- Grade II listed period conversion
- Garage
- Two beds/two baths
- Bedford Park Conservation Area
- Private wrap around garden
- No chain

Tenure - Leasehold with share in the freehold  
 Lease Length - 999 years  
 Ground Rent - peppercorn  
 Service Charge - £2900 pa  
 Local Authority - Ealing  
 Council Tax - Band E

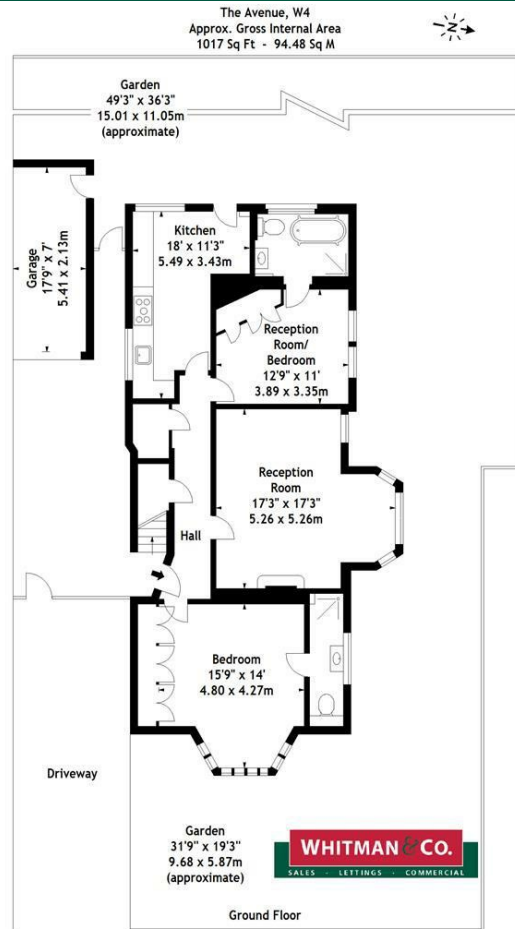

Measured in accordance with RICS guidelines. Every attempt is made to ensure accuracy, however all measurements are approximate. This floor plan is for illustrative purposes only and is not to scale. © Datagraphy Ltd 2017. Photographs \*Floorplans\* Virtual Tours. Tel: 0843 643 4401 www.datagraphiv.com

## THE PROPERTY

An immaculate 1017sqft two bedroom, two bathroom garden flat set within this magnificent detached Grade II listed property in the Bedford Park Conservation Area with the added benefit of a garage and close to all amenities. The accommodation comprises a master bedroom with ensuite wet room, a second double bedroom with ensuite bathroom, 17' reception room, fully integrated kitchen/breakfast room, host of original features, extensive built-in storage, private landscaped garden and garage. Ideally located in the Bedford Park Conservation Area offering close proximity to Turnham Green tube station and the extensive shops, bars and restaurants on Chiswick High Road. No chain.

## SITUATION

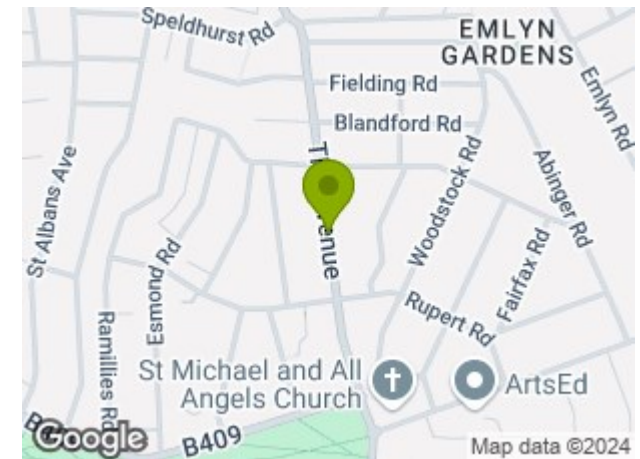

5-7 Turnham Green Terrace, Chiswick, London, W4 1RG

Tel 020 8747 8300

E-mail [sales@whitmanandco.com](mailto:sales@whitmanandco.com)

Website [www.whitmanandco.com](http://www.whitmanandco.com)



MISREPRESENTATION ACT 1967

Whitman & Co. for themselves and for the vendors give notice that these particulars do not constitute any part of, an offer of contract. All statements contained in these particulars are made without responsibility on the part of Whitman & Co. or the vendor. None of the statements contained in these particulars is to be relied upon as statements or representations of facts. Any intending purchaser must satisfy himself by inspection or otherwise as to the correctness of each of the statements contained in these particulars. The vendor does not make or give, and neither Whitman & Co. or any person in their employment has any authority to make or give, any representation or warranty whatever in relation to the property.