



Denman Drive North, Hampstead Garden Suburb, NW11

Long Leasehold

£950,000



800 finchley road, hampstead garden suburb, london, nw11 7tj

telephone 020 8458 5000 facsimile 020 8209 2068

email sales@litchfields.com web litchfields.com

offices also in highgate

A pretty, character semi-detached cottage placed in arguably the Suburb's most attractive country style road. This charming home has a lounge, dining room and kitchen on the ground floor, and 3 bedrooms and a bathroom on the upper floor. The property features a lovely large and sunny rear garden which backs onto Little Wood. This wonderful home is quintessentially what a Hampstead Garden Suburb cottage is all about and therefore makes viewing of this fine home highly recommended.

3 bedrooms | Lounge | Dining room | Kitchen | Bathroom | Downstairs WC | 110' rear garden backing onto Little Wood | Garden shed | EPC=TBA





Denman Drive

Approximate Gross Internal Area = 887 sq ft / 82.4 sq m

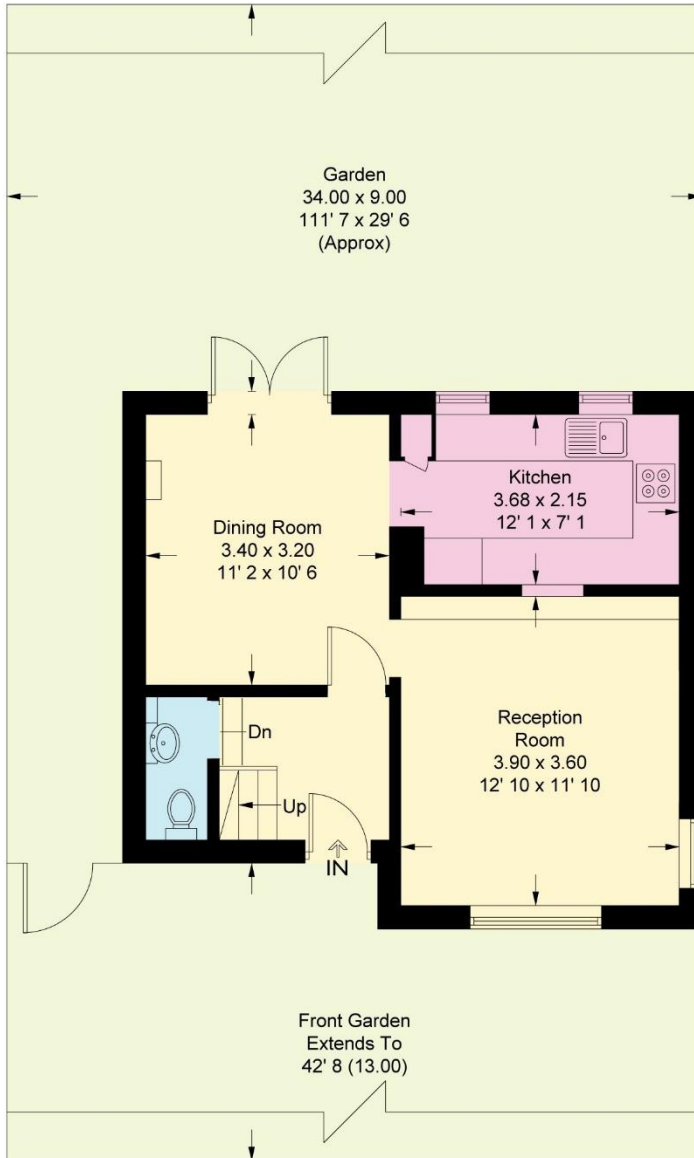

Ground Floor
446 sq ft / 41.4 sq m

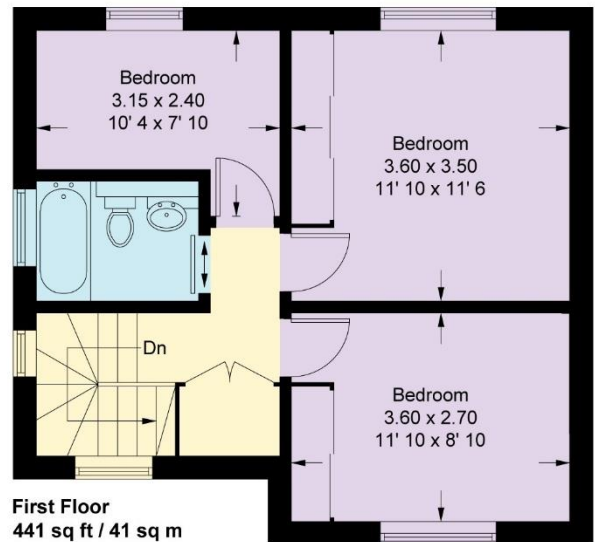

First Floor
441 sq ft / 41 sq m

This plan is not to scale and must be used as layout guidance only. All measurements and areas are approximate and should not be relied upon to provide accurate information. This plan must not be relied upon when making property valuations, design considerations or any other such relevant decisions. We accept no responsibility or liability (whether in contract, tort or otherwise) in relation to any loss whatsoever arising from or in connection with any use of this plan or the adequacy, accuracy or completeness of it or any information within it.



Whilst every effort is made to ensure these details are accurate, all measurements given are approximate and for guidance only. We are unable to comment on the structure of the building or services and any investigations should be carried out by a qualified surveyor. We strongly advise you to ensure that all legal aspects are fully investigated by your solicitor prior to a purchase. We have not applied tests to any appliances or equipment and therefore cannot verify these are in good working order. We understand from the vendor that the fixtures and fittings listed are to be included in the sale price but these may be subject to negotiation.