

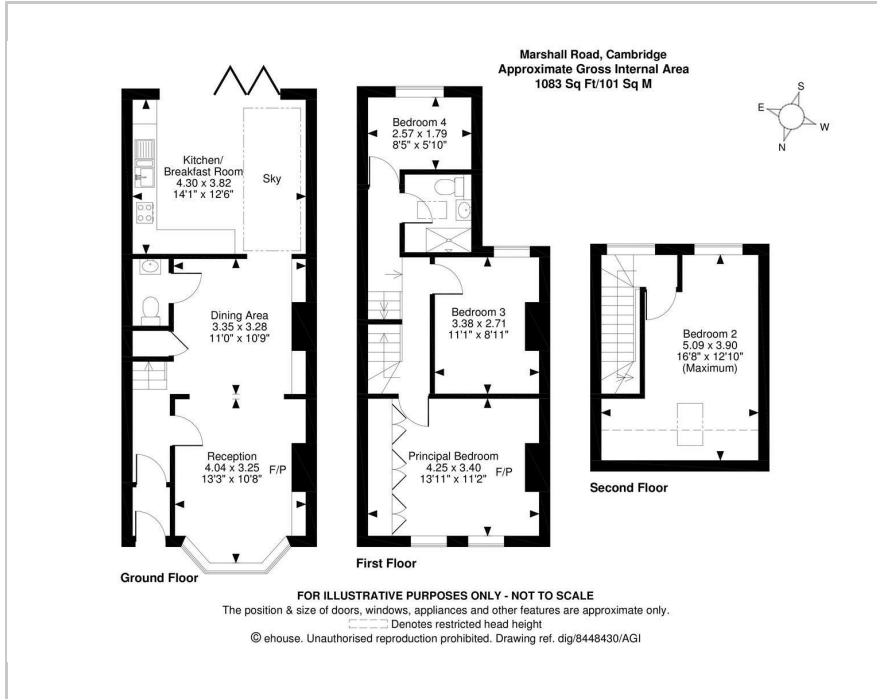

42 Marshall Road, Cambridge, CB1 7TY
£2,500 Per month



Floor Plan



Accommodation

- Courtyard Garden
- Residents Parking
- Gas Central Heating
- Ground floor WC

Beautifully presented and upgraded mid-terrace Victorian house located in a desirable residential location just off Hills Road. Well placed for access to the City Centre, Rail station, and Addenbrookes Hospital and within easy reach of the M11. Residents' parking scheme in place.

On the ground floor, you will find an elegant hallway leading to the stairs and a large reception room and dining area. There is a useful ground floor WC and plenty of built-in shelving. This leads through to the spacious and light kitchen including a hob, oven, dishwasher and fridge/freezer. There are bi-fold doors opening out to a pretty courtyard garden that has gated rear pedestrian access and a small shed.

Upstairs, to the first floor are three bedrooms, one of which has ample built-in wardrobes, and a modern shower room. On the second floor is a further double bedroom.

EPC Rating: E. Council Tax Band: D.

///slices.reap.broken

Viewing

Please contact our Gray & Toynbee (Cambridge) Office on 01223 439 888 if you wish to arrange a viewing appointment for this property or require further information.

Energy Efficiency Graph

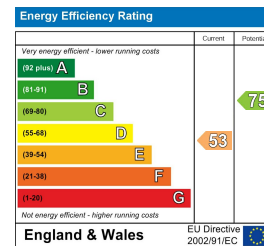

Area Map

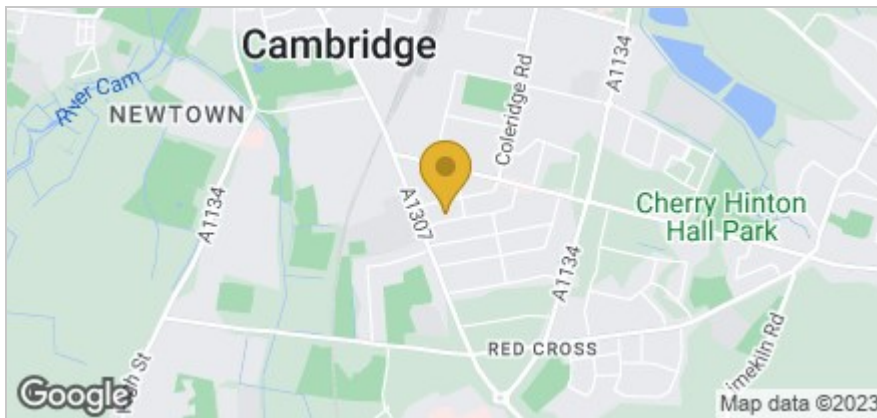

These particulars, whilst believed to be accurate are set out as a general outline only for guidance and do not constitute any part of an offer or contract. Intending purchasers should not rely on them as statements of representation of fact, but must satisfy themselves by inspection or otherwise as to their accuracy. No person in this firm's employment has the authority to make or give any representation or warranty in respect of the property.