

Chalice Way

Glastonbury, BA6 8EX

COOPER
AND
TANNER



£300,000 Freehold

2 1 1 EPC C

Description

Located within walking distance of the High Street, with fantastic Tor views, this detached bungalow offers scope for improvement throughout, off road parking, and no onward chain. The property is situated within a generous corner plot and the accommodation is comprised of a sitting room, kitchen, two double bedrooms, bathroom, and an airing cupboard housing a recently installed gas boiler. Sliding doors lead from the sitting room to a patio, and an enclosed lawned garden, with mature shrubs and plant borders. In addition to uninterrupted views of Glastonbury Tor, the garden benefits from a pedestrian side gate, and access to the single garage via a courtesy door.

Chalice Way, Glastonbury, BA6

Approximate Area = 575 sq ft / 53.4 sq m

Garage = 146 sq ft / 13.6 sq m

Total = 721 sq ft / 67 sq m

For identification only - Not to scale

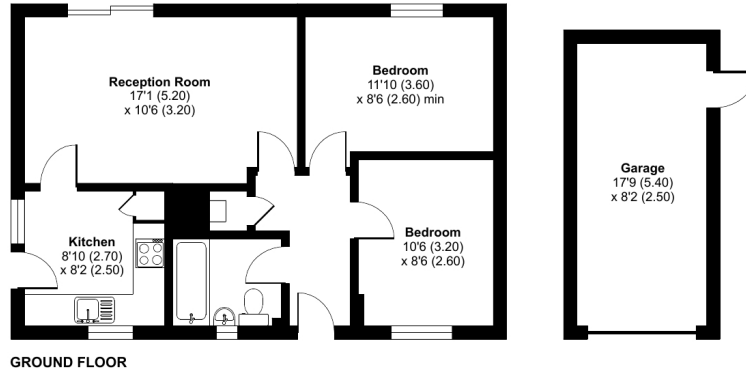

Floor plan produced in accordance with RICS Property Measurement Standards incorporating International Property Measurement Standards (IPMS2 Residential). © ritchecom 2024. Produced for Cooper and Tanner. REF: 1117629



Features

- NO ONWARD CHAIN
- Within walking distance of Glastonbury High Street and GLASTONBURY TOR
- Generous CORNER PLOT
- Plenty of SCOPE TO IMPROVE/MODERNISE
- Impressive VIEWS OF GLASTONBURY TOR
- Recently installed Gas boiler
- Two DOUBLE bedrooms
- Enclosed rear garden
- Off road parking and GARAGE
- Freehold - Council Tax Band C

Local Information

- Council Tax Band C
- Tenure Freehold
- EPC Rating C

GLASTONBURY OFFICE

Telephone 01458 831077

41, High Street, Glastonbury, Somerset BA6 9DS

glastonbury@cooperandtanner.co.uk

**COOPER
AND
TANNER**

Important Notice: These particulars are set out as a general outline only for the guidance of intended purchasers and do not constitute, nor constitute part of, an offer or contract. All descriptions, dimensions, reference to condition and necessary permissions for use and occupation, warranties and other details are given without responsibility and any intending purchasers should not rely on the matters as statements or representations of fact but must satisfy themselves by inspection or otherwise as to the correctness of each of them.

