



Minors & Brady

83 Oulton Street, Oulton

Offers Over £170,000

83 Oulton Street

Oulton, Lowestoft

Renovated and modernised to a high standard with a classy feeling throughout, Minors and Brady are thrilled to present to the market a three bedroom end-terrace home situated in the desirable suburb of Oulton. It is the ideal first-time home, being situated within close proximity to fantastic local amenities and incredible sandy beaches a short drive away. Don't miss the chance to acquire this wonderful residence!

LOCATION

Oulton is a wonderful area of Suffolk close to the popular seaside town of Lowestoft. Oulton Broad is one of the finest stretches of inland water in the UK and forms the southern gateway to the Broads National Park. A popular place to come for water sports such as; sailing, canoeing, rowing & boating as well as pampering & self-indulgence sessions in restaurants, cafes, pubs, wine bars and health & beauty salons. This fantastic suburb offers fantastic schooling and public transport plus a range of local high street shops and supermarkets. Oulton is well connected with 2 train stations offering direct services to Norwich and Ipswich with fast connecting services to London.

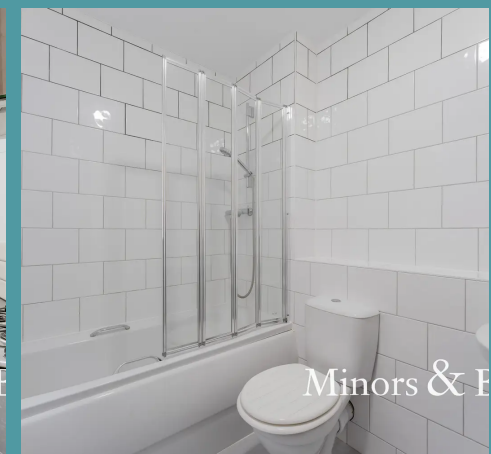



83 Oulton Street

Oulton, Lowestoft

Step inside where you are instantly greeted by a welcoming open-plan lounge/diner, ensuring effortless interaction when hosting occasions and everyday family living. This is where you can showcase your most comfortable furniture and dining set-up, encouraging gatherings with loved ones. The kitchen is fitted with units and appliances to be able to cook your favourite meals, offering plenty of storage space and areas for your laundry essentials. Located on the ground floor is a modern bathroom, comprising of a three piece suite, accommodating all family members and guests.

Ascend to the first floor, where you will find three bedrooms, designed to offer you relaxation and privacy. The third bedroom has the versatility to be a bedroom, dressing room or office if required.

The property is approached via gated access to an enclosed low maintenance garden which leads to the main entrance door. At the rear, you will find a garden with shared access featuring a tiled patio area ideal for outdoor furniture, a laid to lawn area and a large storage unit.



GROUND FLOOR

1ST FLOOR

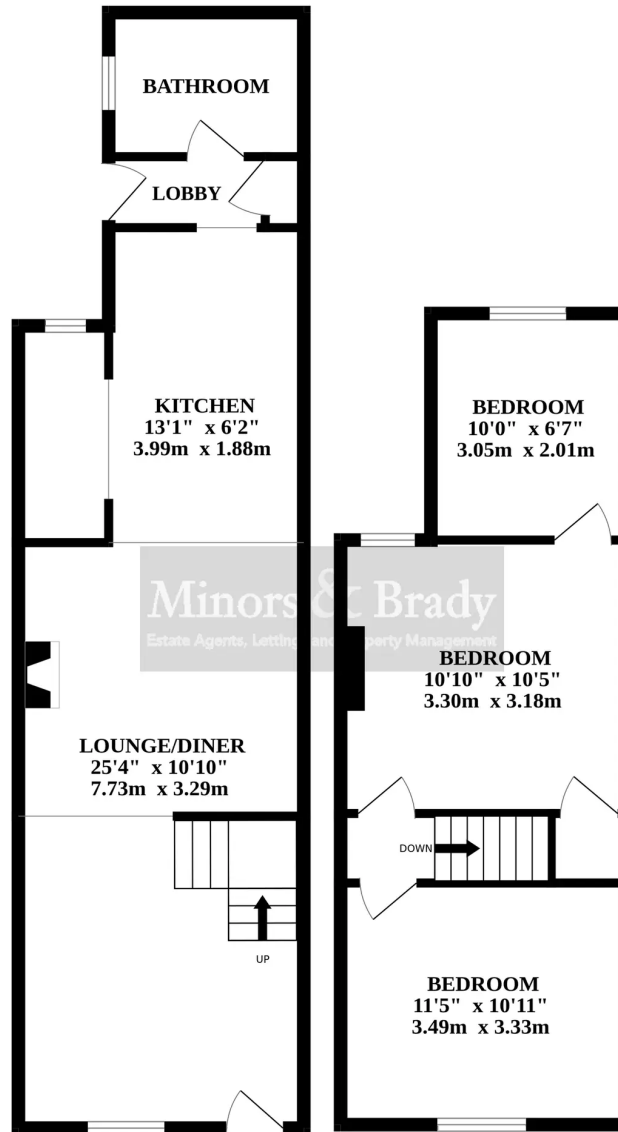

OULTON STREET, LOWESTOFT



Whilst every attempt has been made to ensure the accuracy of the floorplan contained here, measurements of doors, windows, rooms and any other items are approximate and no responsibility is taken for any error, omission or mis-statement. This plan is for illustrative purposes only and should be used as such by any prospective purchaser. The services, systems and appliances shown have not been tested and no guarantee as to their operability or efficiency can be given.
Made with Metropix ©2024