



High Street, SE20 | O.I.R.O £275,000

02087029777

sydenham@pedderproperty.com

pedder
We live local

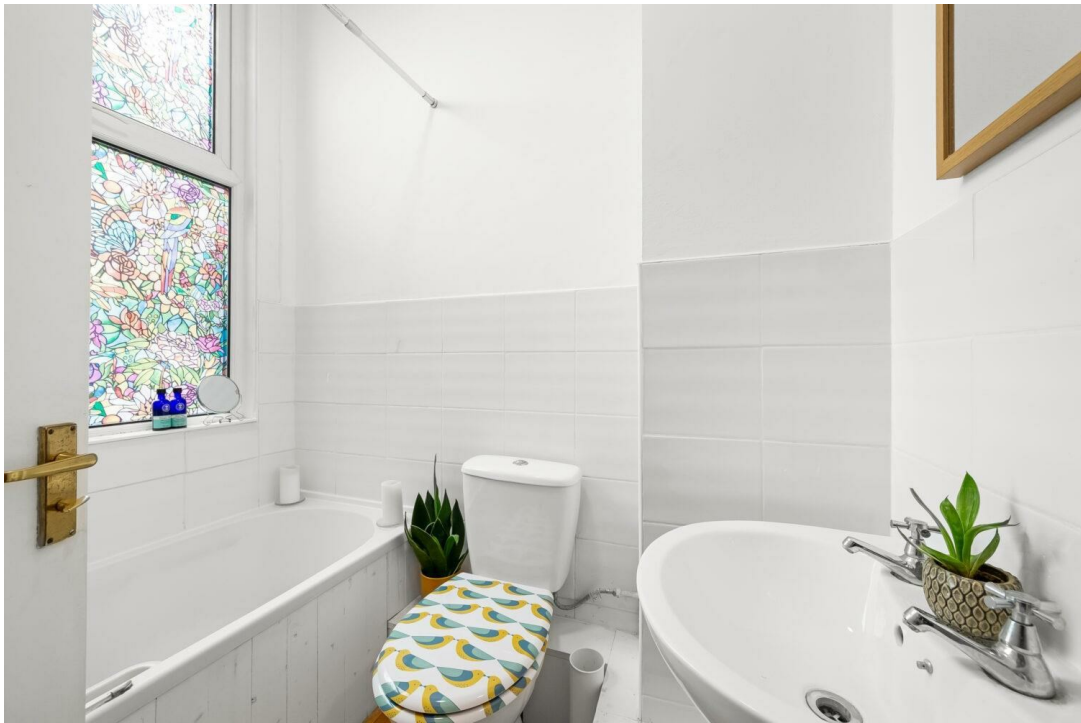

In General

- Characterful and charming
- Light filled accomodation
- Reception of 16'8 x 14'1ft
- Fitted kitchen
- Split level
- Double bedroom
- Good storage
- Excellent transport links
- No onward chain
- The lease will be extended by at least 90 years

In Detail

A charming one bedroom apartment, centrally located in Penge, close to excellent transport links, Crystal Palace Park and lots of amenities along the high street.

Comprising a reception stretching the width of property, with three large sash windows and super high ceilings creating a voluminous open living space, filled with natural light. The kitchen is fitted, includes space for a full fridge / freezer and washing machine, and is located just off the living area which works well when entertaining or socialising. To the rear is the bathroom and double bedroom with fitted wardrobes.

This location provides easy access to both Penge East (London Victoria) and West (Overground) rail links as well as a wide selection of eateries, coffee shops and convenience stores. Moments away is Crystal Palace Park offering 200 acres of open space, numerous leisure activities and music events. There is also a Brown & Green cafe and a weekly Sunday Farmers Market.

EPC: D | Council Tax Band: B | Lease: 61 Years Remaining | SC: £0 | GR: £150.00 pa | BI: £350.00 pa



Floorplan

High Street, SE20

Approximate Gross Internal Area
51.9 sq m / 559 sq ft

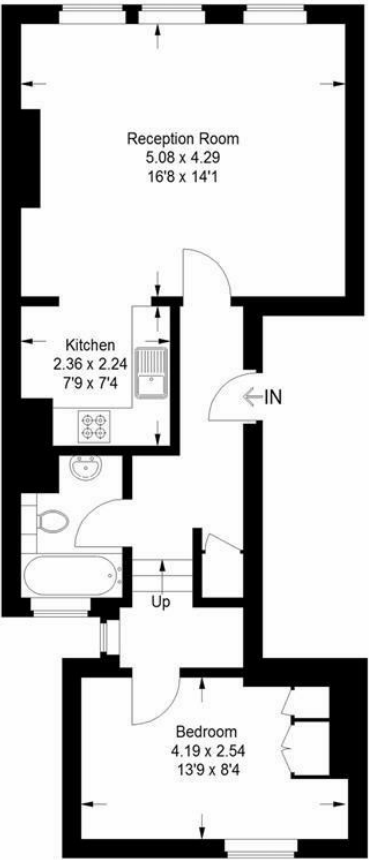

First Floor

Copyright www.pedderproperty.com © 2024
These plans are for representation purposes only
as defined by RICS - Code of Measuring Practice.
Not drawn to Scale. Windows and door openings
are approximate. Please check all dimensions,
shapes and compass bearings before making
any decisions reliant upon them.

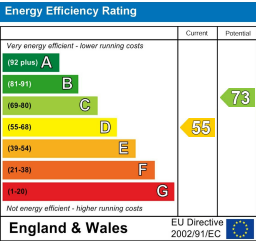

Pedder Property Ltd trading as Pedder for themselves and for the vendor/landlord of this property whose agents they are, give notice that (1) these particulars do not constitute any part of an offer or contract, (2) all statements contained within these particulars are made without responsibility on the part of Pedder or the vendor/landlord, (3) whilst made in good faith, none of the statements contained within these particulars are to be relied upon as a statement of representation or fact, (4) any intending purchaser/tenant must satisfy him/herself by inspection or otherwise as to the correctness of each of the statements contained within these particulars, (5) the vendor/landlord does not make or give either Pedder or any person in their employment any authority to make or give representation or warranty whatsoever in relation to this property.