



A FIRST FLOOR APARTMENT IN A MANSION STYLE DEVELOPMENT

Oak House, Ducks Hill Road Northwood, Middlesex HA6 2WQ

ROBSONS

APARTMENT IN A MANSION HOUSE STYLE DEVELOPMENT

Oak House, Ducks Hill Road, Northwood,
Middlesex HA6 2WQ

**FIRST FLOOR APARTMENT • GOOD SIZED
RECEPTION ROOM • FITTED KITCHEN • TWO
BEDROOMS • TWO BATHROOMS • FABULOUS
PRIVATE BALCONY • LANDSCAPED COMMUNAL
GARDENS • STAIR AND LIFT ACCESS TO ALL
FLOORS • ALLOCATED UNDERGROUND AND
OVERGROUD PARKING**

Description

A delightful two bedroom, two bathroom first floor apartment situated in a modern 'Mansion House' style development built in 2000.

The property benefits from a fabulous private balcony overlooking the attractive communal gardens.

There is an allocated underground parking space and one allocated over ground space. From the communal entrance hall are stairs and lift access to all floors.





Location

Northwood provides a range of shopping facilities including Waitrose supermarket, a variety of restaurants and other amenities with the Metropolitan Line station providing access to Baker Street and the City. There is a plethora of state and private schooling together with a wide choice of recreational facilities, which include golf courses and fitness centres. The M1, M40 and M25 motorways are also accessible.

Additional Information

Tenure: Share of Freehold

Lease: 999 year lease has been agreed

Service Charge: £3,600 per annum

Local Authority: London Borough of Hillingdon

Council Tax: Band G

Energy Efficiency Rating: Band D



APPROX. GROSS INTERNAL FLOOR AREA 1087 SQ FT 101 SQ METRES (EXCLUDES STORE)

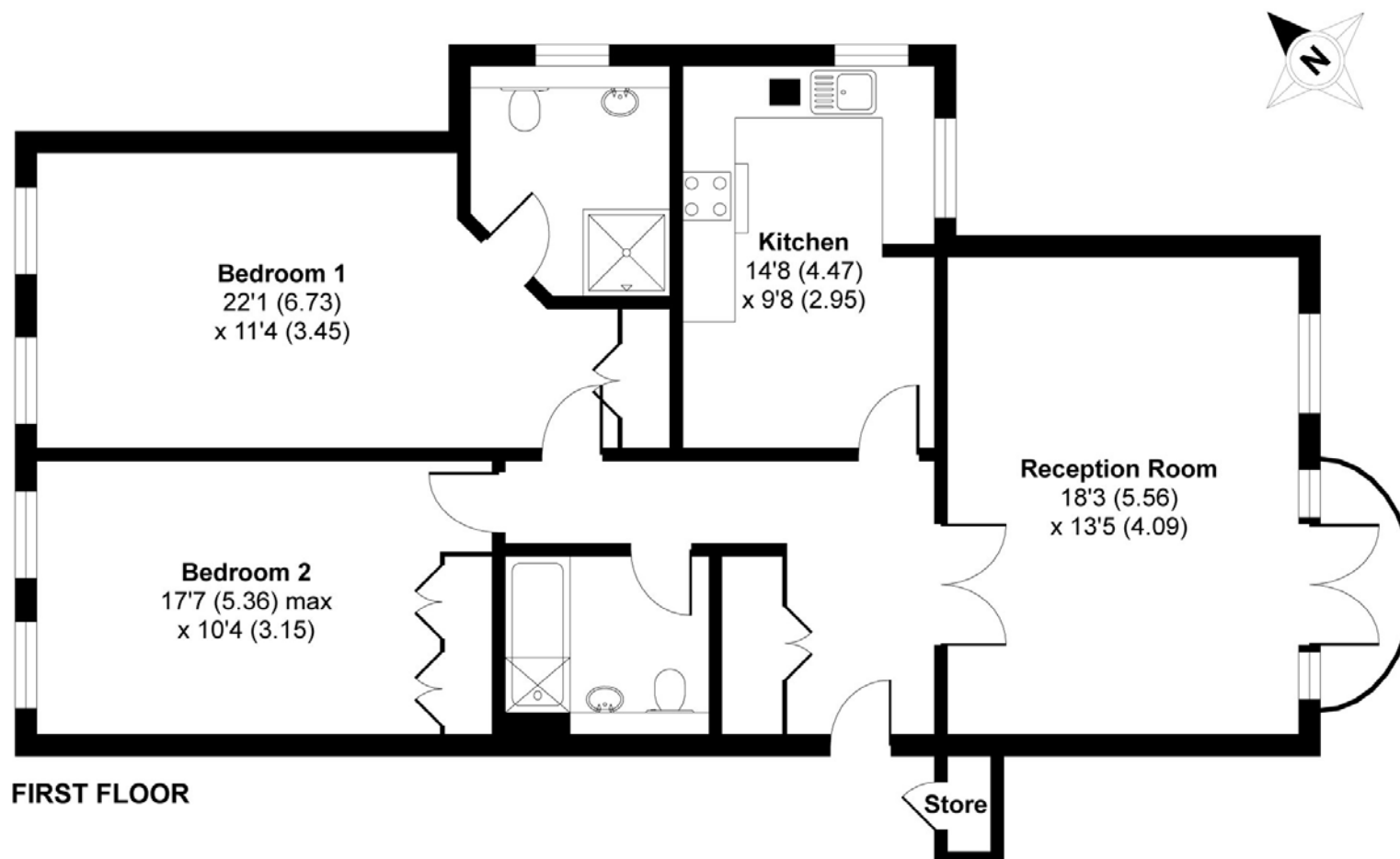

'For illustrative purposes only - not to scale. The position and size of doors, windows, appliances and other features are approximate only.'

Whilst every attempt has been made to ensure the accuracy of the floor plan contained here, measurements of doors, windows and rooms are approximate and no responsibility is taken for any error, omission or misstatement. These plans are for representation purposes only as defined by RICS Code of Measuring Practice and should be used as such by any prospective purchaser. Specifically no guarantee is given on the total square footage of the property if quoted on this plan. Any figure given is for initial guidance only and should not be relied on as a basis of valuation.

Copyright nichecom.co.uk 2017 Produced for Robsons REF : 224612

ROBSONS

Address: 7 Clive Parade, Northwood, Middlesex HA6 2QF

Tel: 01923 835355 northwood@robsonswb.com

www.robsonswb.com

www.the-londonoffice.co.uk
40 ST JAMES'S PLACE SW1

Important notice: Robsons, their clients and any joint agents give notice that 1: They are not authorised to make or give any representations or warranties in relation to the property either here or elsewhere, either on their own behalf or on behalf of their client or otherwise. They assume no responsibility for any statement that may be made in these particulars. These particulars do not form part of any offer or contract and must not be relied upon as statements or representations of fact. 2: Any areas, measurements or distances are approximate. Plot sizes and dimensions are taken from Promap and are approximate. The text, photographs and plans are for guidance only and are not necessarily comprehensive. It should not be assumed that the property has all necessary planning, building regulation or other consents and Robsons have not tested any services, equipment or facilities. Purchasers must satisfy themselves by inspection or otherwise.