



Clive Road, SE21  
£299,950

020 8702 8111  
[pedderproperty.com](http://pedderproperty.com)

**pedder**



# In general

- Set in a gated development is this purpose built apartment.
- Two double bedrooms
- Lounge/dining room
- Fitted kitchen
- Bathroom
- Well maintained communal areas and gardens
- Popular residential road close to transport links and amenities.

# In detail

Set in a gated development is this two bedroom purpose built apartment.

The property is located on the first floor and has accommodation comprising of two double bedrooms, lounge/dining room, fitted kitchen and bathroom.

Clevedon Court is a well maintained development set back from Clive Road providing well maintained communal areas and gardens and is ideally positioned to benefit from the local amenities of West Dulwich including numerous shops, cafes and restaurants.

Dulwich Village is close-by with its popular parks, Picture Gallery and Golf Course. Crystal Palace is also easily accessible where there are many cafes, bars, restaurants and shopping facilities.

Rail links to central London are from nearby West Dulwich (London Victoria/London Blackfriars), Gipsy Hill (London Bridge /London Victoria) and West Norwood (London Bridge/London Victoria).

The property also has the benefit of a long lease to 2173.

EPC: C | Council Tax Band: B | Lease: 153 years remaining | SC: £1,800 per annum | GR: Peppercorn | BI: £355 per annum.



# Floorplan

## Clevedon Court, SE21

Approximate Gross Internal Area  
54.2 sq m / 583 sq ft

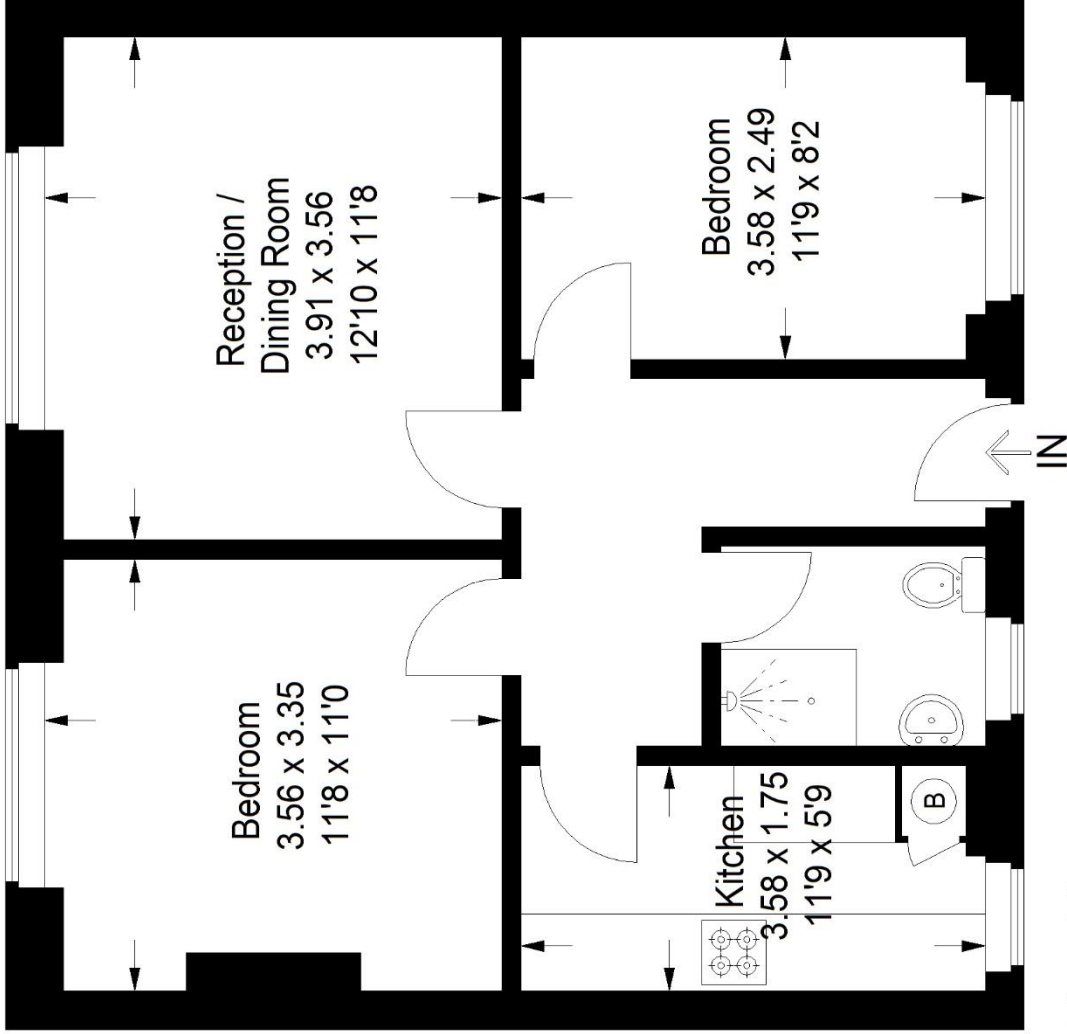

## First Floor

Copyright www.pedderproperty.com © 2022

These plans are for representation purposes only as defined by RICS - Code of Measuring Practice. Not drawn to Scale. Windows and door openings are approximate. Please check all dimensions, shapes and compass bearings before making any decisions reliant upon them.

Score	Energy rating	Current	Potential
92+	A		
81-91	B		81   B
69-80	C	76   C	
55-68	D		
39-54	E		
21-38	F		
1-20	G		

Pedder Property Ltd trading as Pedder for themselves and for the vendor/landlord of this property whose agents they are, give notice that (1) these particulars do not constitute any part of an offer or contract, (2) all statements contained within these particulars are made without responsibility on the part of Pedder or the vendor/landlord, (3) whilst made in good faith, none of the statements contained within these particulars are to be relied upon as a statement of representation or fact, (4) any intending purchaser/tenant must satisfy him/herself by inspection or otherwise as to the correctness of each of the statements contained within these particulars, (5) the vendor/landlord does not make or give either Pedder or any person in their employment any authority to make or give representation or warranty whatsoever in relation to this property.