



Queen Mary Road, SE19
£325,000

0208 702 9333
pedderproperty.com

pedder



In general

- Generously proportioned
- Private rear garden
- No onward chain
- Kitchen/diner
- New long lease
- Popular residential street

In detail

A generously proportioned one bedroom ground floor garden flat forming part of a popular residential street in Crystal Palace.

This property provides a blank canvas for a new owner to make their own, offering a kitchen / diner and a separate reception room with direct access to outside. There is a fully tiled modern bathroom plus a separate WC and a sizeable private rear garden with a sunny south-westerly aspect. Further benefits include a new long lease and no onward chain.

Queen Mary Road is a quiet community-orientated location where residents can communicate with each other via a WhatsApp group and enjoy an annual street party - rare for a London postcode. The area is primarily served by West Norwood rail links but bus routes at the end of the road also connect to Brixton, Gipsy Hill and Crystal Palace.

EPC: C | Council Tax Band: B | Lease: 150 years remaining | SC: As & When | GR: N/A | BI: TBC



Floorplan

Queen Mary Road, SE19

Approximate Gross Internal Area
55.0 sq m / 592 sq ft

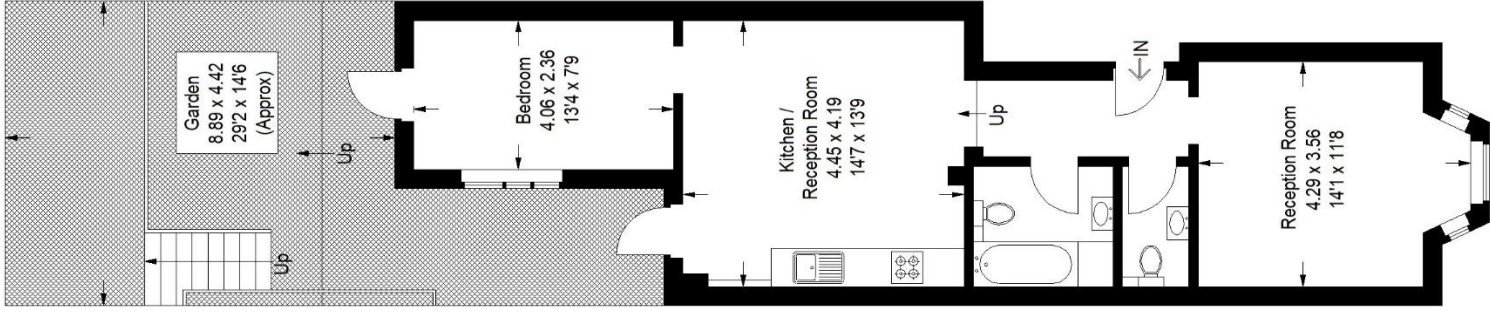

Ground Floor

Copyright www.pedderproperty.com © 2023
 These plans are for representation purposes only as defined by RICS - Code of Measuring Practice. Not drawn to Scale. Windows and door openings are approximate. Please check all dimensions, shapes and compass bearings before making any decisions reliant upon them.

Score	Energy rating	Current	Potential
92+	A		
81-91	B		
69-80	C	71 C	76 C
55-68	D		
39-54	E		
21-38	F		

Pedder Property Ltd trading as Pedder for themselves and for the vendor/landlord of this property whose agents they are, give notice that (1) these particulars do not constitute any part of an offer or contract, (2) all statements contained within these particulars are made without responsibility on the part of Pedder or the vendor/landlord, (3) whilst made in good faith, none of the statements contained within these particulars are to be relied upon as a statement of representation or fact. (4) any intending purchaser/tenant must satisfy him/herself by inspection or otherwise as to the correctness of each of the statements contained within these particulars. (5) the vendor/landlord